

# City of Philadelphia



(Bill No. 080256)

## AN ORDINANCE

To amend the Institutional Development District Master Plan of Community College of Philadelphia by allowing for the construction of an addition to an already existing building to be used for additional classroom and educational space at the College.

### *THE COUNCIL OF THE CITY OF PHILADELPHIA HEREBY ORDAINS:*

SECTION 1. Pursuant to Section 14-1107(c) of The Philadelphia Code, The Institutional Development District Master Plan of Community College of Philadelphia is hereby amended by allowing for the construction of a one-story, 5,219-square-foot addition to the College's already existing Bonnell Building on 17th Street between Spring Garden and Callowhill Streets, as set forth in attached Exhibit "B", to be used for additional classroom and educational space.

SECTION 2. This Ordinance shall take effect immediately.

Exhibit B



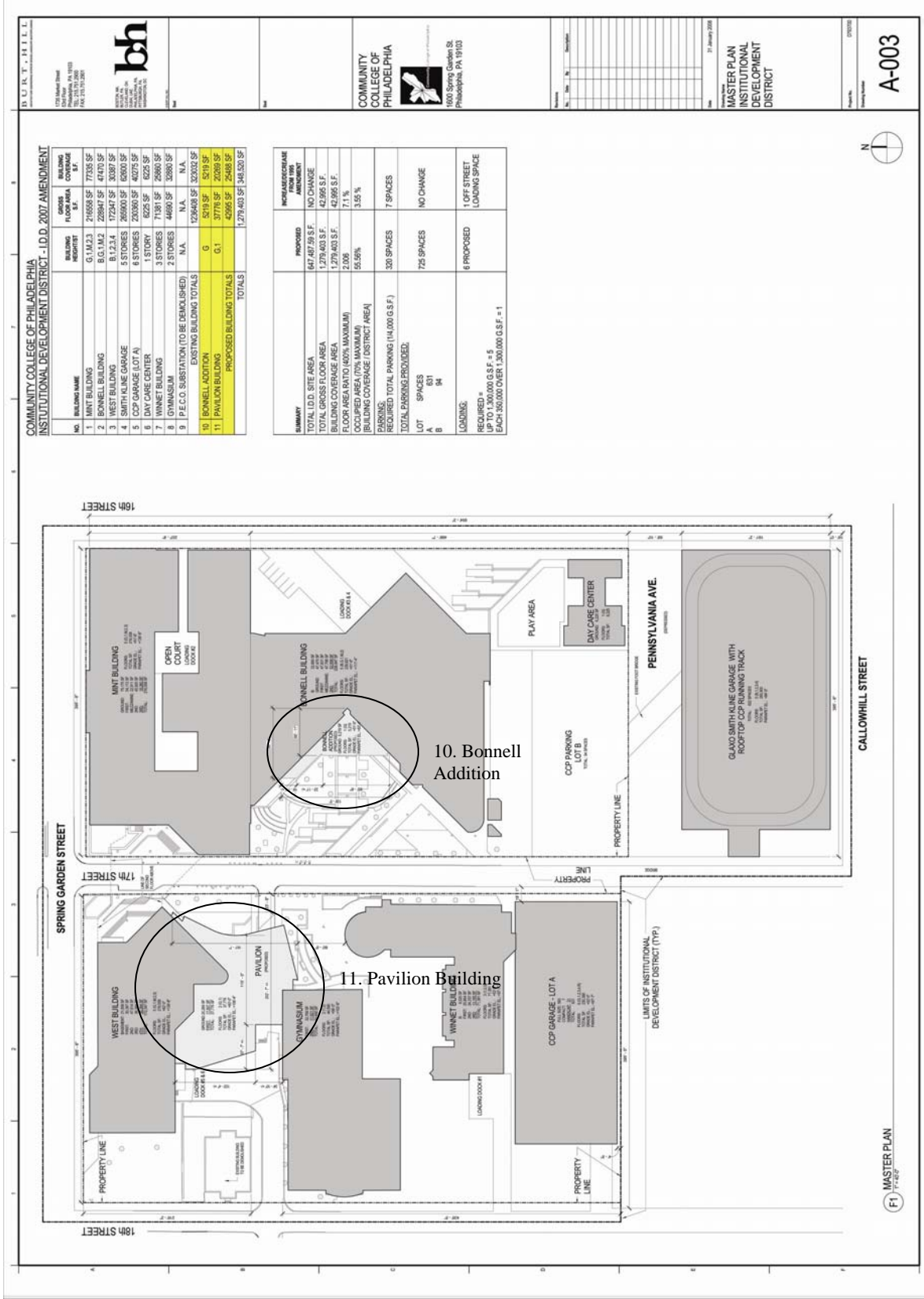

COMMUNITY COLLEGE OF PHILADELPHIA  
INSTITUTIONAL DEVELOPMENT DISTRICT - I.D.D. 2007 AMENDMENT

NO.	BUILDING NAME	EXISTING FLOOR AREA (S.F.)	PROPOSED FLOOR AREA (S.F.)	BUILDING COVERAGE (S.F.)
1	MINT BUILDING	61,142.3	246,658	77,035
2	BONNELL BUILDING	81,23.4	228,947	47,470
3	WEST BUILDING	81,23.4	172,947	30,937
4	SMITH KLINE GARAGE	265,900	265,900	62,000
5	CCP GARAGE LOT A	230,360	230,360	40,775
6	DAY CARE CENTER	6,225	6,225	6,225
7	WINNET BUILDING	71,381	71,381	25,980
8	GYMNASIUM	44,690	44,690	30,680
9	P.E.C.O. SUBSTATION (TO BE DEMOLISHED)	N/A	N/A	N/A
EXISTING BUILDING TOTALS				
10	BONNELL ADDITION	0	5,719	5,719
11	PAVILION BUILDING	0	42,956	42,956
PROPOSED BUILDING TOTALS				
TOTALS		1,279,403	1,443,200	143,200

SUMMARY	PROPOSED	INCREASE/DECREASE
TOTAL I.D.D. SITE AREA	647,487.59 S.F.	NO CHANGE
TOTAL GROSS FLOOR AREA	1,279,403 S.F.	42,956 S.F.
BUILDING COVERAGE AREA	1,279,403 S.F.	42,956 S.F.
FLOOR AREA RATIO (MAXIMUM)	2.006	71.1%
GROUNDING AREA (MAXIMUM)	15.56%	13.8%
REQUIRED TOTAL PARKING (14,000 G.S.F.)	300 SPACES	7 SPACES
TOTAL PARKING PROVIDED:		
LOT SPACES	725 SPACES	NO CHANGE
STREET	0	
B	84	
LOADINGS:	6 PROPOSED	1 OFF STREET LOADING SPACE
REQUIRED = UP TO 1,300,000 G.S.F. = 5 EACH 300,000 OVER 1,300,000 G.S.F. = 1		

31 January 2008

MASTER PLAN  
INSTITUTIONAL  
DEVELOPMENT  
DISTRICT

A-003

# City of Philadelphia

BILL NO. 080256 continued

Certified Copy

CERTIFICATION: This is a true and correct copy of the original Bill, Passed by the City Council on April 10, 2008. The Bill was Signed by the Mayor on April 28, 2008.



Patricia Rafferty  
Chief Clerk of the City Council