



City of Philadelphia

City Council
Chief Clerk's Office
402 City Hall
Philadelphia, PA 19107

BILL NO. 170675

Introduced June 22, 2017

Councilmember Jones

**Referred to the
Committee on Rules**

AN ORDINANCE

To amend the Philadelphia Zoning Maps by changing the zoning designations of certain areas of land located within an area bounded by Woodbine Avenue, Upland Way, 59th Street, Lancaster Avenue, and 62nd Street.

THE COUNCIL OF THE CITY OF PHILADELPHIA HEREBY ORDAINS:



SECTION 1. Pursuant to Section 14-106 of The Philadelphia Code, The Philadelphia Zoning Maps are hereby amended by changing the zoning designations of certain areas of land within an area bounded by Woodbine Avenue, Upland Way, 59th Street, Lancaster Avenue, and 62nd Street from the existing zoning designations indicated on Map "A" set forth below to the zoning designations indicated on Map "B" set forth below.

SECTION 2. This Ordinance shall become effective immediately.

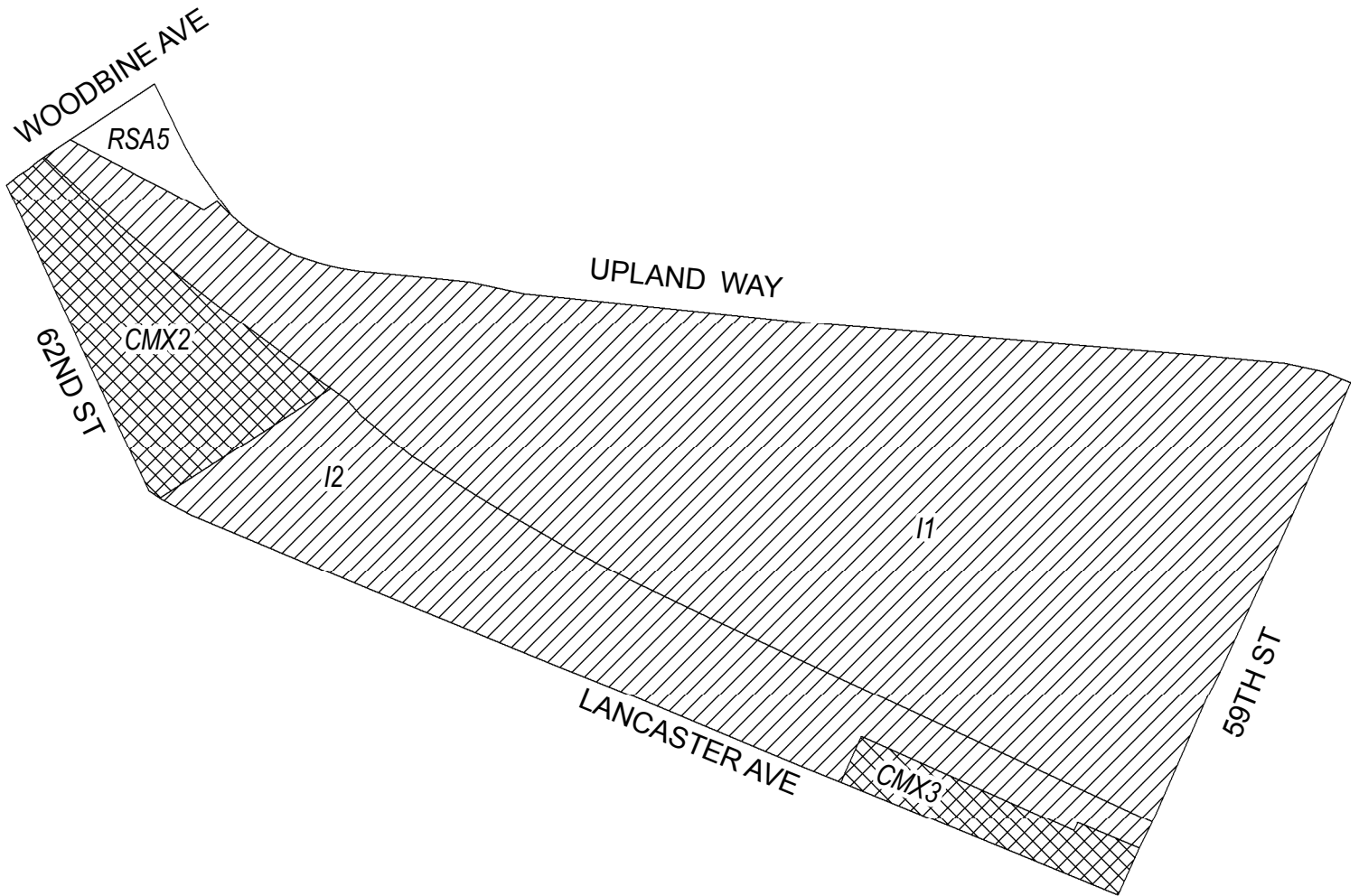
Map A Existing Zoning



Zoning Districts



-  CMX-2/CMX-3, Commercial Mixed-Use
-  I-1, Light Industrial; I-2, Medium Industrial
-  RSA-5, Residential Single-Family Attached

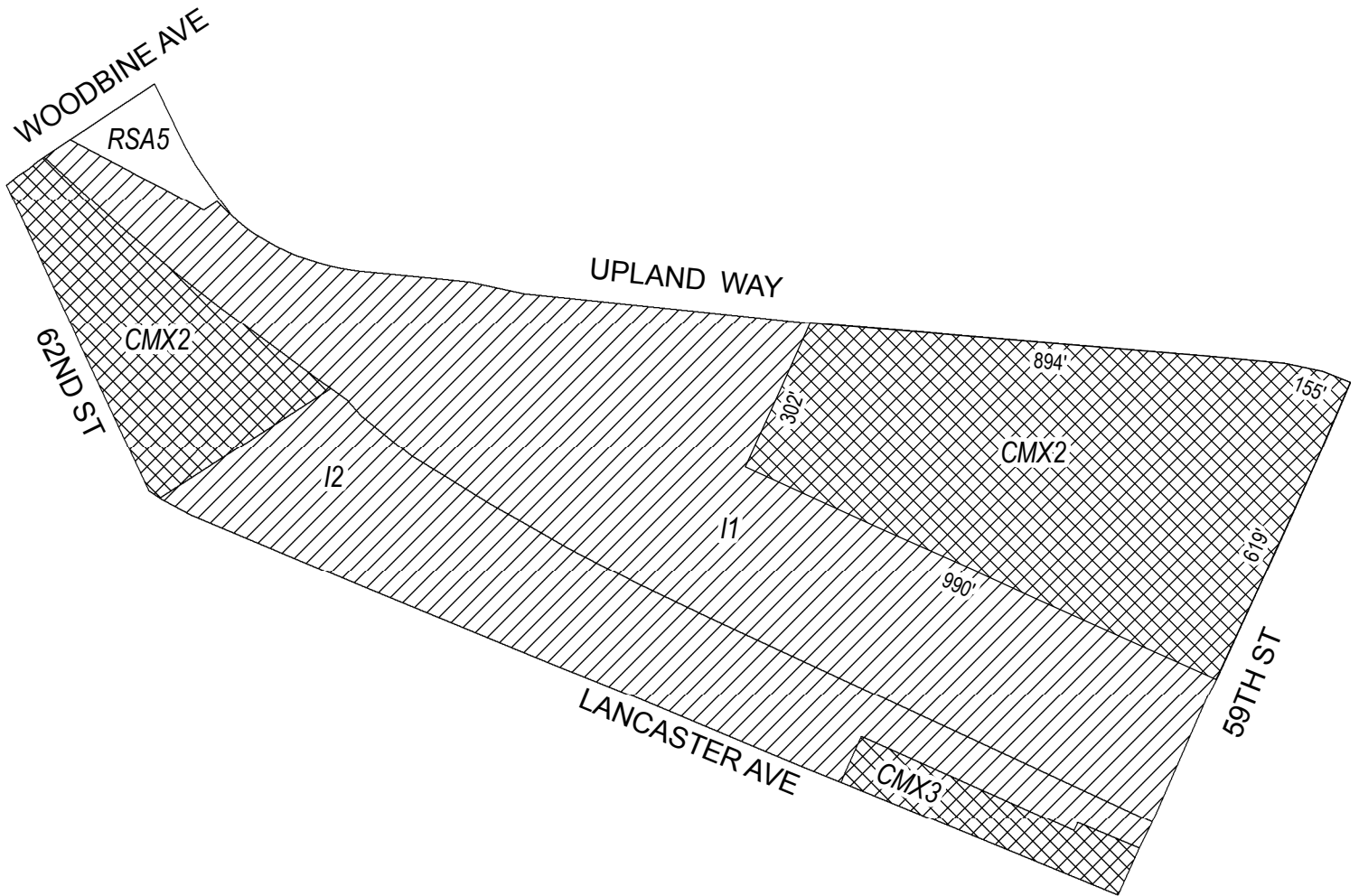

Map B Proposed Zoning



Zoning Districts

-  CMX-2/CMX-3, Commercial Mixed-Use
-  I-1, Light Industrial; I-2, Medium Industrial
-  RSA-5, Residential Single-Family Attached



City of Philadelphia

BILL NO. 170675 continued