

Amendment to Bill No. 260238

AN ORDINANCE

To amend the Philadelphia Zoning Maps by changing the zoning designations of certain areas of land located within an area bounded by Ludlow Street, South 41st Street, West Girard Avenue, and North 48th Street.

SECTION 1. Pursuant to Section 14-106 of the Philadelphia Code, the Philadelphia Zoning Maps are hereby amended by changing the zoning designations of certain areas of land within an area bounded by Ludlow Street, South 41st Street, West Girard Avenue, and North 48th Street under certain terms and conditions.

1. Replace the Exhibits to the Bill “Map A1 Existing Zoning;” “Map B1 Proposed Zoning;” “Map A2 Existing Zoning;” “Map B2 Proposed Zoning;” “Map A3 Existing Zoning;” “Map B3 Proposed Zoning;” “Map A4 Existing Zoning;” and “Map B4 Proposed Zoning” with the attached documents titled “Map A1 Existing Zoning;” “Map B1 Proposed Zoning;” “Map A2 Existing Zoning;” “Map B2 Proposed Zoning;” “Map A3 Existing Zoning;” “Map B3 Proposed Zoning;” “Map A4 Existing Zoning;” and “Map B4 Proposed Zoning”.

# Map A1 Existing Zoning

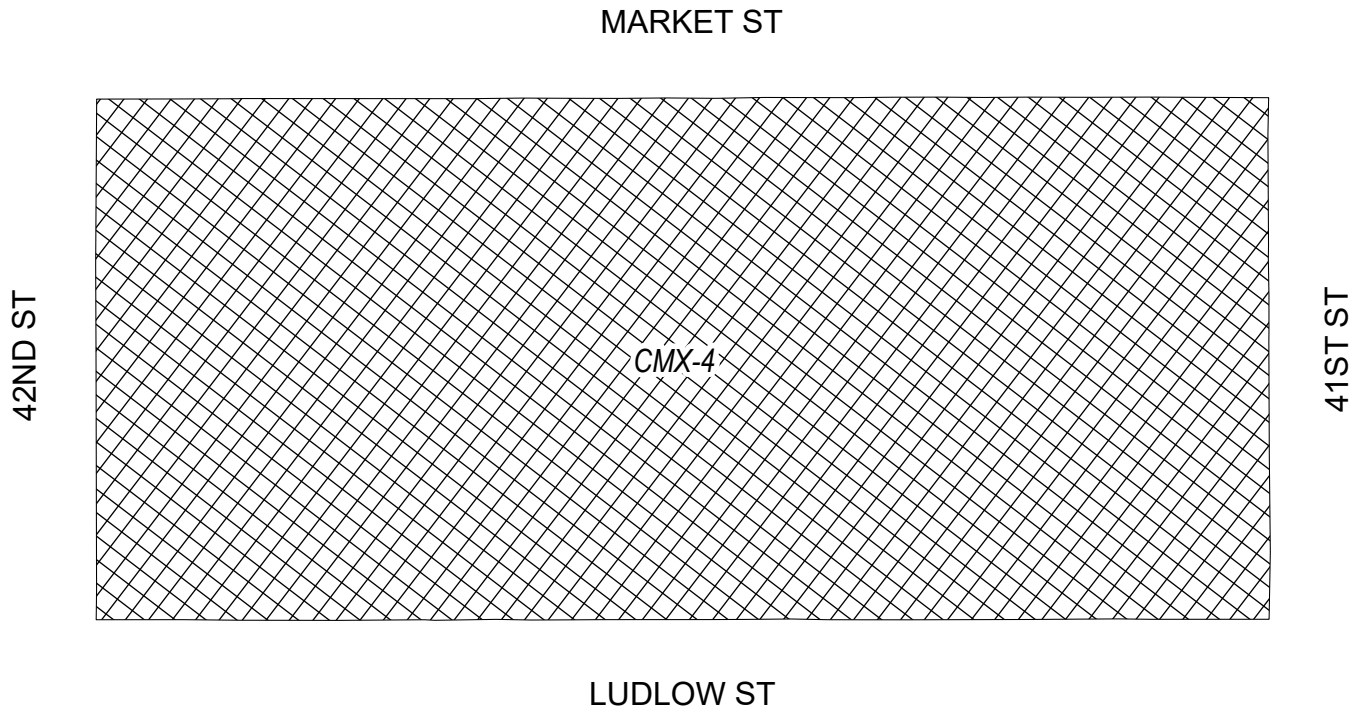

## Zoning Districts



 CMX-4, Commercial Mixed-Use

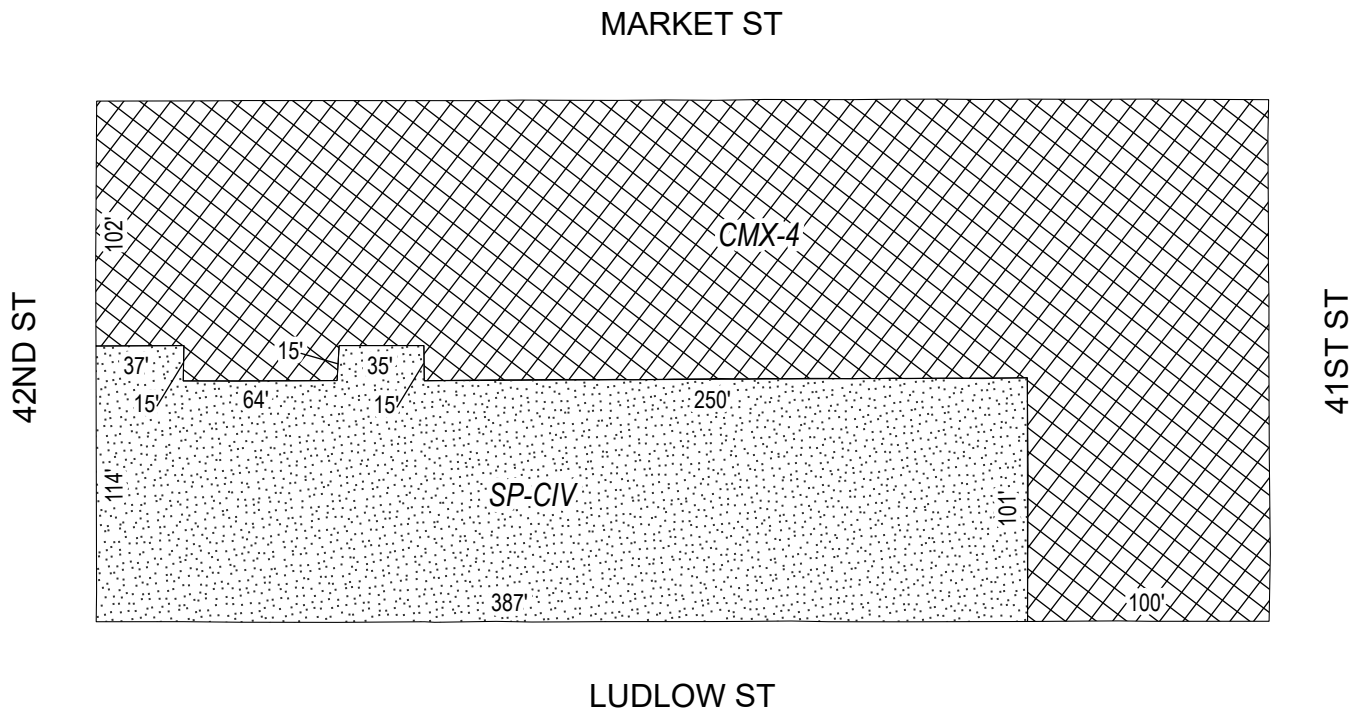

# Map B1 Proposed Zoning



## Zoning Districts

-  CMX-4, Commercial Mixed-Use
-  SP-CIV, Civic, Educational, and Medical



# Map A2 Existing Zoning

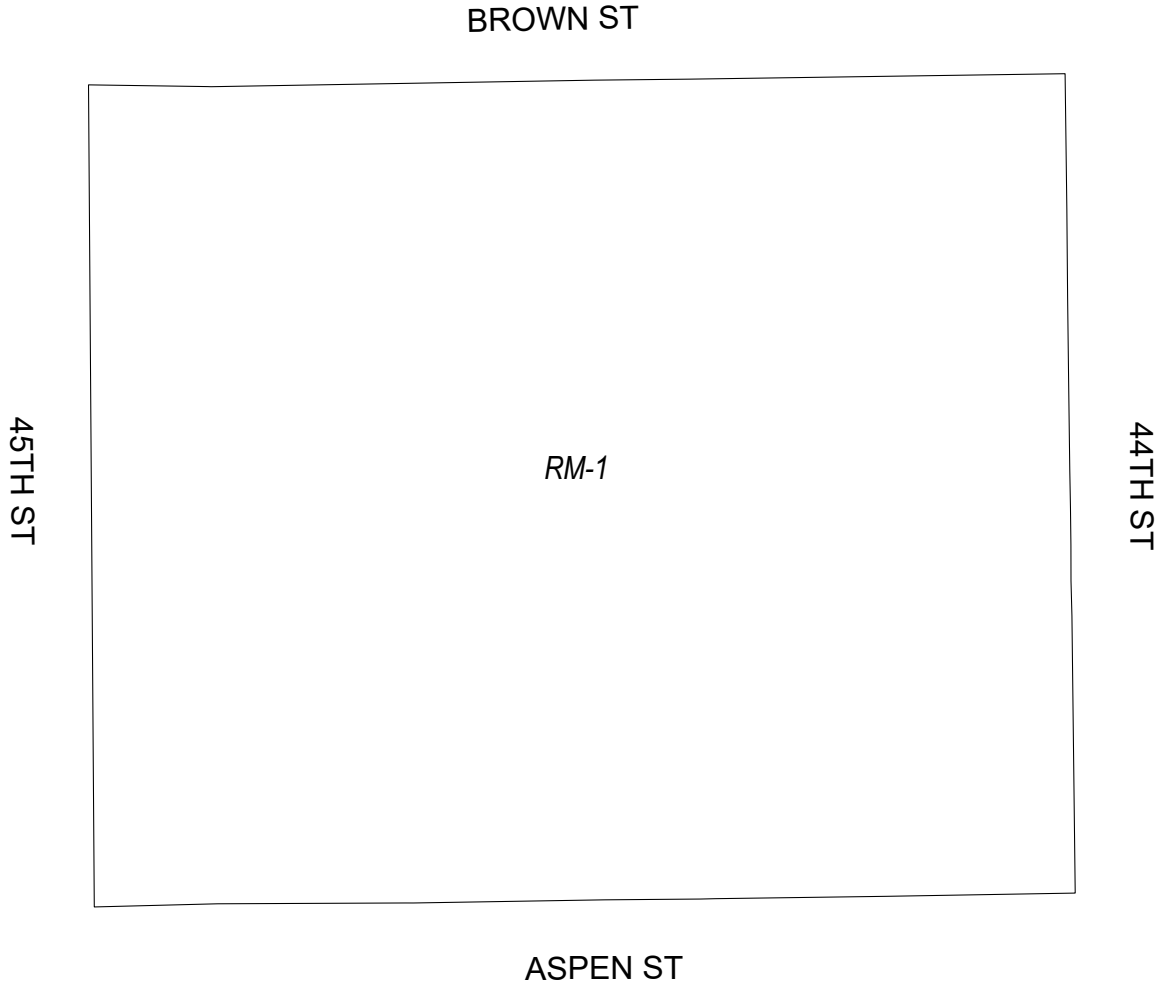

## Zoning Districts

 RM-1, Residential Multi-Family



# Map B2 Proposed Zoning

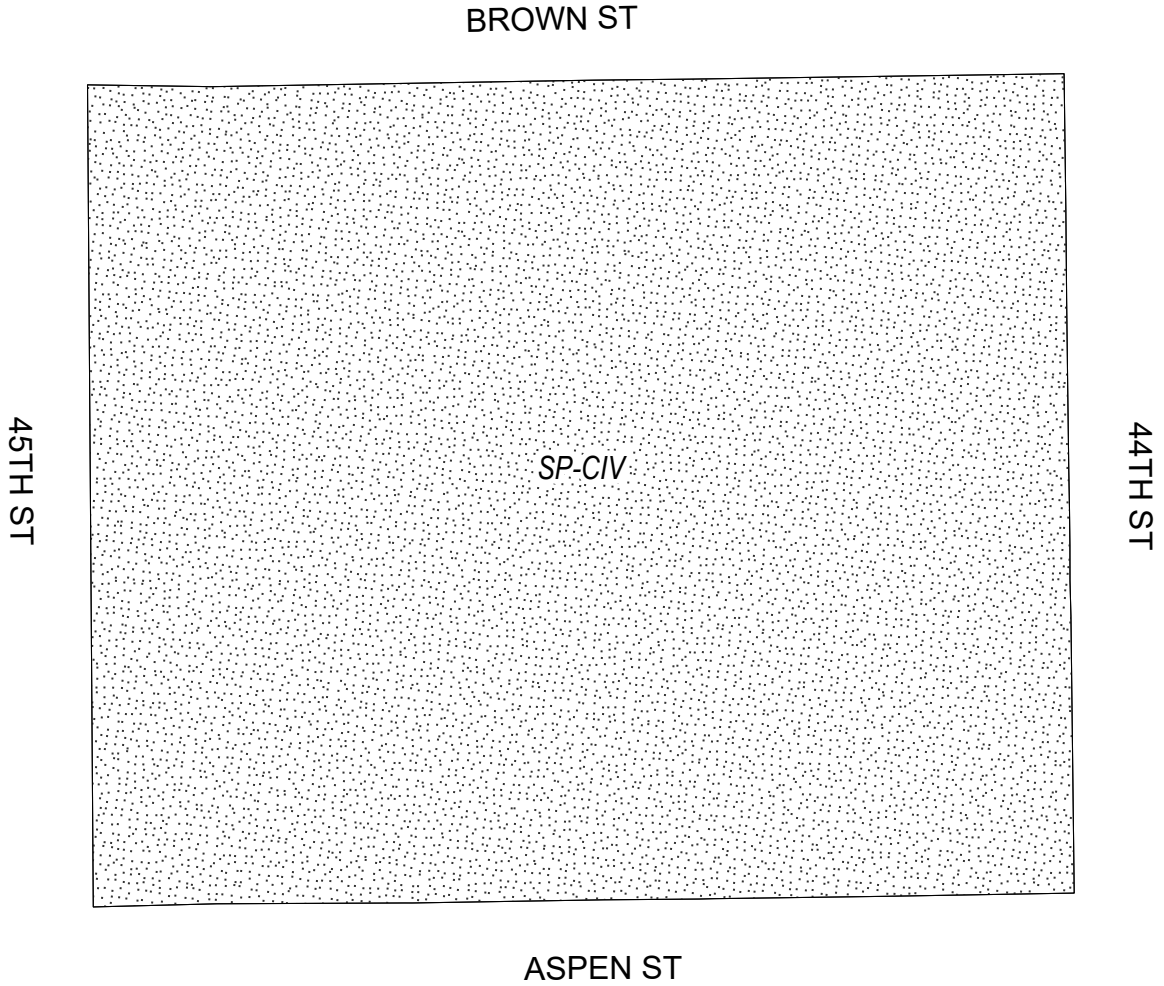

## Zoning Districts

 SP-CIV, Civic, Educational, and Medical



# Map A3 Existing Zoning

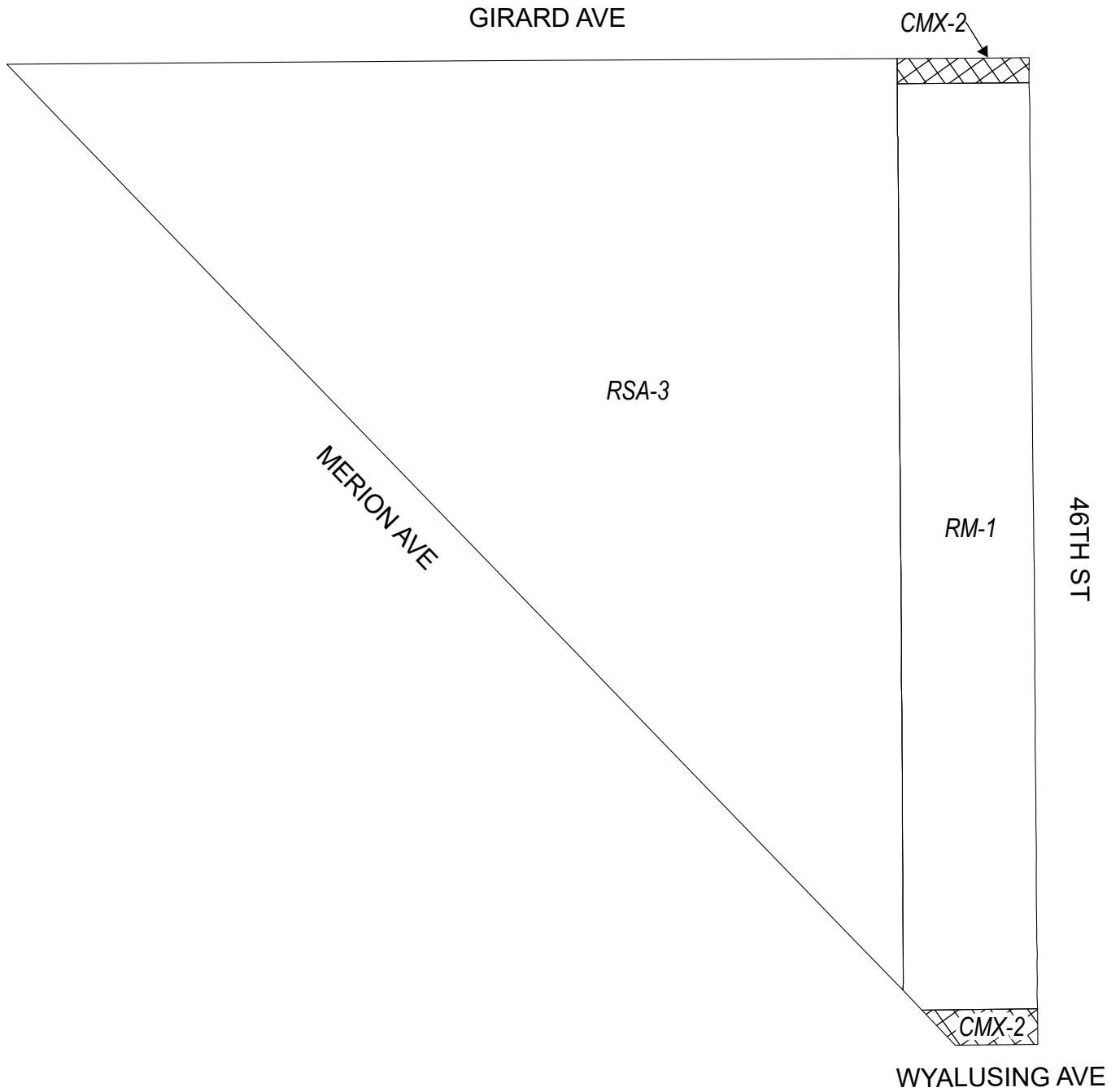

## Zoning Districts

☒ CMX-2, Commercial Mixed-Use



☐ RM-1, Residential Multi-Family; RSA-3, Residential Single-Family Attached

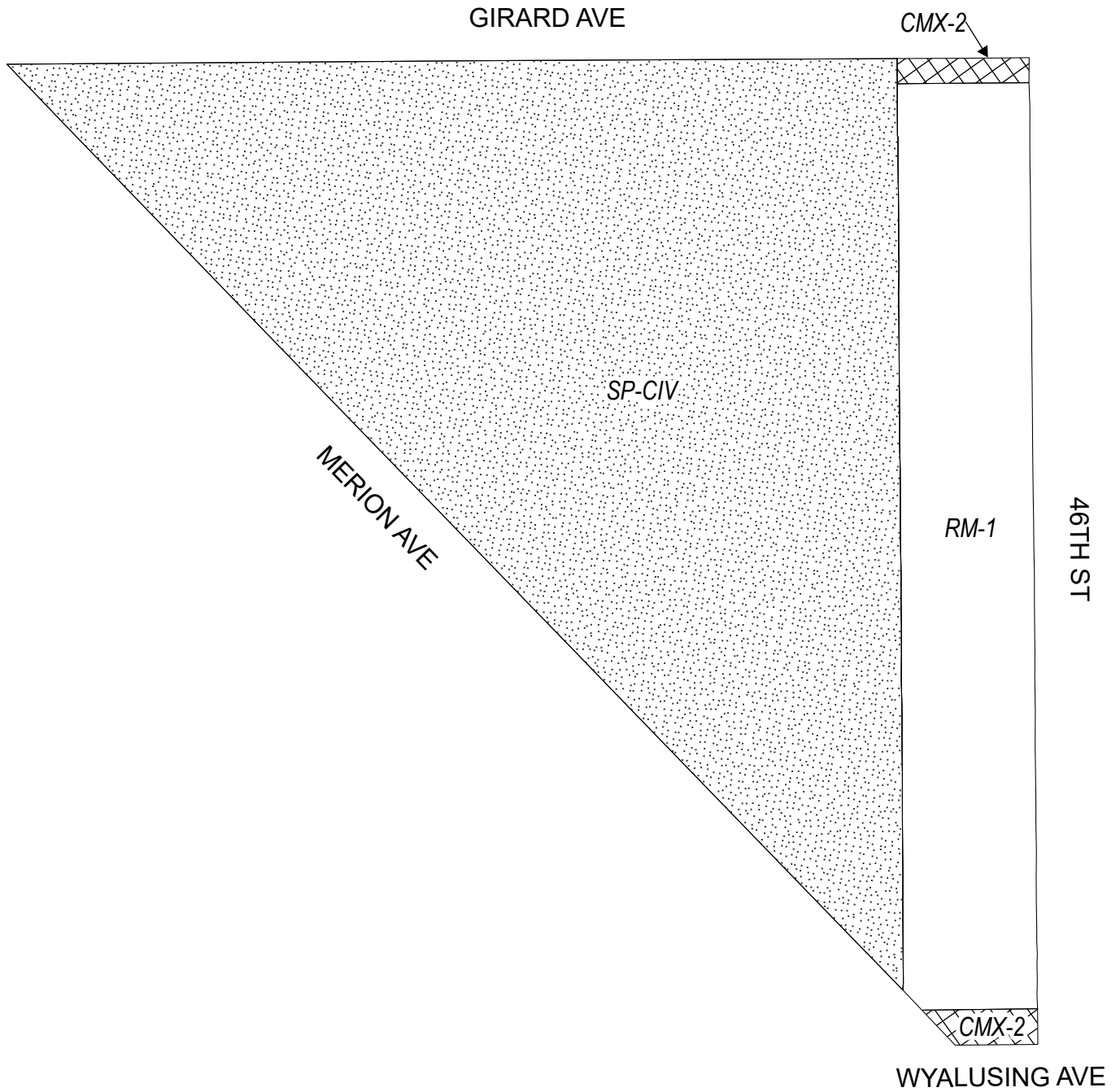

# Map B3 Proposed Zoning



## Zoning Districts

-  CMX-2, Commercial Mixed-Use
-  RM-1, Residential Multi-Family
-  SP-CIV, Civic, Educational, and Medical



# Map A4 Existing Zoning

BROWN ST

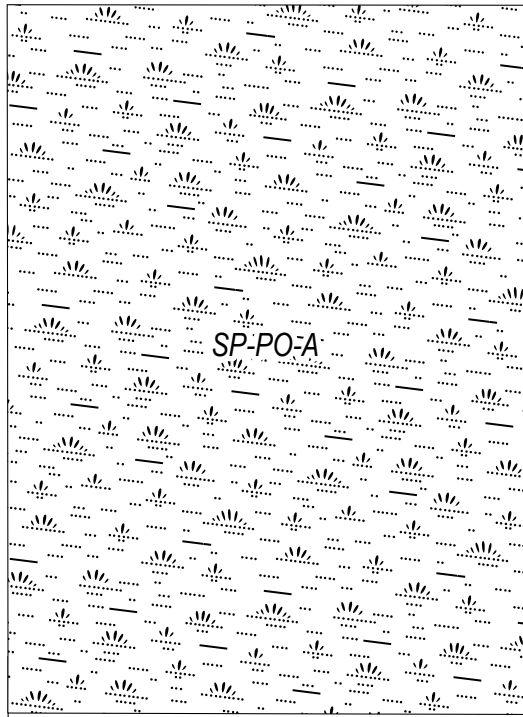

SP-PO-A

48TH ST

47TH ST

RSA-5

FAIRMOUNT AVE

## Zoning Districts

 RSA-5, Residential Single-Family Attached

 SP-PO-A, Parks and Open Space



# Map B4 Proposed Zoning

BROWN ST

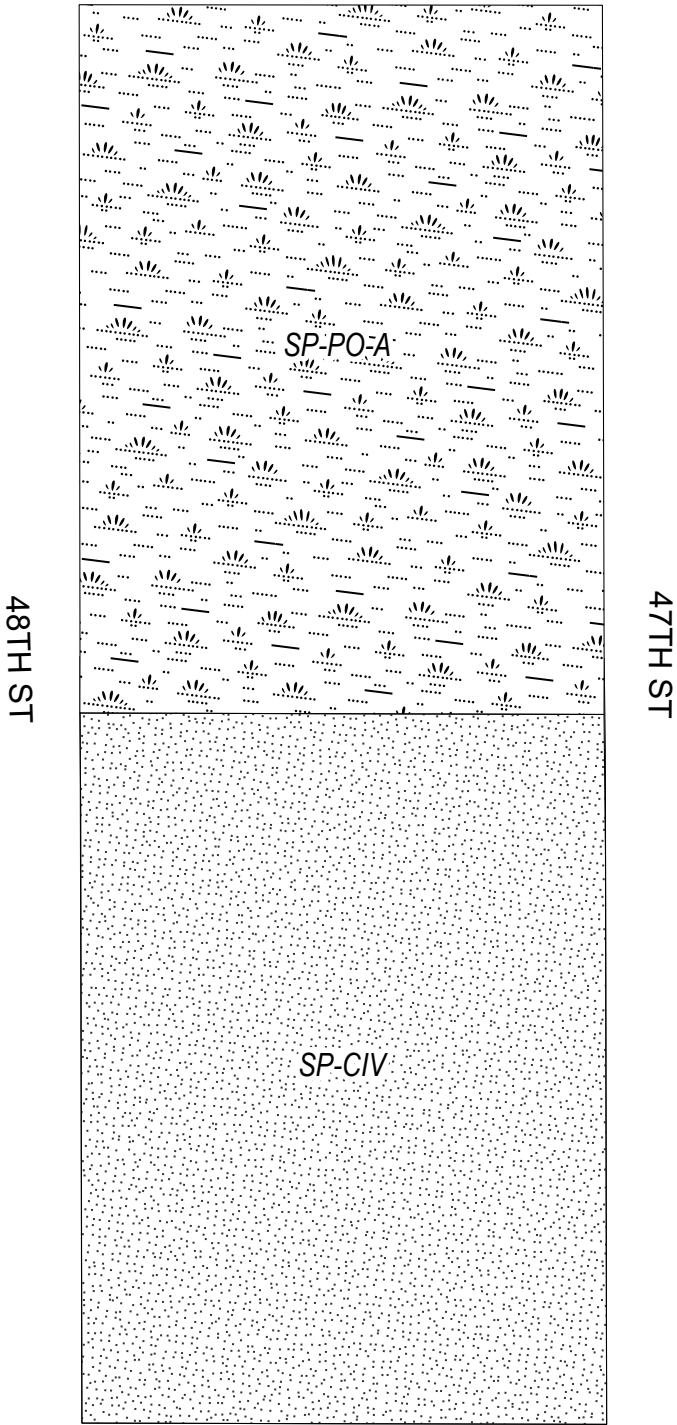



48TH ST

47TH ST

FAIRMOUNT AVE

## Zoning Districts

-  SP-CIV, Civic, Educational, and Medical
-  SP-PO-A, Parks and Open Space

