

# City of Philadelphia



(Bill No. 200161)

## AN ORDINANCE

To amend the Philadelphia Zoning Maps by changing the zoning designations of certain areas of land located within an area bounded by Main Street, Ridge Avenue, Wissahickon Creek, the Schuylkill River, and Osborn Street (extended).

*THE COUNCIL OF THE CITY OF PHILADELPHIA HEREBY ORDAINS:*



SECTION 1. Pursuant to Section 14-106 of The Philadelphia Code, the Philadelphia Zoning Maps are hereby amended by changing the zoning designations of certain areas of land within an area bounded by Main Street, Ridge Avenue, Wissahickon Creek, the Schuylkill River, and Osborn Street (extended), from the existing zoning designations indicated on “Map A,” set forth below, to the zoning designations indicated on “Map B,” set forth below.

SECTION 2. This Ordinance shall become effective immediately.

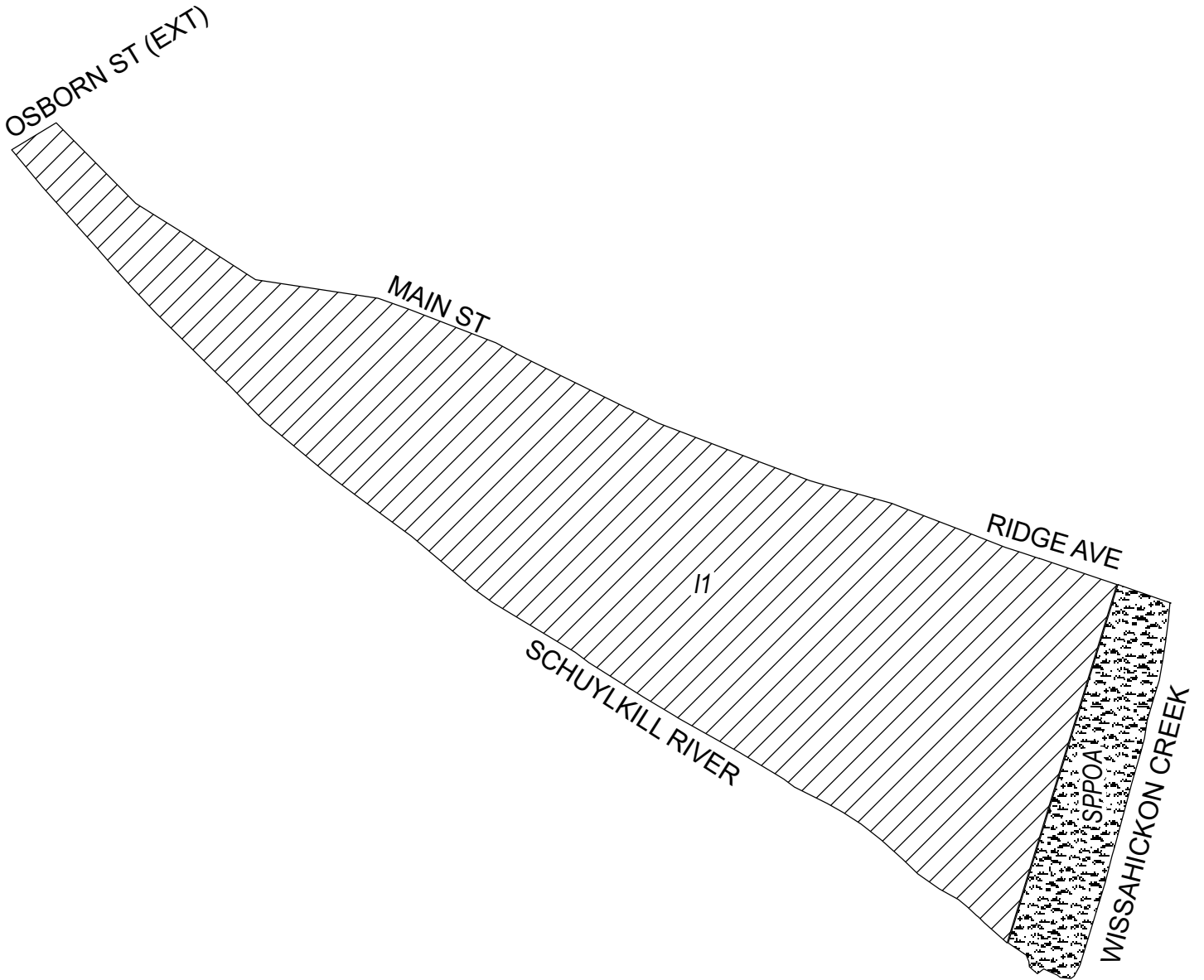
# Map A Existing Zoning

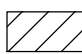

## Zoning Districts

-  I-1, Light Industrial
  -  SP-PO-A, Parks and Open Space
- City of Philadelphia



# Map B Proposed Zoning

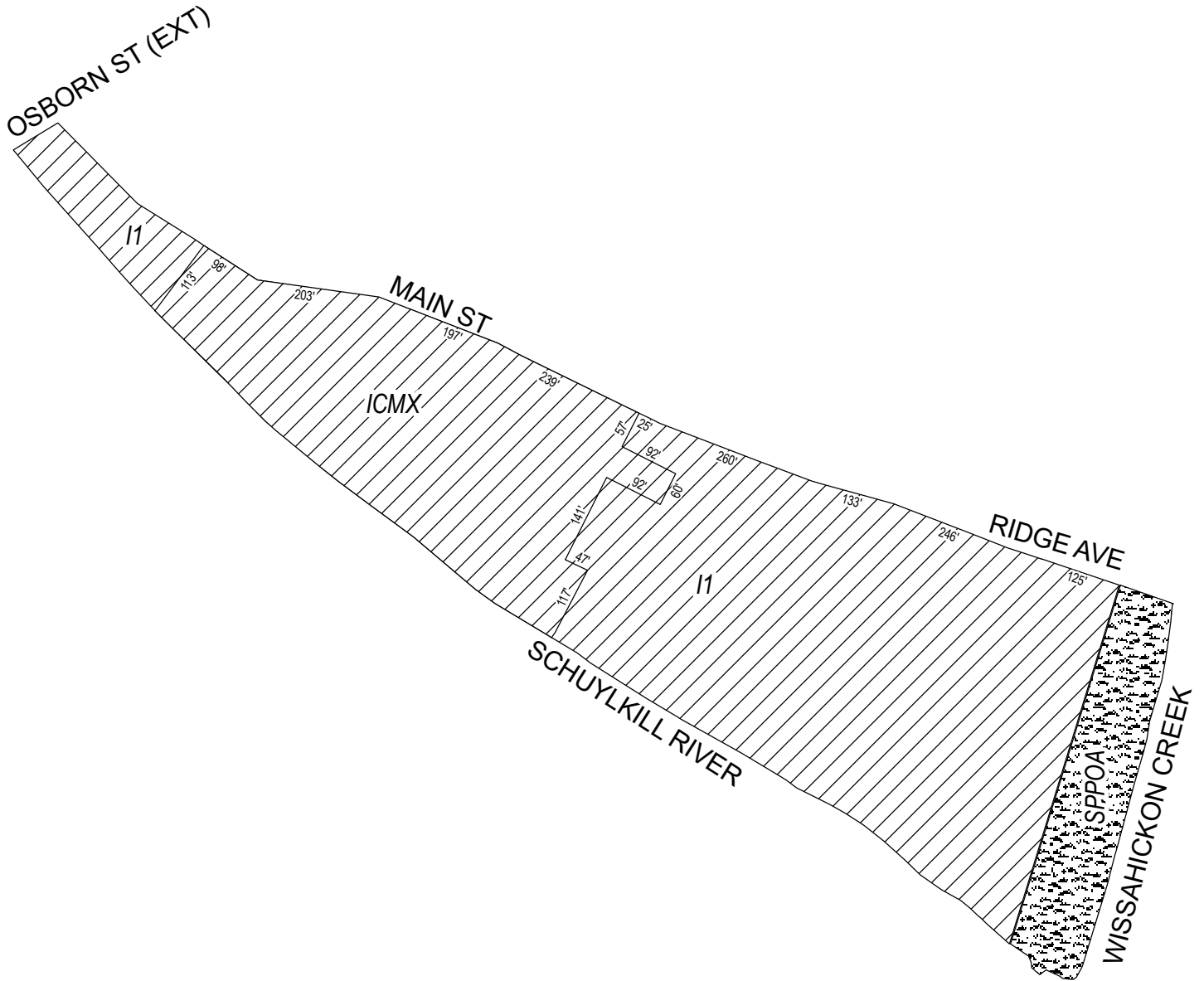

## Zoning Districts

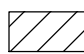
 I-1, Light Industrial; ICMX, Industrial Commercial Mixed-Use

 SP-PO-A, Parks and Open Space



# City of Philadelphia

*BILL NO. 200161 continued*

Certified Copy

CERTIFICATION: This is a true and correct copy of the original Bill, Passed by the City Council on October 1, 2020. The Bill was Signed by the Mayor on October 14, 2020.

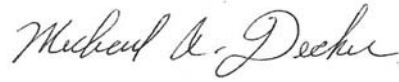

Michael A. Decker  
Chief Clerk of the City Council