

City of Philadelphia



(Bill No. 150489)

AN ORDINANCE

To amend the Philadelphia Zoning Maps by changing the zoning designations of certain areas of land located within an area bounded by Hagys Mill Road, Port Royal Avenue, Lare Street, Summit Avenue, Eva Street, Shawmont Avenue, Umbria Street, Railroad Right of Way, and the County Line.

THE COUNCIL OF THE CITY OF PHILADELPHIA HEREBY ORDAINS:

SECTION 1. Pursuant to Section 14-106 of The Philadelphia Code, the Philadelphia Zoning Maps are hereby amended by changing the zoning designations of certain areas of land within an area bounded by Hagys Mill Road (extended), Port Royal Avenue, Lare Street, Summit Avenue, Eva Street, Shawmont Avenue (extended), Railroad Right of Way, and the County Line from the existing zoning designations indicated on Maps "A1" and "A2" set forth below to the zoning designations indicated on Maps "B1" and "B2" set forth below.

SECTION 2. Nothing in this Ordinance shall supersede The Philadelphia Code Section 14-505 /ENV, Environmental Preservation Overlay District.

SECTION 3. This Ordinance shall become effective immediately.

Map A1 Existing Zoning

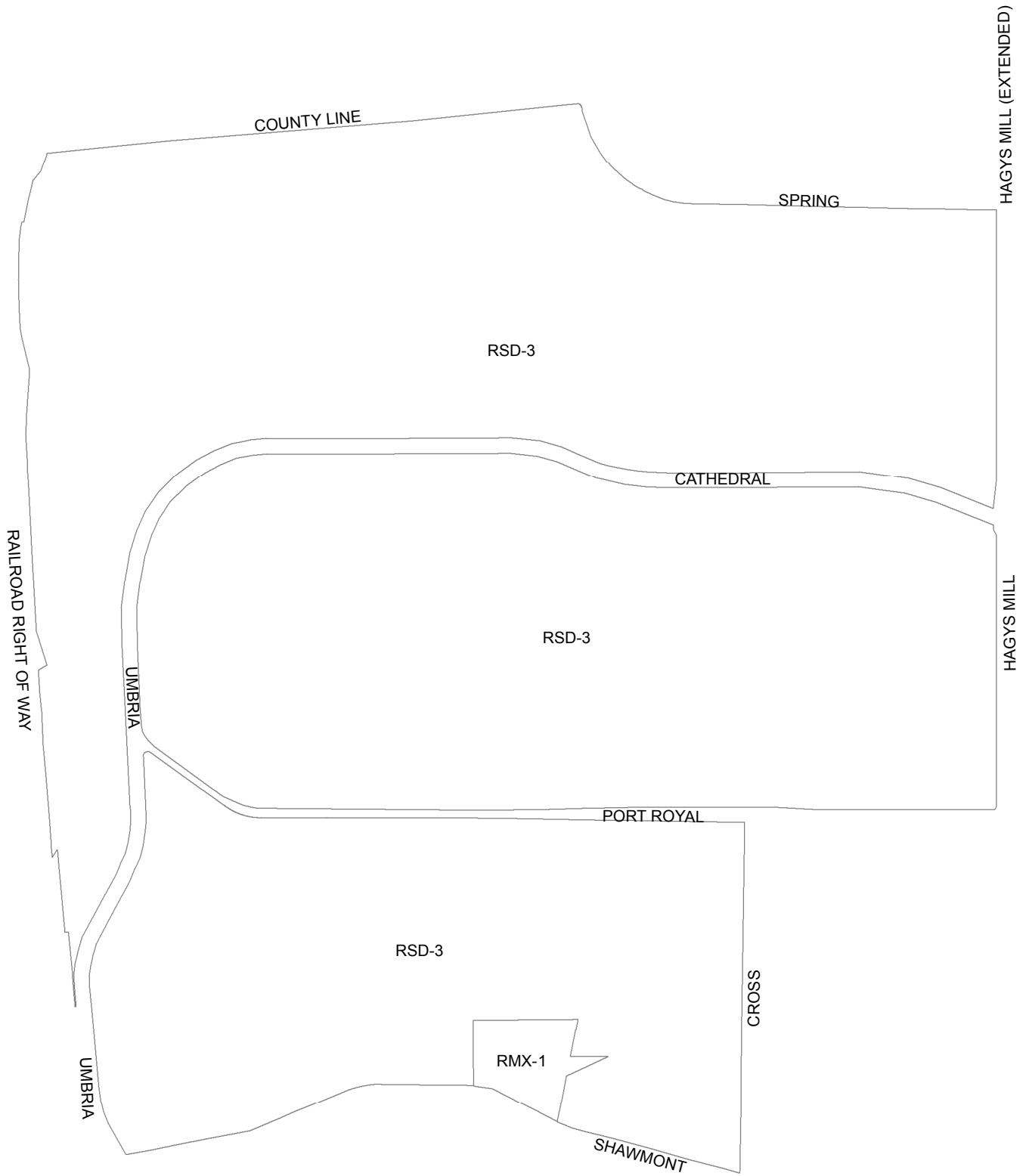

Zoning Districts

 RMX-1; RSD-3



Map A2 Existing Zoning

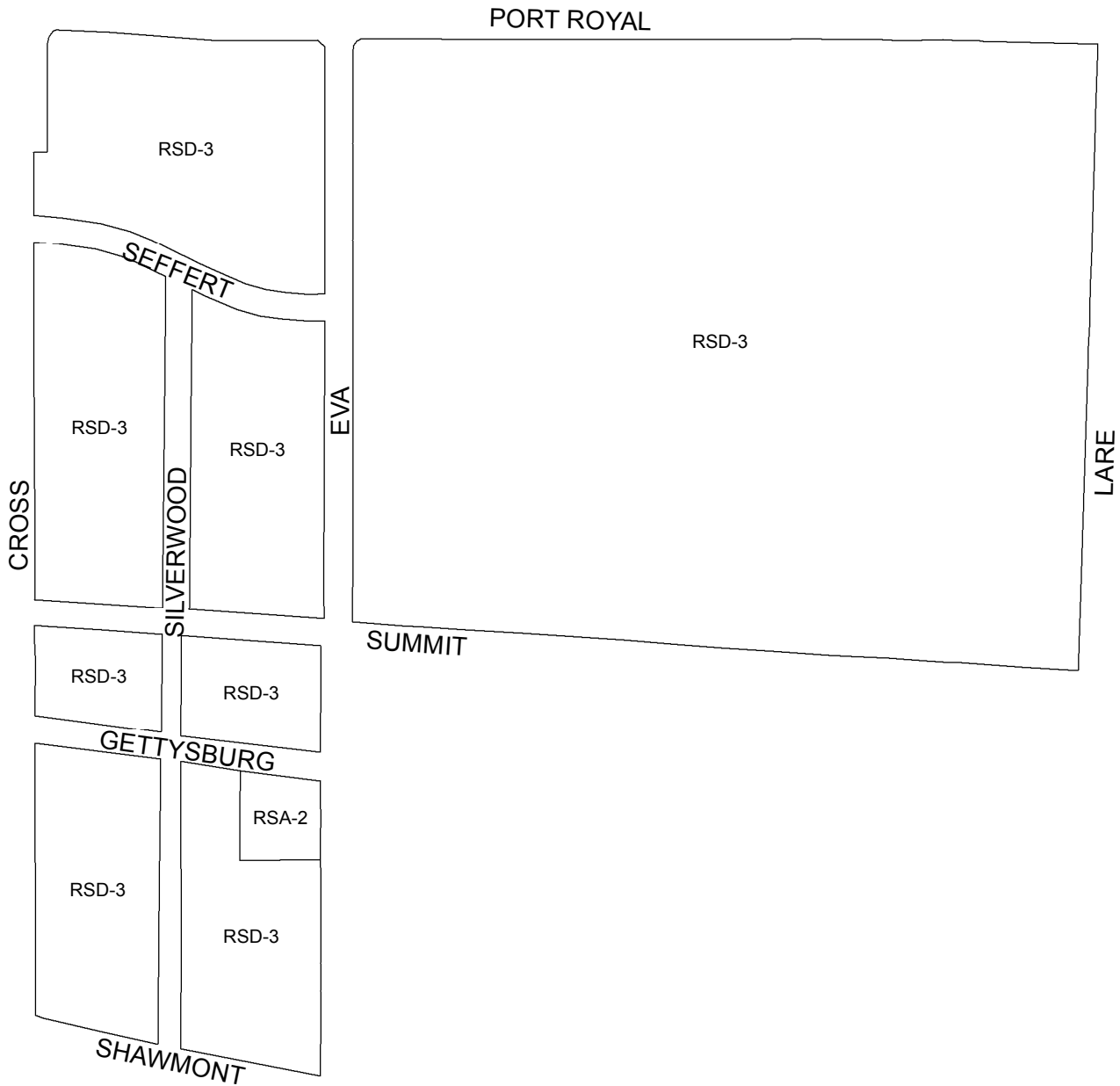

Zoning Districts

 RSA-2; RSD-3



Map B1 Proposed Zoning

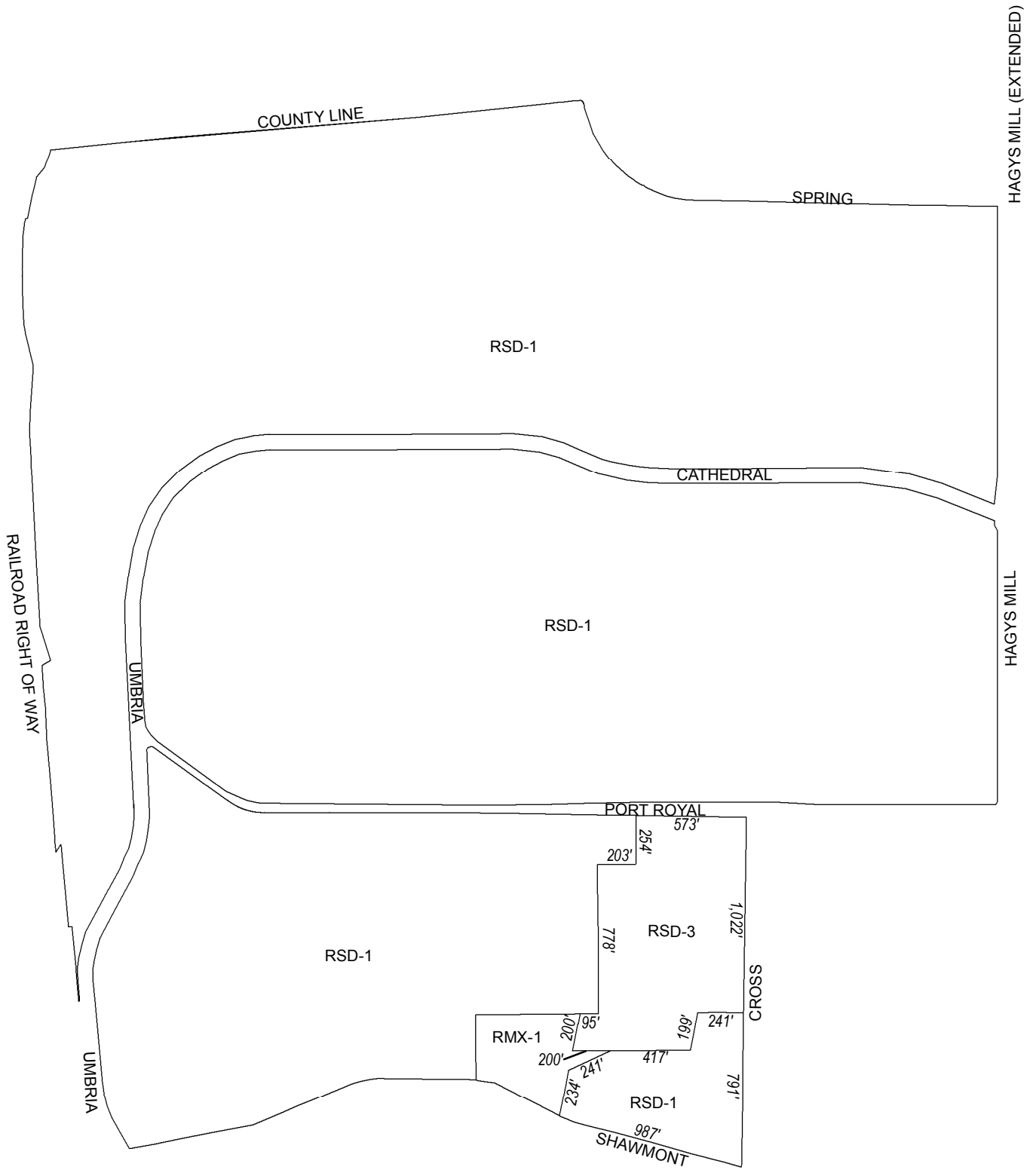

Zoning Districts

- RMX-1; RSD-1; RSD-3
- SP-PO-A



Map B2 Proposed Zoning

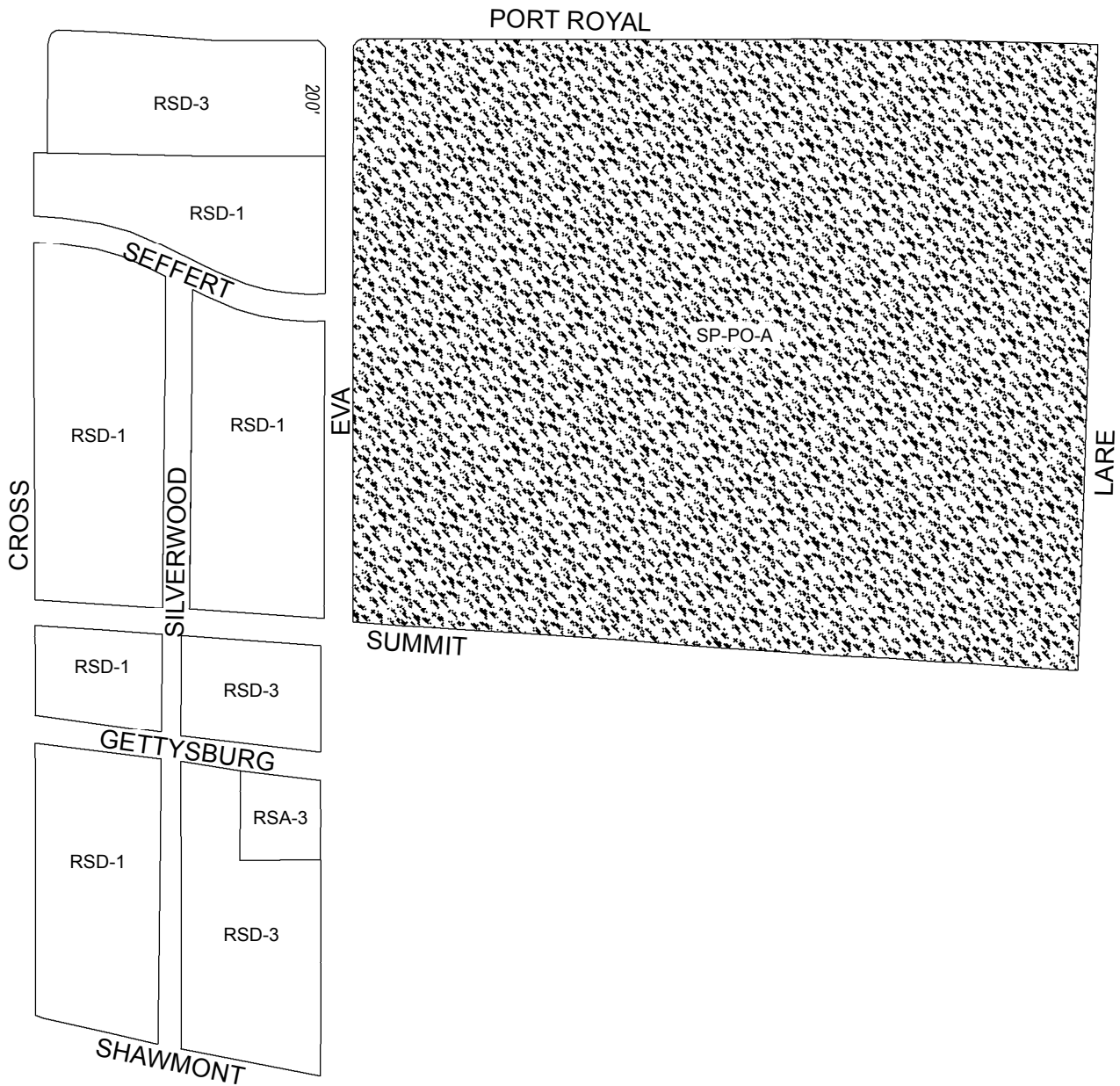

Zoning Districts

 RSA-3; RSD-1; RSD-3

 SP-PO-A



City of Philadelphia

BILL NO. 150489 continued

Certified Copy

CERTIFICATION: This is a true and correct copy of the original Bill, Passed by the City Council on June 18, 2015. The Bill was Signed by the Mayor on June 30, 2015.



Michael A. Decker
Chief Clerk of the City Council