



City of Philadelphia

City Council
Chief Clerk's Office
402 City Hall
Philadelphia, PA 19107

BILL NO. 260238
(As Amended in Committee, 5-13-26)

Introduced March 19, 2026

Councilmember Gauthier

**Referred to the
Committee on Rules**

AN ORDINANCE

To amend the Philadelphia Zoning Maps by changing the zoning designations of certain areas of land located within an area bounded by Ludlow Street, South 41st Street, West Girard Avenue, and North 48th Street.

THE COUNCIL OF THE CITY OF PHILADELPHIA HEREBY ORDAINS:

SECTION 1. Pursuant to Section 14-106 of the Philadelphia Code, the Philadelphia Zoning Maps are hereby amended by changing the zoning designations of certain areas of land within an area bounded by Ludlow Street, 41st Street, Girard Avenue, and 48th Street, from the existing zoning designations indicated on Maps "A1" through "A4," set forth below, to the zoning designations indicated on Maps "B1" and "B4," set forth below.

SECTION 2. This Ordinance shall become effective immediately.

City of Philadelphia

BILL NO. 260238, as amended continued

Map A1 Existing Zoning

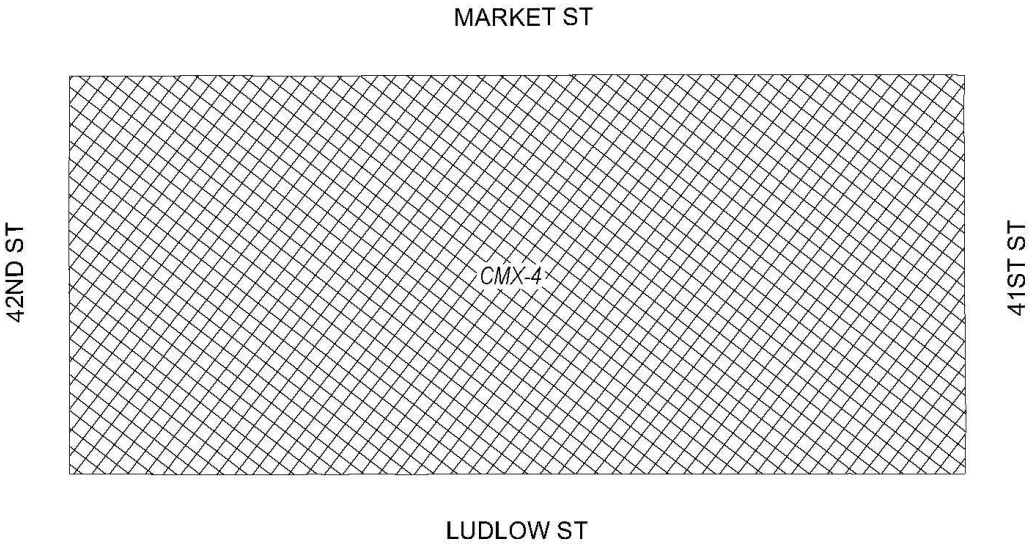

Zoning Districts

 CMX-4, Commercial Mixed-Use



City of Philadelphia

BILL NO. 260238, as amended continued

Map B1 Proposed Zoning

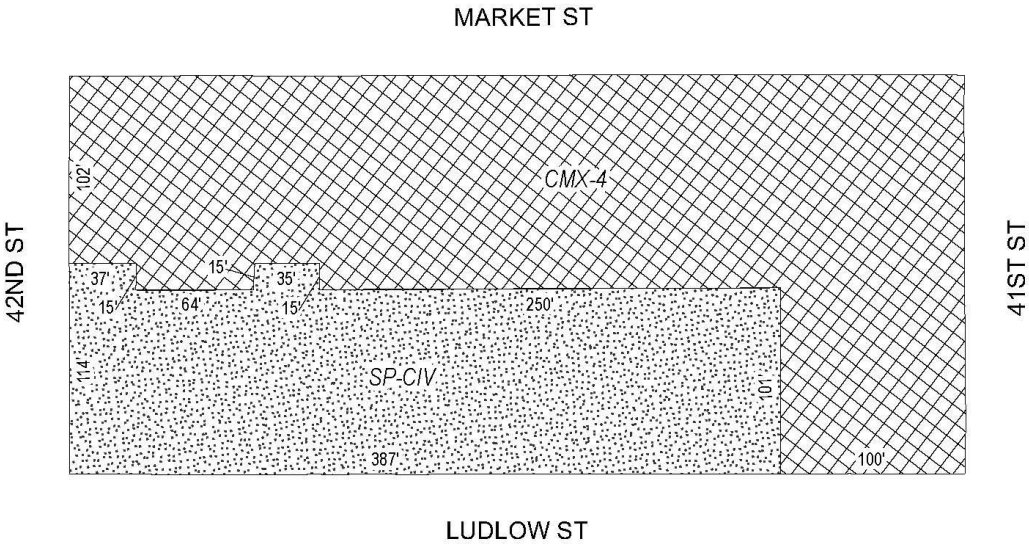

Zoning Districts

- CMX-4, Commercial Mixed-Use
- SP-CIV, Civic, Educational, and Medical



City of Philadelphia

BILL NO. 260238, as amended continued

Map A2 Existing Zoning

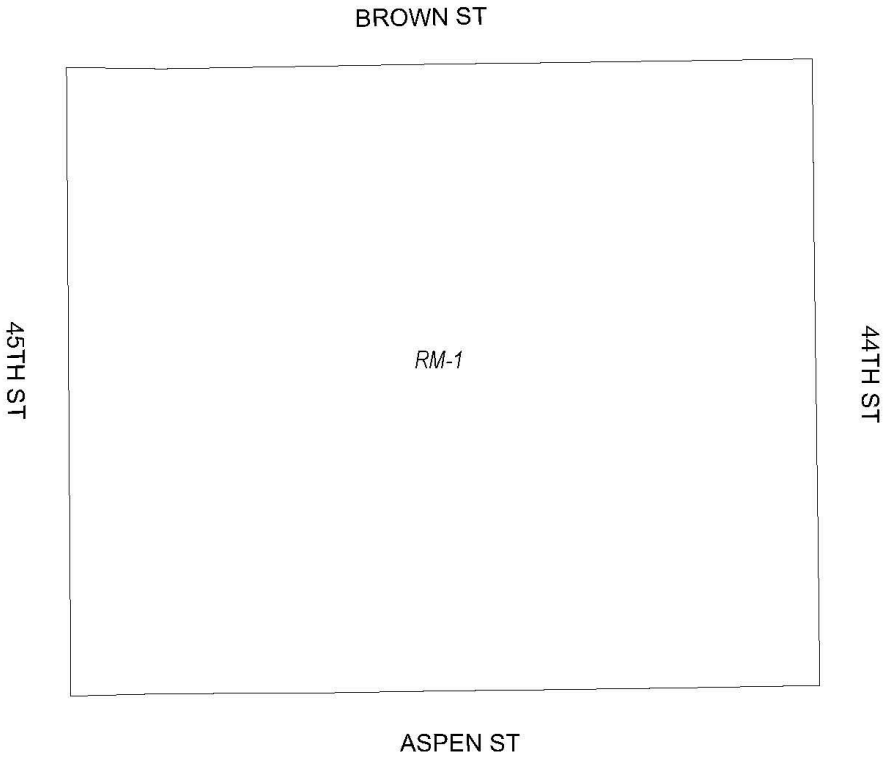

Zoning Districts

RM-1, Residential Multi-Family



City of Philadelphia

BILL NO. 260238, as amended continued

Map B2 Proposed Zoning

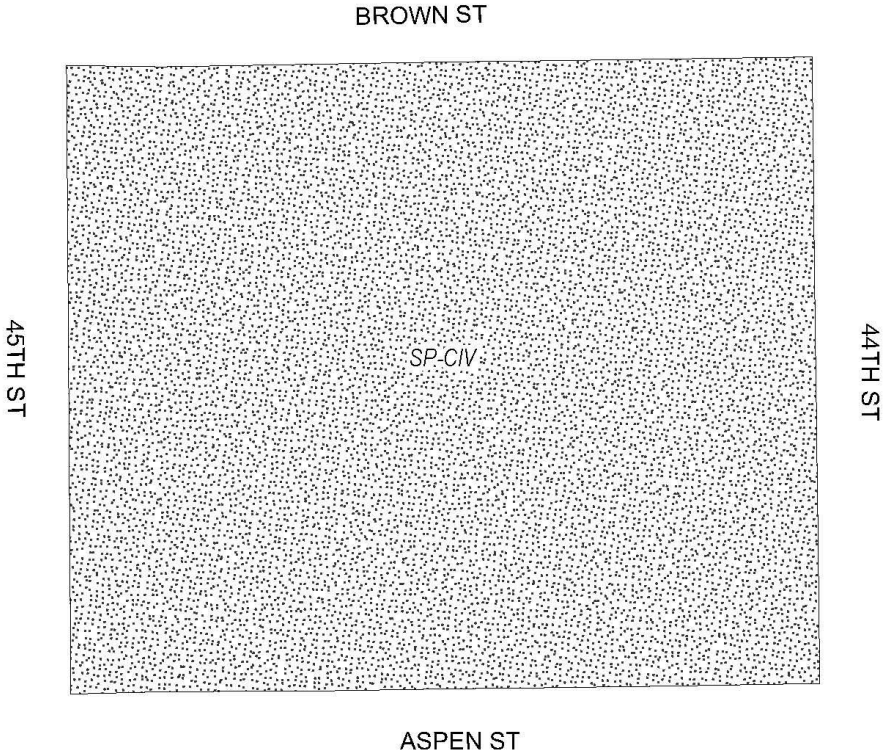

Zoning Districts

 SP-CIV, Civic, Educational, and Medical



City of Philadelphia

BILL NO. 260238, as amended continued

Map A3 Existing Zoning

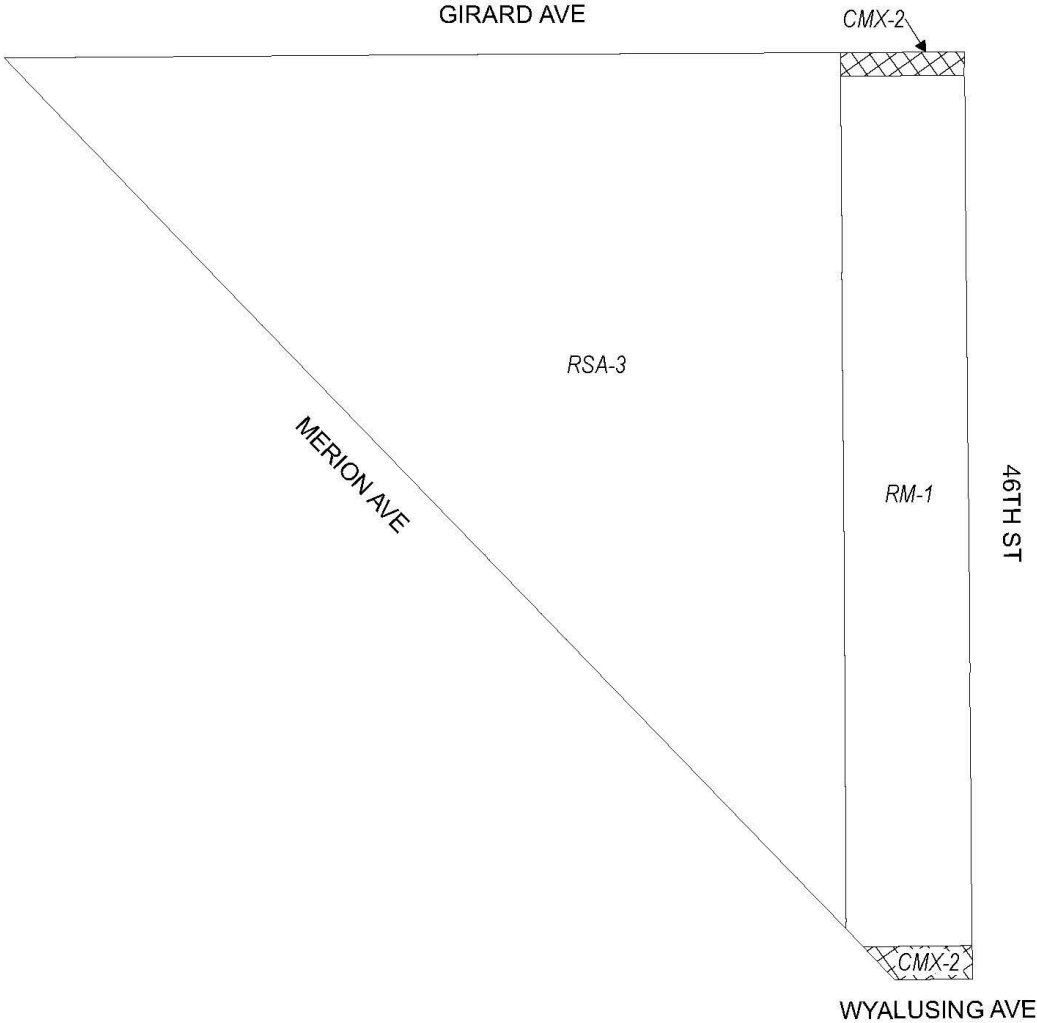

Zoning Districts

- ☒ CMX-2, Commercial Mixed-Use
- ☐ RM-1, Residential Multi-Family; RSA-3, Residential Single-Family Attached





City of Philadelphia

BILL NO. 260238, as amended continued

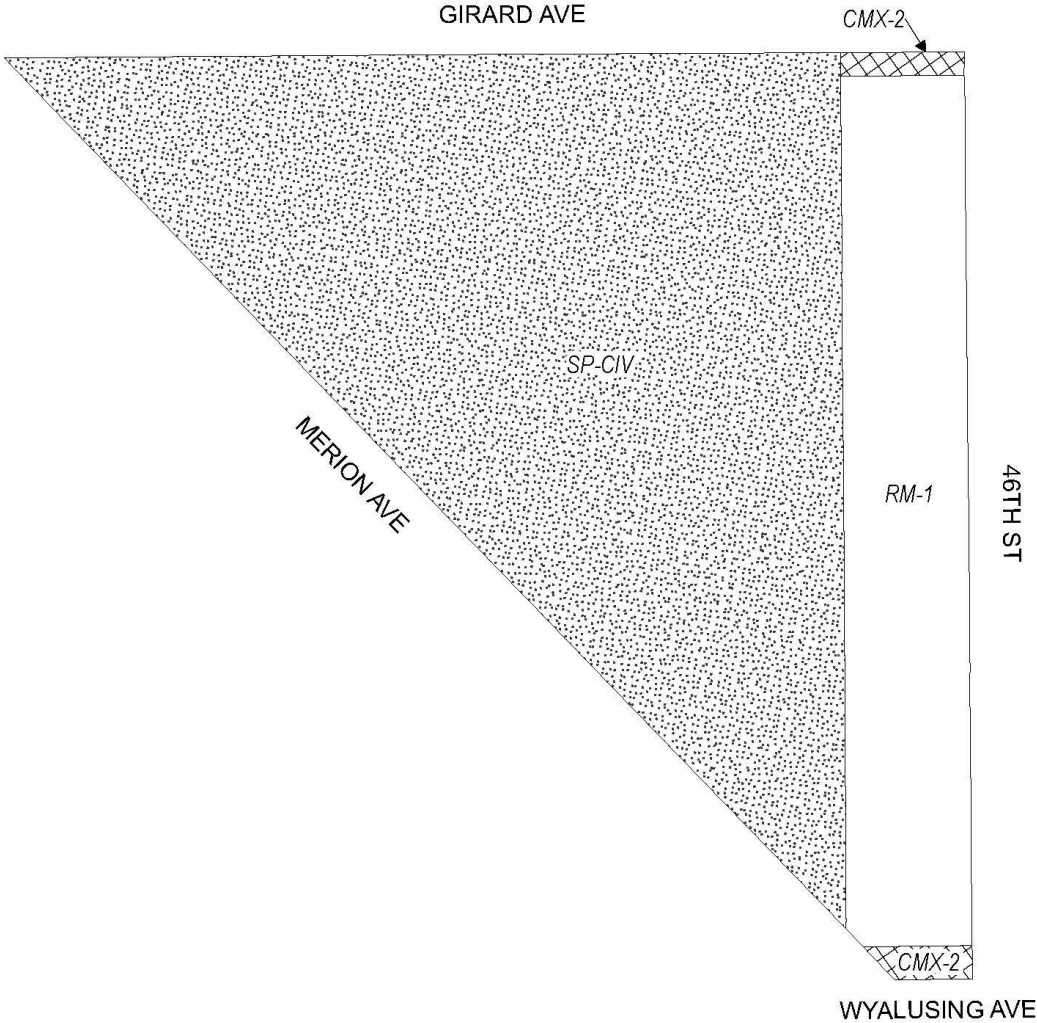
Map B3 Proposed Zoning



Zoning Districts

-  CMX-2, Commercial Mixed-Use
-  RM-1, Residential Multi-Family
-  SP-CIV, Civic, Educational, and Medical





City of Philadelphia

BILL NO. 260238, as amended continued

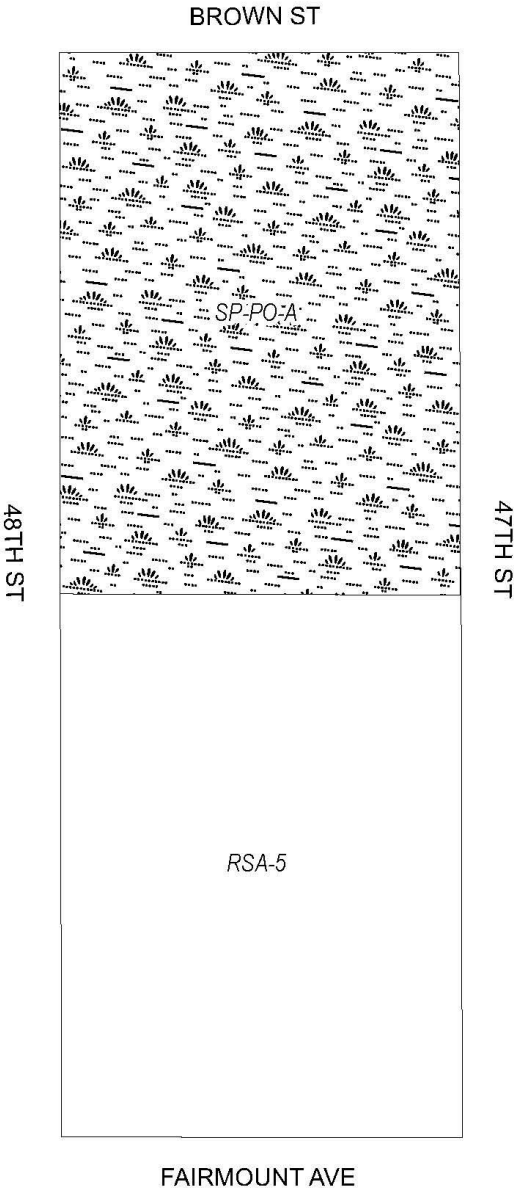
Map A4 Existing Zoning



Zoning Districts

-  RSA-5, Residential Single-Family Attached
-  SP-PO-A, Parks and Open Space



City of Philadelphia

BILL NO. 260238, as amended continued

Map B4 Proposed Zoning

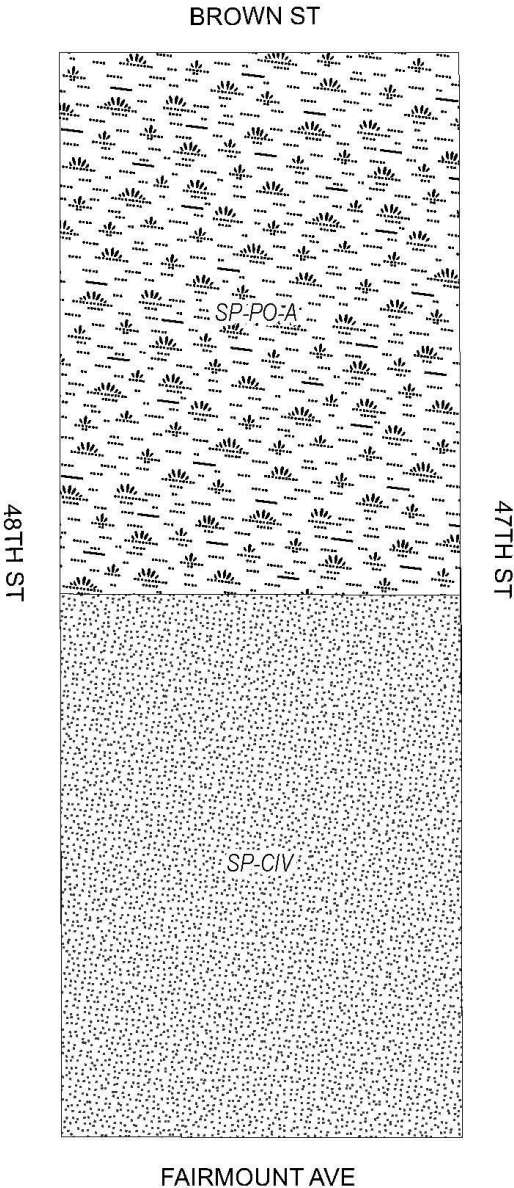

Zoning Districts

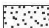
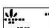
-  SP-CIV, Civic, Educational, and Medical
-  SP-PO-A, Parks and Open Space



City of Philadelphia

BILL NO. 260238, as amended continued