

Westpark - Complete Streets Roadway Breakdown

Road	Complete Streets		Two-Way / One-Way		Parking/Loading Lane(s) Provided?	Separate Bicycle Lane Provided?	Walking Zone Provided	Furnishing Zone Provided	Total Sidewalk Width Provided
	Type	Lane Width(s)	One-Way	Two-Way					
Existing Roadways									
Melville Way	Local	9'	Two-Way	Two-Way	Yes	No	4'*	4'	8'*
St. Malachy's Way	Local	14'	One-Way	One-Way	Yes	No	4'*	4'	8'*
Mandela Way	Local	11'	Two-Way	Two-Way	Yes	No	4'*	4'	8'*
Bust Street	Local	10'	Two-Way	Two-Way	Yes	No	4'*	4'	8'*
Proposed Roadways									
Nehemiah Way (West of S. Holden Street)	City Neighborhood	11'	Two-Way	Two-Way	Yes	Yes	7'*	5'*	12'*
Nehemiah Way (East of S. Holden Street)	City Neighborhood	11'	Two-Way	Two-Way	Yes	Yes	7'*	5'*	12'*
St. Malachy's Way	Local	10'	One-Way	One-Way	Yes	Yes	4'*	4'*	10'*
Mandela Way	Local	10'	One-Way	One-Way	No	Yes	6'*	5'*	11'*
Holden Street	Local	10'	One-Way	One-Way	No	Yes	6'*	4'*	10'*
Melville Street	Local	10'	One-Way	One-Way	No	Yes	6'*	4'*	10'*
Melville Street (North of Mandela Way)	Local	10'	One-Way	One-Way	No	Yes	6'*	4'*	10'*
Bust Street (North of Mandela Way)	Local	10'	One-Way	One-Way	No	Yes	6'*	4'*	10'*
Bust Street (South of St. Malachy)	Local	11'	One-Way	One-Way	Yes	Yes	6'*	4'*	10'*

KEY
 * Meets Complete Streets Manual minimum requirements
 ** Does not meet Complete Streets Manual minimum requirements

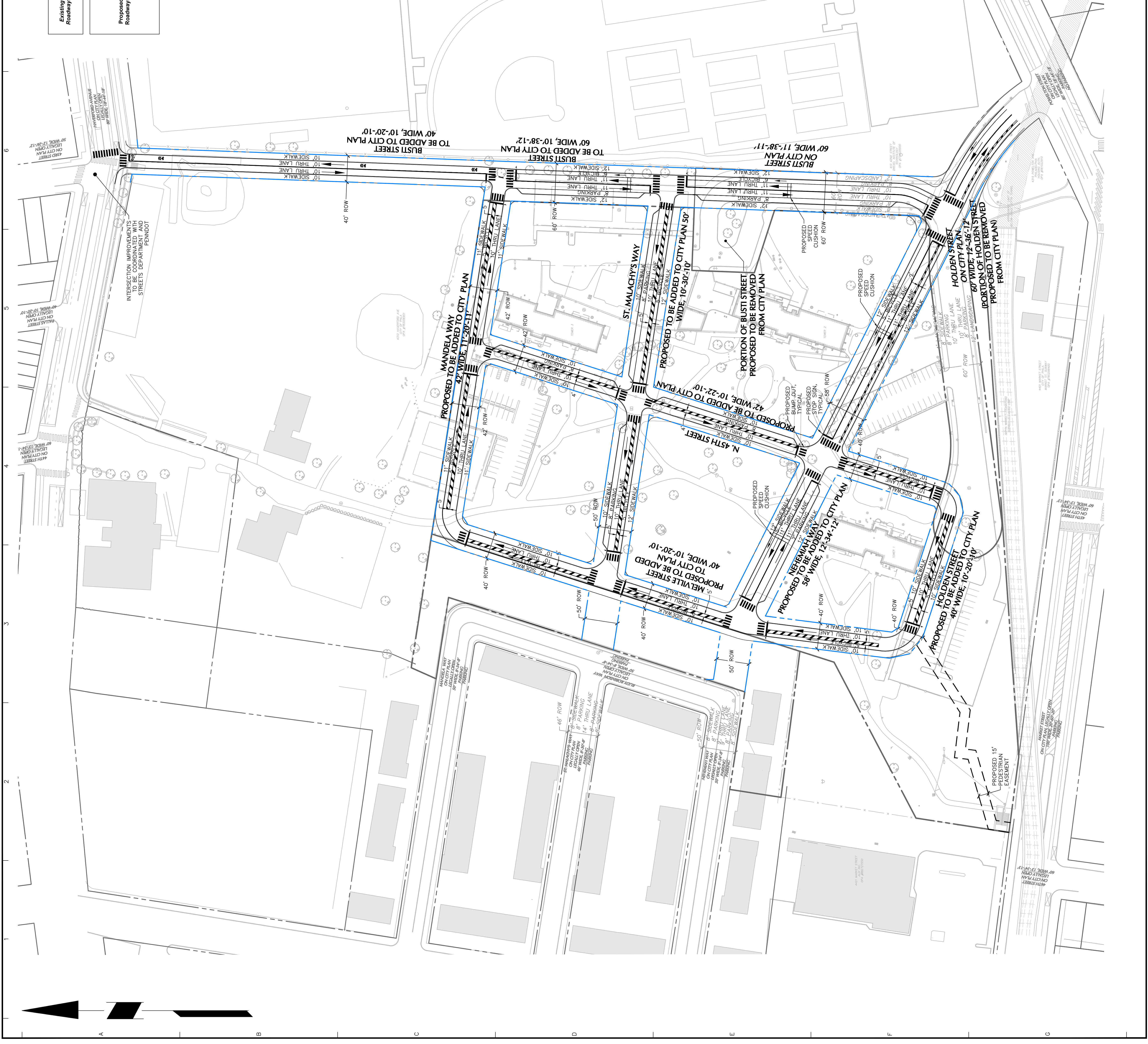
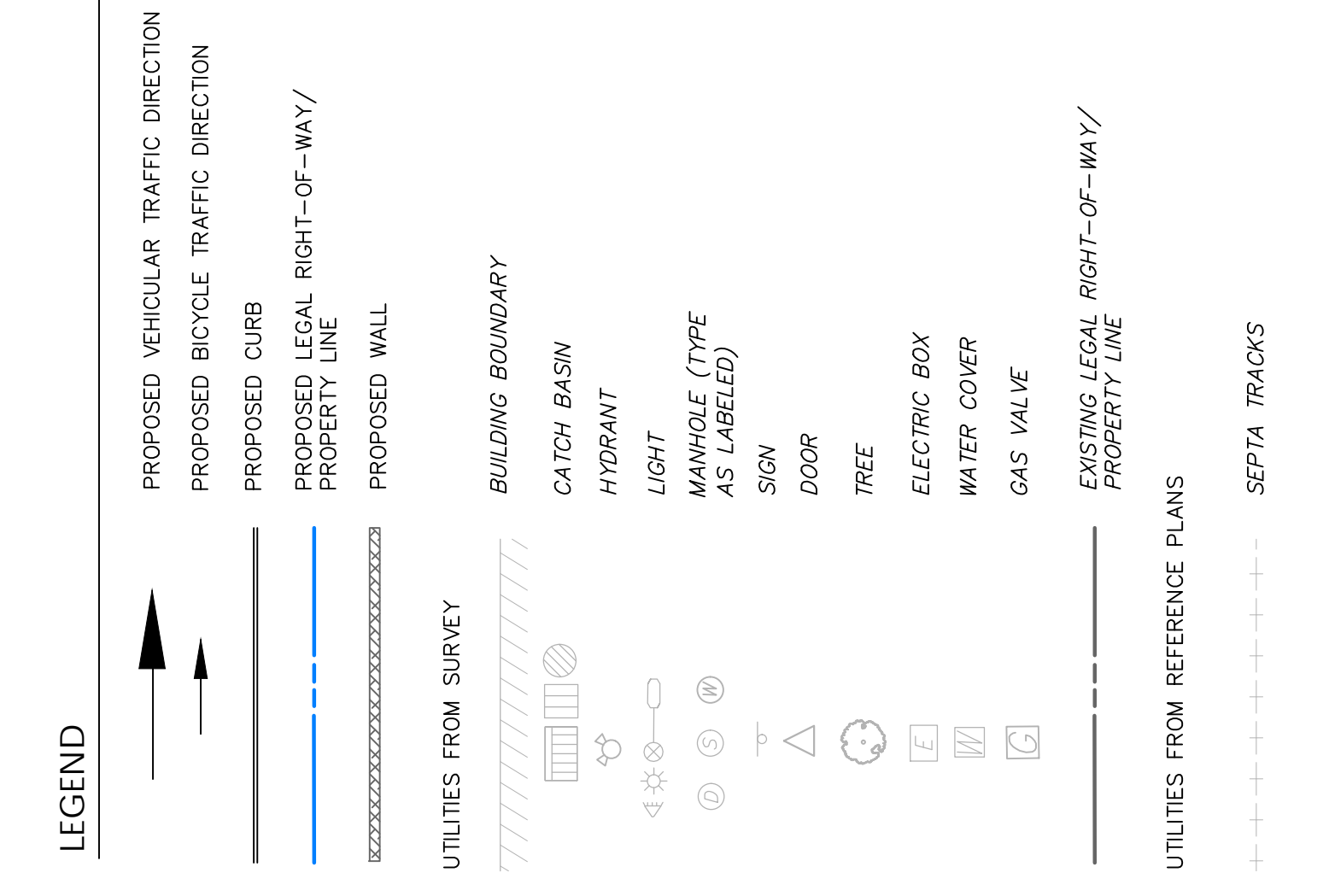

Date	Description	No.
Revisions		
9 NOVEMBER 2023		
PROGRESS PRINT		
Signature	Date	
LANGAN		
Langan Engineering and Environmental Services, Inc. 1818 Market Street, Suite 3300 Philadelphia, PA 19103		
T: 215.646.8900 F: 215.646.8901 www.langan.com		
Project		
WESTPARK DEVELOPMENT		
PHILADELPHIA COUNTY, PENNSYLVANIA		
CONCEPT ROADWAY - NORTH CONNECTION		
Project No.	Drawing No.	
220182801	220182801	
Date	Drawn By	
10/09/2023	CS	
Checked By		JCW
FIG. 1B		Sheet 0 of 8

