

City of Philadelphia



(Bill No. 110053)

AN ORDINANCE

Amending the Philadelphia Zoning Maps by changing the zoning designations of certain areas of land located within the area bounded by Milnor Street, Levick Street, the Delaware River, and Robbins Street, all under certain terms and conditions.

THE COUNCIL OF THE CITY OF PHILADELPHIA HEREBY ORDAINS:

SECTION 1. Pursuant to Section 14-103 of The Philadelphia Code, the Philadelphia Zoning Maps are hereby amended by changing the zoning designations of a certain area of land within the area bounded by Milnor Street, Levick Street, the Delaware River, and Robbins Street, from the existing zoning designations indicated on Map “A” set forth below, to the zoning designations indicated on Map “B” set forth below.



SECTION 2. Notwithstanding Section 14-103(2)(e), upon authorization by Council and confirmation by the Board of Surveyors of a change to the City Plan striking Delaware Avenue between Robbins Street and Levick Street, the Philadelphia Zoning Maps shall be amended to designate the entirety of the land formerly dedicated to Delaware Avenue between Robbins Street and Levick Street as a “Recreational” (REC) zoning district pursuant to Section 14-703.

SECTION 3. This Ordinance shall become effective immediately.

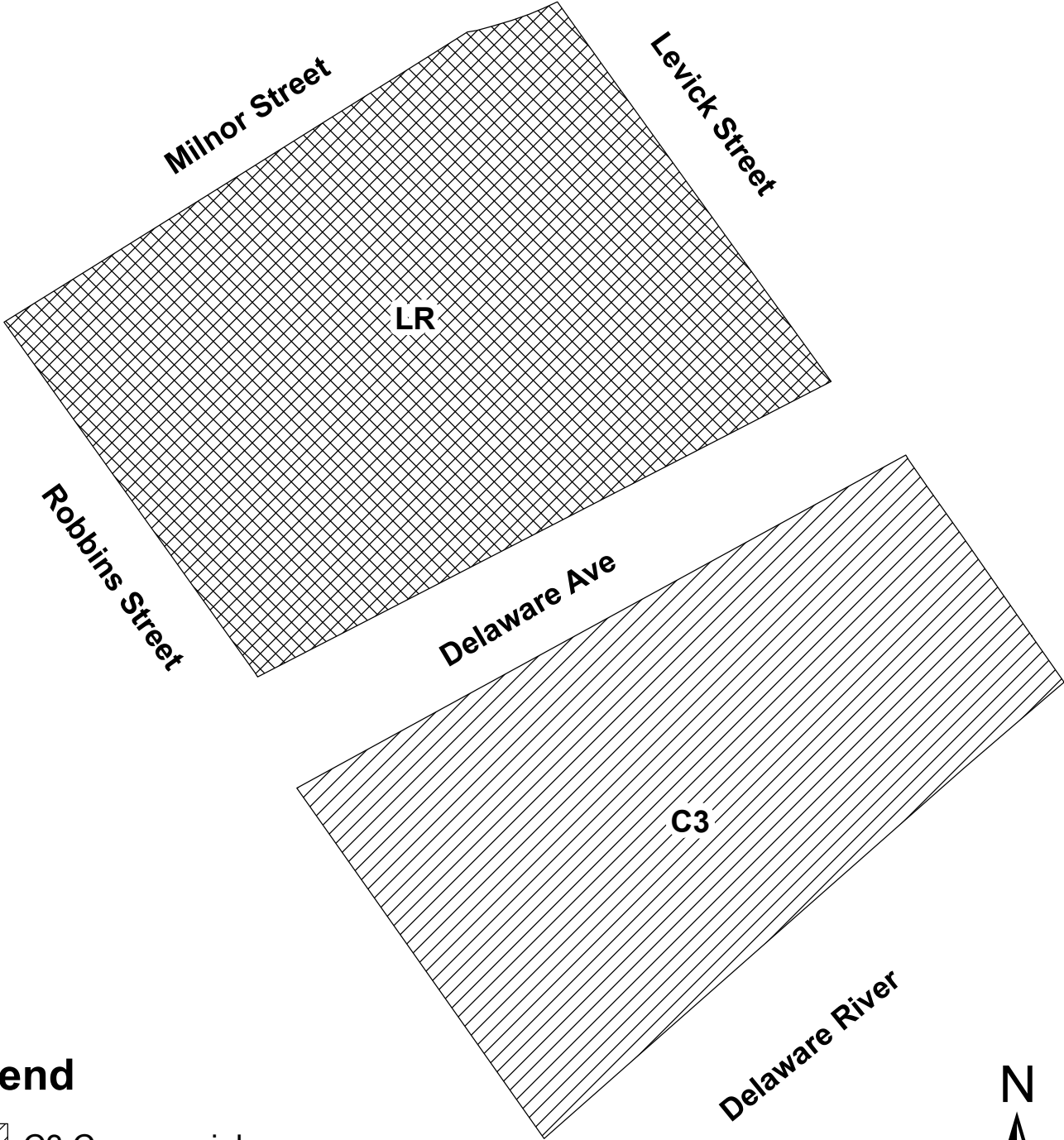
MAP A - EXISTING ZONING



Legend

-  C3 Commercial
-  LR Industrial



MAP B - PROPOSED ZONING

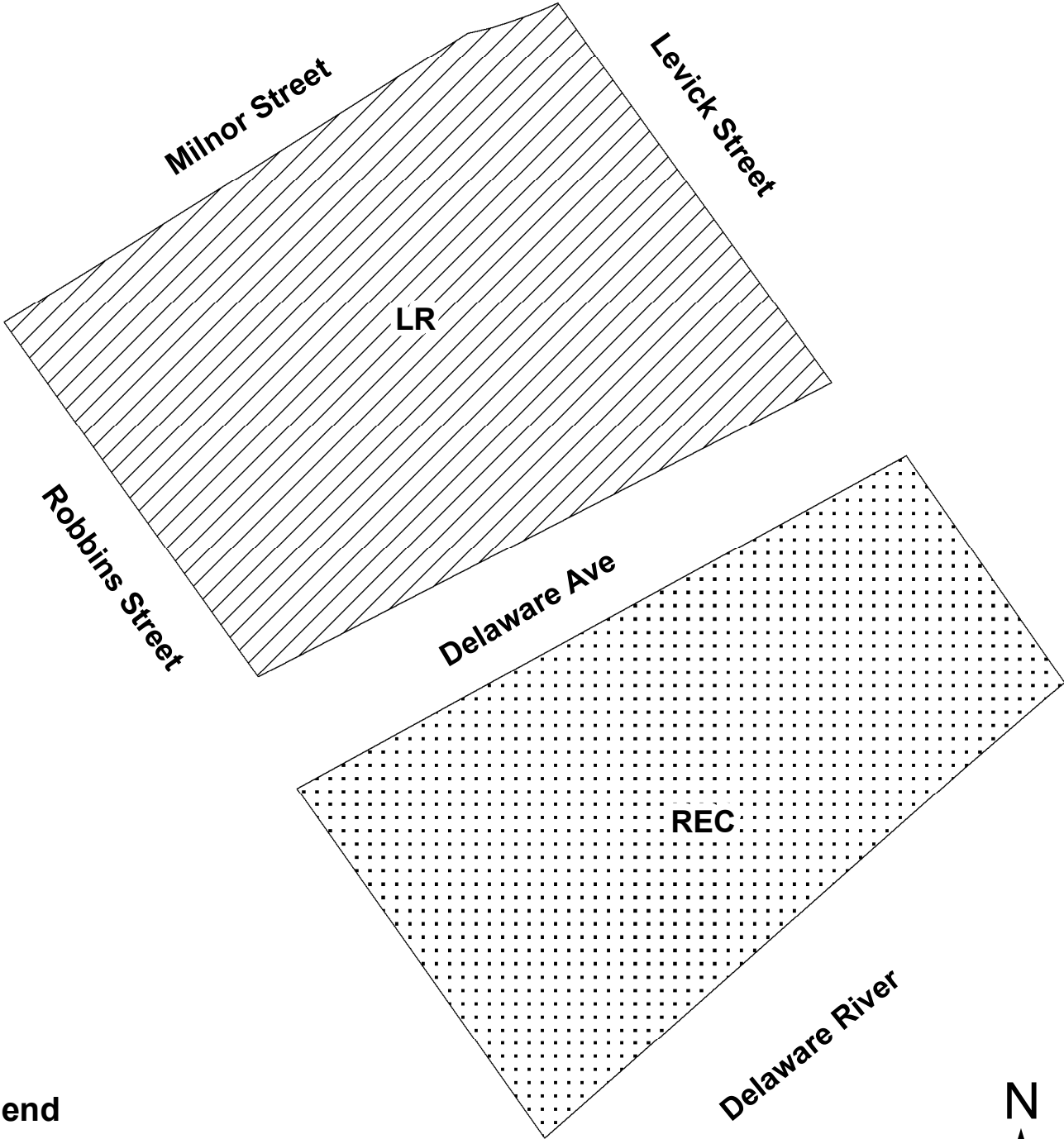

Legend

- REC REC Recreation
- LR Industrial



City of Philadelphia

BILL NO. 110053 continued

Certified Copy

CERTIFICATION: This is a true and correct copy of the original Bill, Passed by the City Council on March 10, 2011. The Bill was Signed by the Mayor on March 23, 2011.

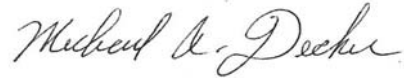

Michael A. Decker
Chief Clerk of the City Council