

# City of Philadelphia



(Bill No. 150239)

## AN ORDINANCE

To amend the Philadelphia Zoning Maps by changing the zoning designations of certain areas of land located within an area bounded by Germantown Avenue, School House Lane, Greene Street, and Armat Street.

### *THE COUNCIL OF THE CITY OF PHILADELPHIA HEREBY ORDAINS:*



SECTION 1. Pursuant to Section 14-106 of The Philadelphia Code, the Philadelphia Zoning Maps are hereby amended by changing the zoning designations of certain areas of land within an area bounded by Germantown Avenue, School House Lane, Greene Street, and Armat Street, from the existing zoning designations indicated on Map A set forth below to the zoning designations indicated on Map B set forth below.

SECTION 2. This Ordinance shall become effective immediately.

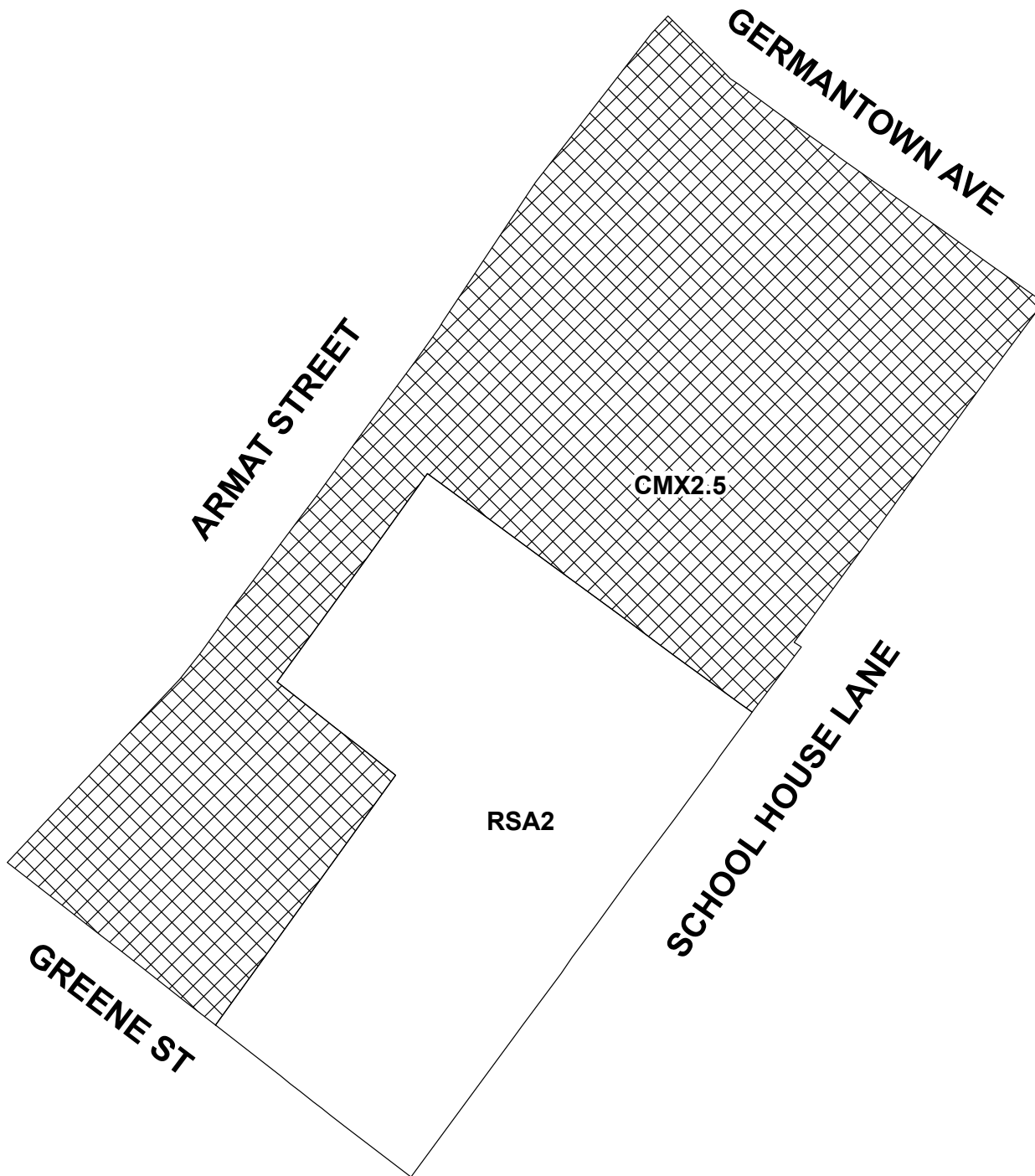
# MAP A - EXISITNG ZONING



## Legend



-  CMX2.5 Commercial Mixed-Use
-  RSA2 Residential Single Family

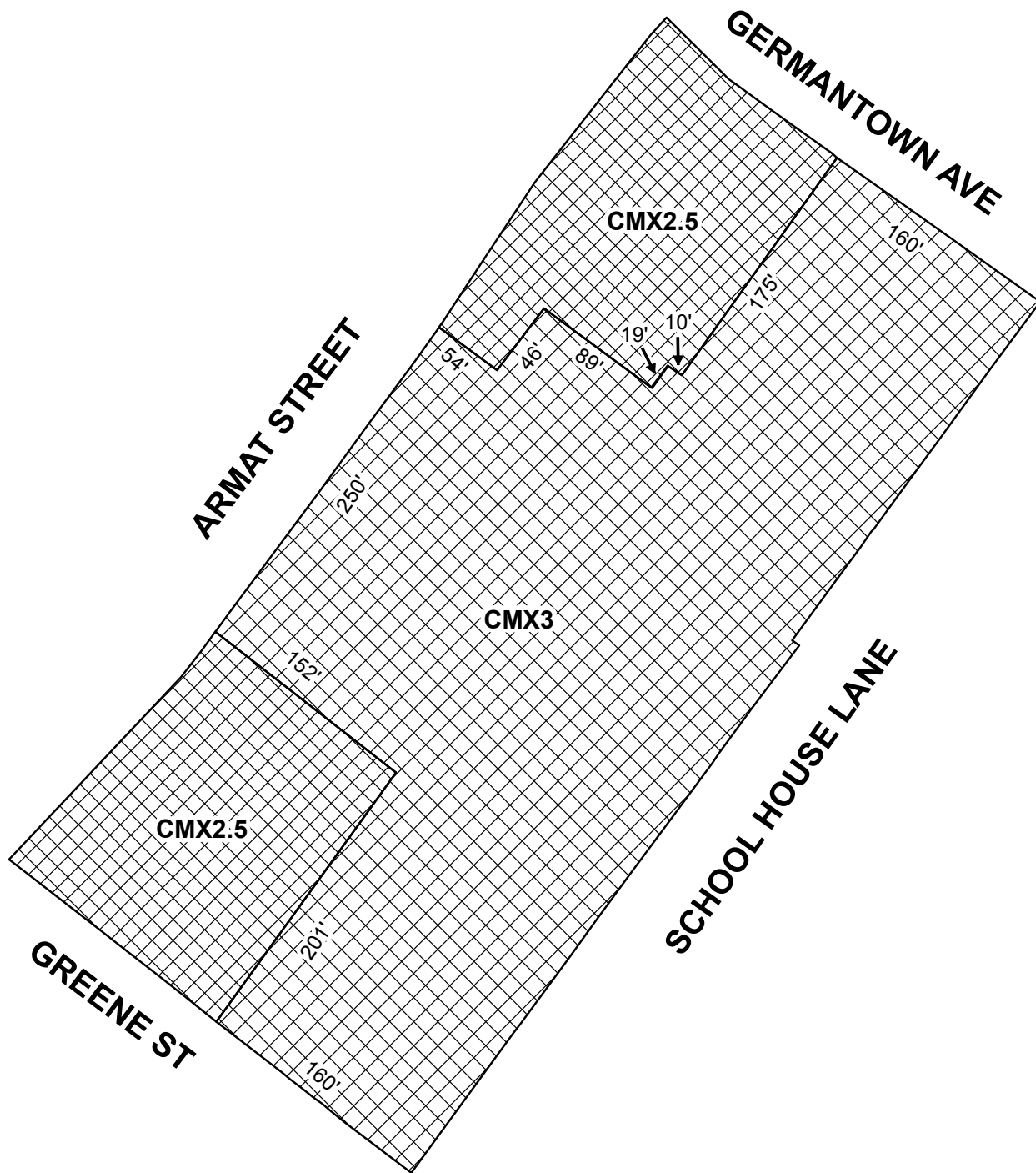

# MAP B - PROPOSED ZONING



## Legend

-  CMX2.5 Commercial Mixed-Use
-  CMX3 Commercial Mixed-Use



# City of Philadelphia

BILL NO. 150239 continued

Certified Copy

CERTIFICATION: This is a true and correct copy of the original Bill, Passed by the City Council on June 11, 2015. The Bill was Signed by the Mayor on June 16, 2015.



Michael A. Decker  
Chief Clerk of the City Council