

# Map A1 Existing Zoning

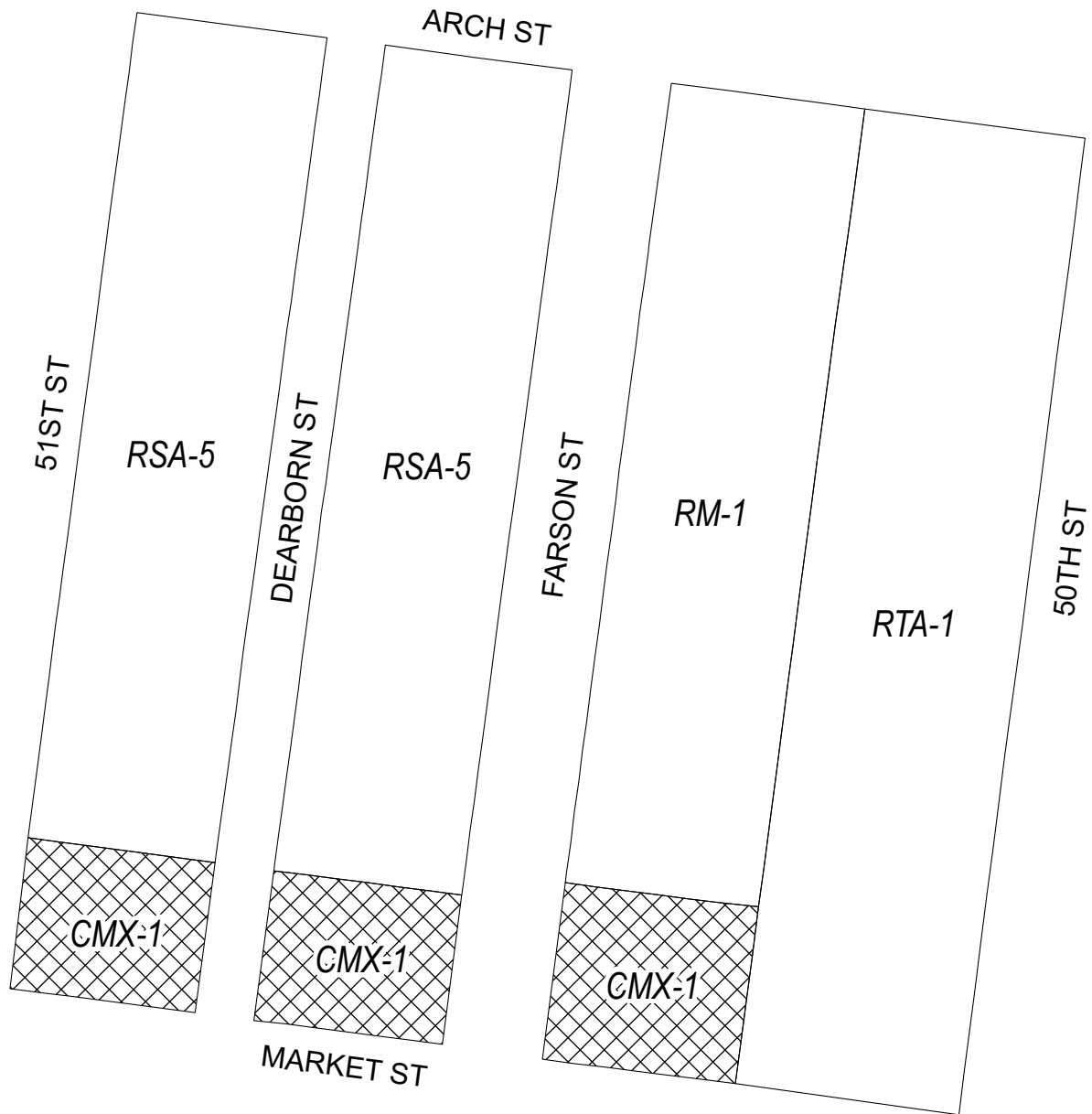

## Zoning Districts



CMX-1, Commercial Mixed-Use





RM-1, Residential Multi-Family; RSA-5, Residential Single-Family Attached; RTA-1, Residential Two-Family Attached

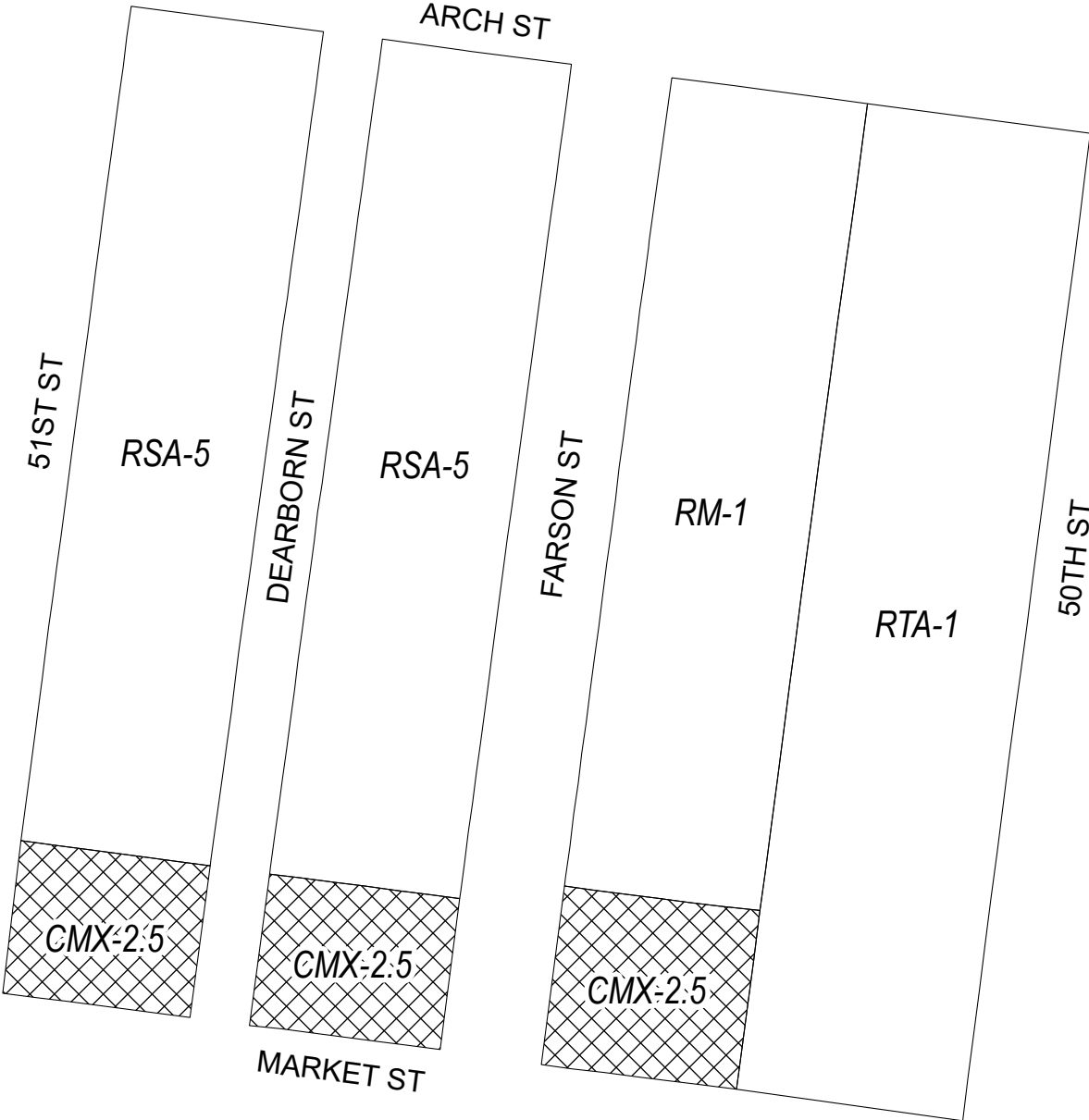

# Map B1 Proposed Zoning



## Zoning Districts

-  CMX-2.5, Commercial Mixed-Use
-  RM-1, Residential Multi-Family; RSA-5, Residential Single-Family Attached; RTA-1, Residential Two-Family Attached



# Map A2 Existing Zoning



## Zoning Districts



 RM-1, Residential Multi-Family;  RSA-3, Residential Single-Family Attached

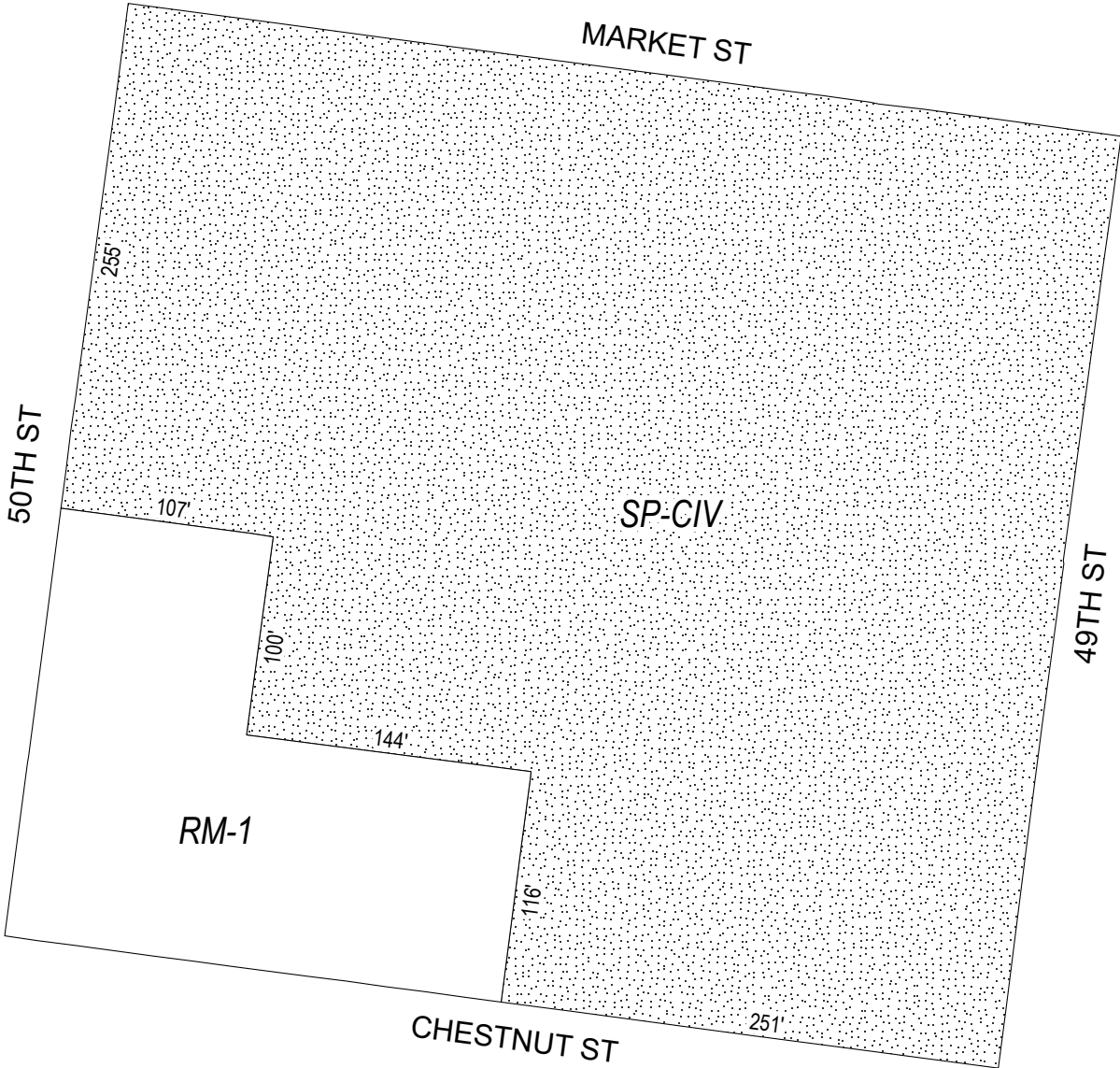

# Map B2 Proposed Zoning



## Zoning Districts

-  RM-1, Residential Multi-Family
-  SP-CIV, Civic, Educational, and Medical

