



City of Philadelphia

City Council
Chief Clerk's Office
402 City Hall
Philadelphia, PA 19107

BILL NO. 150848

Introduced November 12, 2015

Councilmember Tasco

**Referred to the
Committee on Rules**

AN ORDINANCE

To amend the Philadelphia Zoning Maps by changing the zoning designations of certain areas of land located within an area bounded by Stenton Avenue, Eastburn Street, Rodney Street, East Haines Street, Homer Street, Cornelius Street, and East Walnut Lane.

THE COUNCIL OF THE CITY OF PHILADELPHIA HEREBY ORDAINS:

SECTION 1. Pursuant to Section 14-106 of The Philadelphia Code, the Philadelphia Zoning Maps are hereby amended by changing the zoning designations of certain areas of land within an area bounded by Stenton Avenue, Eastburn Street, Rodney Street, East Haines Street, Homer Street, Cornelius Street, and East Walnut Lane, from the existing zoning designations indicated on Map "A" set forth below to the zoning designations indicated on Map "B" set forth below.

SECTION 2. This Ordinance shall become effective immediately.

MAP A - EXISTING MAP

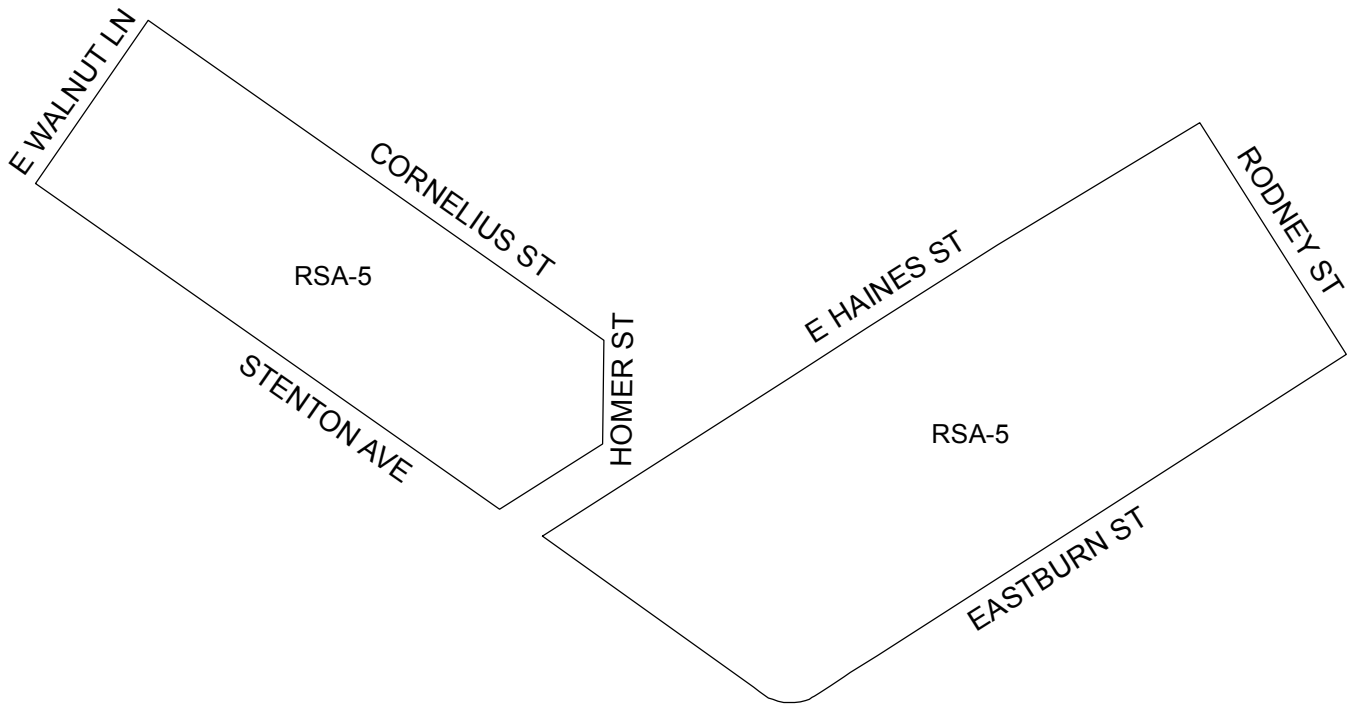

Legend

RSA-5 RSA-5 Residential Single-Family Attached

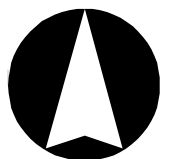

MAP B - PROPOSED MAP

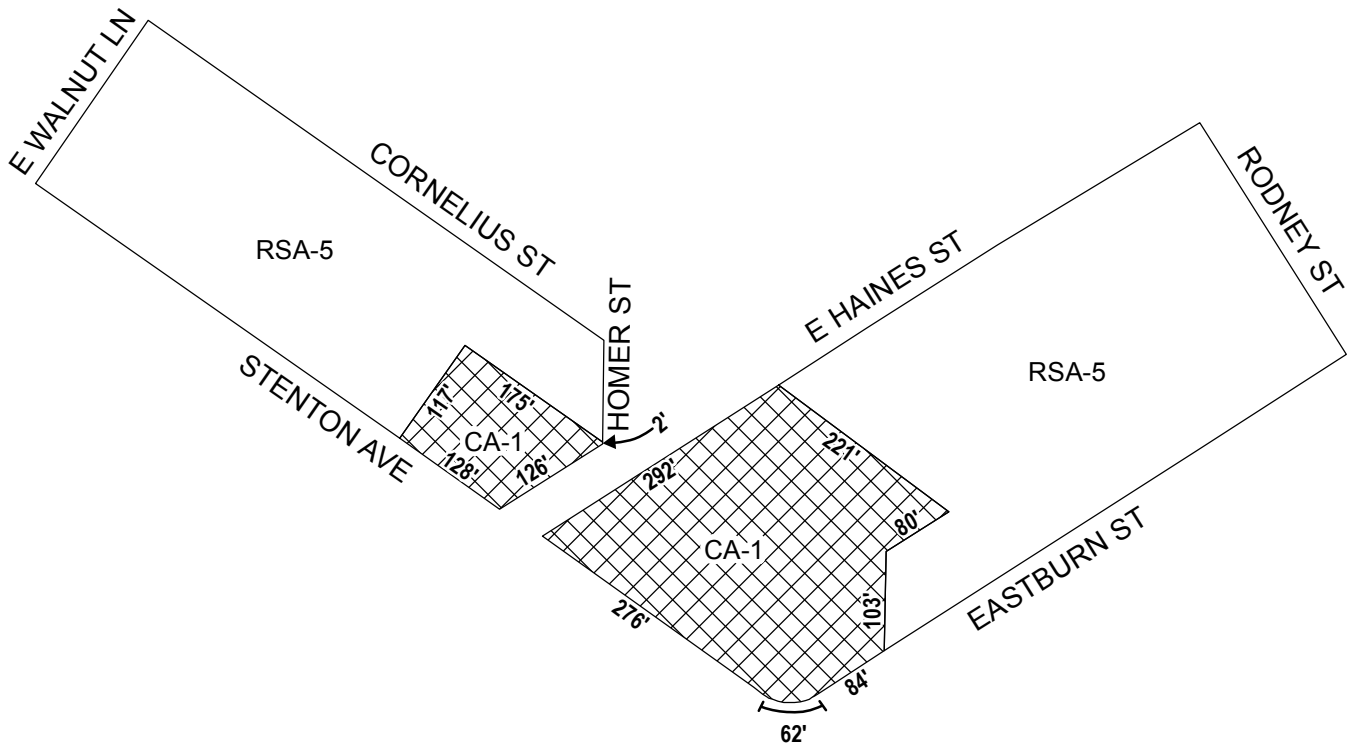

Legend



CA-1 Auto-Oriented Commercial



RSA-5 Residential Single-Family Attached

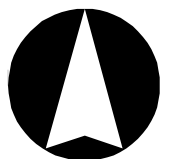

City of Philadelphia

BILL NO. 150848 continued