



City of Philadelphia

City Council
Chief Clerk's Office
402 City Hall
Philadelphia, PA 19107

BILL NO. 210744

Introduced September 23, 2021

Councilmember Henon

**Referred to the
Committee on Rules**

AN ORDINANCE

To amend the Philadelphia Zoning Maps by changing the zoning designations of certain areas of land located within an area bounded by Germania Street, Arendell Avenue, Delaware Avenue, and Linden Avenue.

THE COUNCIL OF THE CITY OF PHILADELPHIA HEREBY ORDAINS:

SECTION 1. Pursuant to Section 14-106 of The Philadelphia Code, The Philadelphia Zoning Maps are hereby amended by changing the zoning designations of certain areas of land within an area bounded by Germania Street, Arendell Avenue, Delaware Avenue, and Linden Avenue from the existing zoning designations indicated on Map "A," set forth below, to the zoning designations indicated on Map "B," set forth below.

SECTION 2. This Ordinance shall take effect immediately.

City of Philadelphia

BILL NO. 210744 continued

Map A Existing Zoning

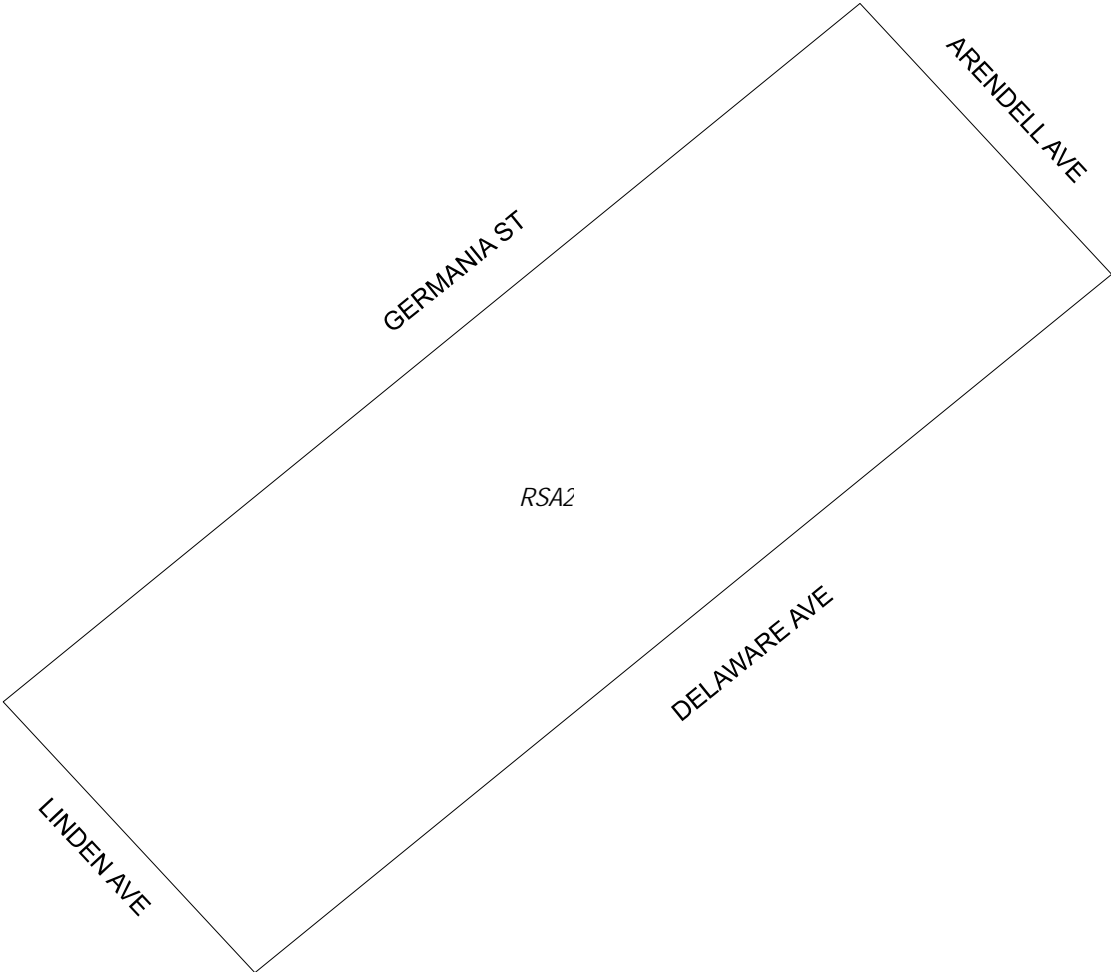

Zoning Districts

RSA-2, Residential Single-Family Attached





City of Philadelphia

BILL NO. 210744 continued

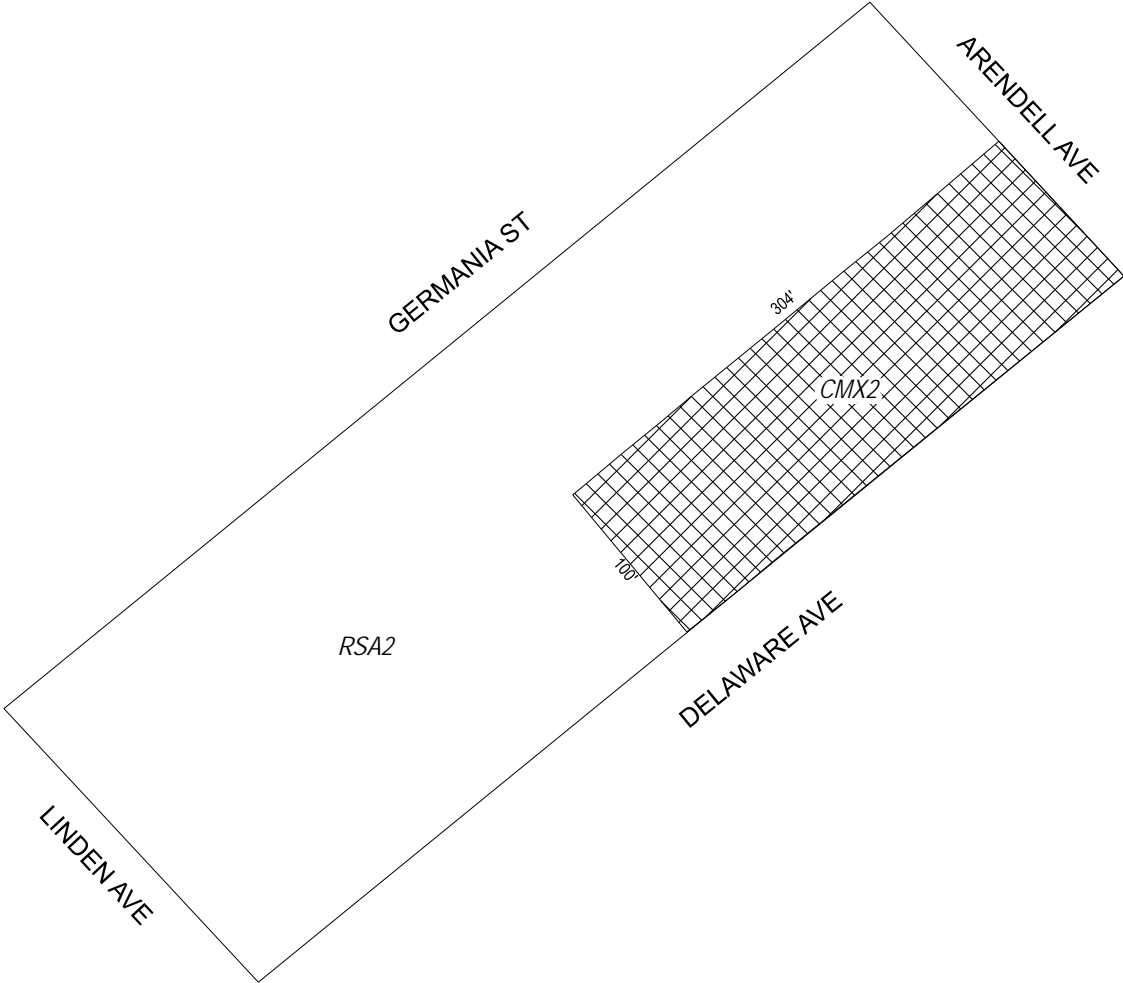
Map B Proposed Zoning



Zoning Districts

-  CMX-2, Commercial Mixed-Use
-  RSA-2, Residential Single-Family Attached



City of Philadelphia

BILL NO. 210744 continued