

# City of Philadelphia



(Bill No. 230852)

## AN ORDINANCE

Authorizing the paving of Melville Street from Mandela Way to Holden Street, Holden Street from Melville Street to 45th Street, Nehemiah Way from Melville Street to Powelton Avenue, Busti Street from Nehemiah Way to Haverford Avenue, Mandela Way from Melville Street to Busti Street, 45th Street from Mandela Way to Holden Street, and St. Malachy's Way from Melville Street to Busti Street, under certain terms and conditions.

### *THE COUNCIL OF THE CITY OF PHILADELPHIA HEREBY ORDAINS:*

SECTION 1. The Procurement Commissioner, pursuant to the provisions of Sections 11-502 and 11-503 of The Philadelphia Code, is hereby authorized to enter into a contract for the paving of Melville Street from Mandela Way to Holden Street, Holden Street from Melville Street to 45th Street, Nehemiah Way from Melville Street to Powelton Avenue, Busti Street from Nehemiah Way to Haverford Avenue, Mandela Way from Melville Street to Busti Street, 45th Street from Mandela Way to Holden Street, and St. Malachy's Way from Melville Street to Busti Street.

Subject to all other sections of this Ordinance, the locations of the roads to be paved, including Melville Street from Mandela Way to Holden Street, Holden Street from Melville Street to 45th Street, Nehemiah Way from Melville Street to Powelton Avenue, Busti Street from Nehemiah Way to Haverford Avenue, Mandela Way from Melville Street to Busti Street, 45th Street from Mandela Way to Holden Street, and St. Malachy's Way from Melville Street to Busti Street are generally shown on that certain Concept Roadway-North Connection of Westpark Development attached to this Ordinance as Exhibit "A" and incorporated herein by this reference (the "Roadway Plan").

SECTION 2. In lieu of the provisions of Section 1, the party in interest shall file an agreement and bond with corporate surety, satisfactory to the City Solicitor and in an amount determined by the Streets Department, to cover the cost of the work required to completely pave Melville Street from Mandela Way to Holden Street, Holden Street from Melville Street to 45th Street, Nehemiah Way from Melville Street to Powelton Avenue, Busti Street from Nehemiah Way to Haverford Avenue, Mandela Way from Melville Street to Busti Street, 45th Street from Mandela Way to Holden Street, and St. Malachy's Way from Melville Street to Busti Street, at its sole cost and expense in accordance with the specifications and requirements of the City of Philadelphia.

SECTION 3. No contract or agreement pursuant to Sections 1 and 2 of this Ordinance for the paving work authorized herein shall be entered into unless and until the said streets have been properly dedicated or opened to the use of the public.

# City of Philadelphia

*BILL NO. 230852 continued*

Certified Copy

SECTION 4. This Ordinance shall not become effective unless the sum of two hundred dollars (\$200.00), toward the cost thereof, is paid into the City Treasury within one hundred and twenty (120) days after this Ordinance becomes law.



Westpark - Complete Streets Roadway Breakdown									
Road	Complete Streets Type	Lane Width(s)	Two-Way/One-Way	Parking/Loading Lane(s) Provided?	Separate Bicycle Lane Provided?	Walking Zone Provided	Furnishing Zone Width Provided	Total Sidewalk Width	
Existing Roadways	Local	9'	Two-Way	Yes	No	4' **	4' **	8' **	
St. Malachy's Way	Local	14'	One-Way	Yes	No	4' **	4' **	8' **	
Mandela Way	Local	11'	Two-Way	Yes	No	4' **	4' **	8' **	
St. Malachy's Way	Local	10'	Two-Way	Yes	No	4' **	4' **	8' **	
Proposed Roadways	Local	11'	Two-Way	Yes	Yes	5' *	5' *	12' *	
Nehemiah Way (West of S. Holden Street)	City Neighborhood	11'	Two-Way	Yes	Yes	7' *	7' *	12' *	
Nehemiah Way (East of S. Holden Street)	City Neighborhood	11'	Two-Way	Yes	Yes	7' *	7' *	12' *	
St. Malachy's Way	Local	10'	One-Way	Yes	Yes	4' *	4' *	10' *	
Mandela Way	Local	10'	One-Way	No	Yes	6' *	6' *	11' *	
Holden Street	Local	10'	One-Way	No	Yes	6' *	6' *	10' *	
Mandela Way	Local	10'	One-Way	No	Yes	6' *	6' *	10' *	
Mandela Way	Local	10'	One-Way	No	Yes	6' *	6' *	10' *	
Bust Street (North of Mandala Way)	Local	10'	Two-Way	No	Yes	6' *	6' *	10' *	
Bust Street (North of St. Malachy)	Local	11'	One-Way	Yes	Yes	6' *	6' *	10' *	
Bust Street (South of St. Malachy)	Local	11'	Two-Way	Yes	Yes	7' *	7' *	12' *	

**KEY**  
 \* Meets Complete Streets Manual minimum requirements  
 \*\* Does not meet Complete Streets Manual minimum requirements

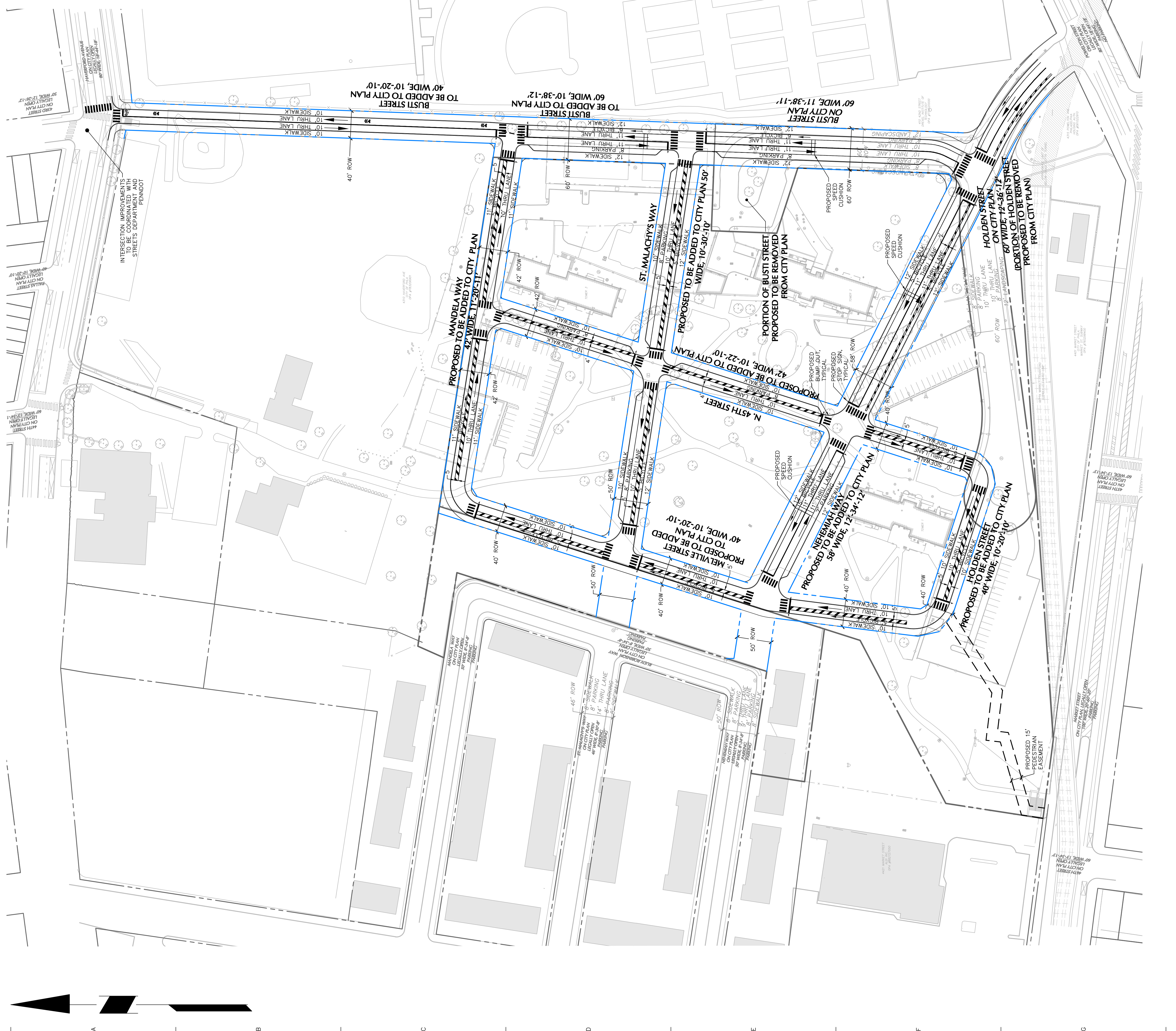
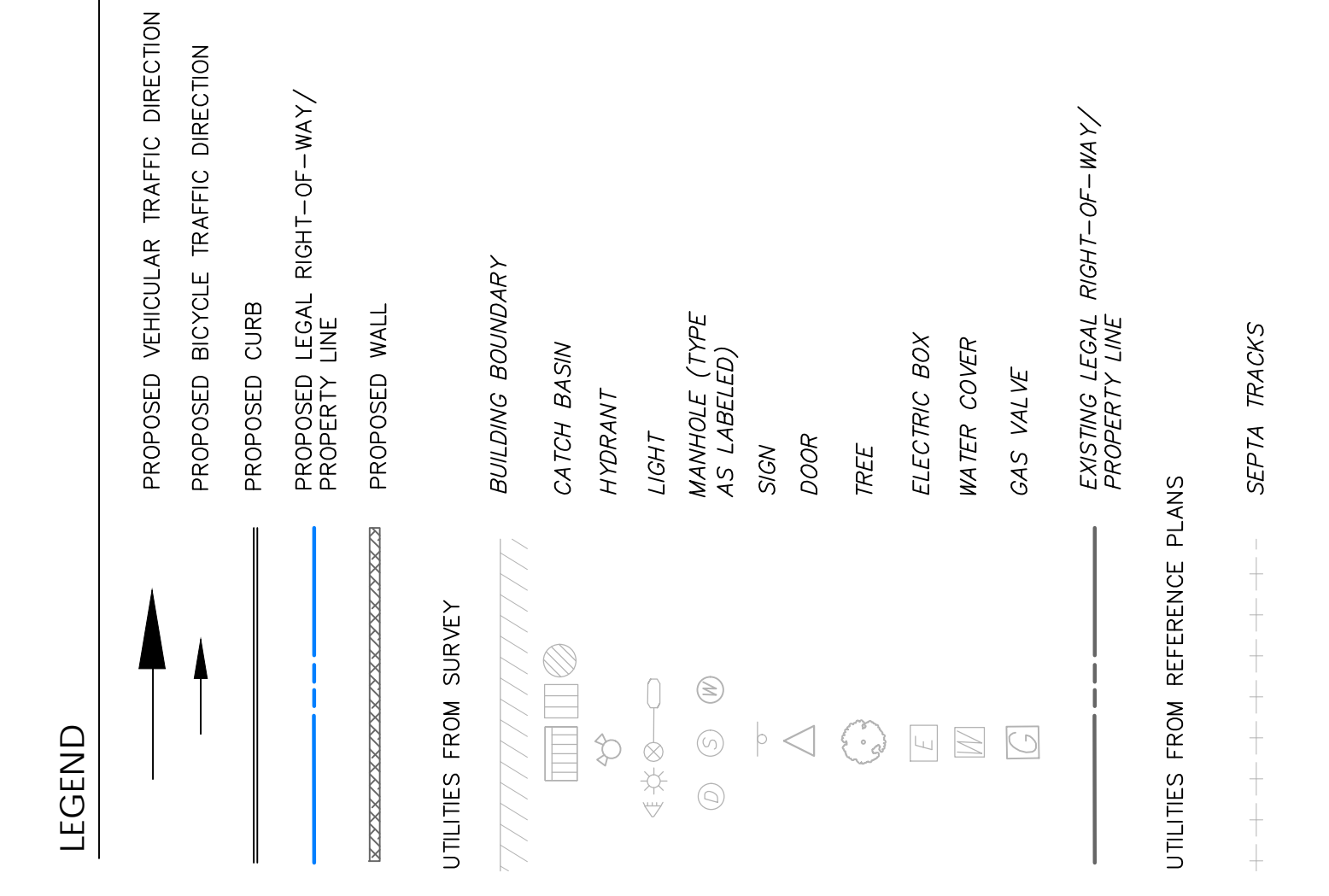

Date	Description	No.
	Revisions	

**9 NOVEMBER 2023**  
**PROGRESS PRINT**

**LANGAN**  
 Langan Engineering and  
 Environmental Services, Inc.  
 1818 Market Street, Suite 3300  
 Philadelphia, PA 19103  
 T: 215.846.8900 F: 215.846.8901 www.langan.com

**WESTPARK DEVELOPMENT**  
 PHILADELPHIA COUNTY PENNSYLVANIA  
**CONCEPT ROADWAY - NORTH CONNECTION**

Project No. 2201822801  
 Date 10/09/2023  
 Drawn By CS  
 Checked By JCW  
**FIG. 1B**

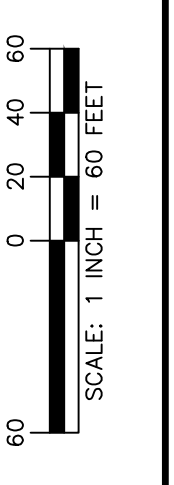



# City of Philadelphia

## City of Philadelphia

*BILL NO. 230852 continued*

Certified Copy

CERTIFICATION: This is a true and correct copy of the original Bill, Passed by the City Council on December 14, 2023. The Bill was Signed by the Mayor on December 20, 2023.

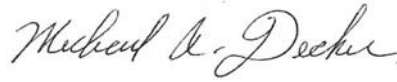

Michael A. Decker  
Chief Clerk of the City Council