

PROPOSED TO BE PLACED ON THE CITY PLAN RIVER ROAD (30' WIDE) FROM THE FORMER PORT ROYAL AVENUE TO A DISTANCE OF TEN FEET FROM THE COUNTY LINE

APPROXIMATE LOCATION OF 40' WIDE ROAD OPENED BY COURT OF QUARTER SESSIONS APPROVED APRIL 8, 1811 BASED ON PLAN OF PROPERTY MADE FOR EDWARD T. STOTESBURY, JR. AND WALTER M. SZAJNA BY FRANCIS X. BURNS, SURVEYOR AND REGULATOR, NINTH DISTRICT DATED NOVEMBER 8TH, 1985.

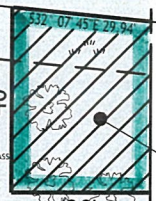

PROPOSED 30'X40' PARCEL TO BE SUBDIVIDED OUT FOR UTILITY PLACEMENT; PARCEL TO BE CONTIGUOUS WITH THE PROPOSED REVISED RIGHT-OF-WAY OF RIVER ROAD AND CONTIGUOUS WITH THE PROPERTY LINE OF #7 AND #8 RIVER ROAD

PARCEL ID 150N190080
10 RIVER ROAD

PARCEL ID 150N190127
EDWARD T. STOTESBURY, JR. AND JUDITH STOTESBURY, HIS WIFE
9-A RIVER ROAD
DOC. ID. 42512354
14,274.97 SQUARE FEET (DS)
(0.3277 ACRE)

PARCEL ID 150N190128
EDWARD T. STOTESBURY AND JUDITH A. STOTESBURY, HUSBAND AND WIFE
8 RIVER ROAD, UNIT 8A
DOC. ID. 51567358
14,325.00 SQUARE FEET (DS)
(0.3289 ACRE)

PARCEL ID 150N190090
7 RIVER ROAD

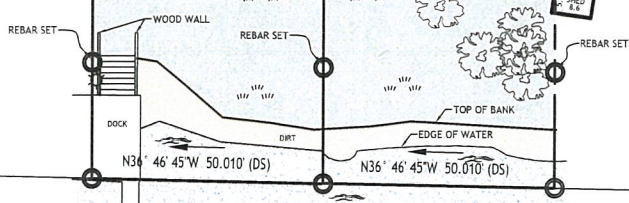
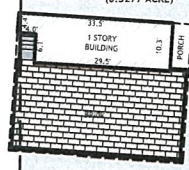

THE SCHUYLKILL RIVER

CITY OF PHILADELPHIA
PROPOSED SUBDIVISION
PLAN FOR 8 RIVER ROAD

