

City of Philadelphia



(Bill No. 060580)

AN ORDINANCE

To amend the Philadelphia Zoning Maps by changing the zoning designations of certain areas of land located within an area bounded by W. Coulter Street, Stokely Street, Midvale Avenue and McMichael Street.

THE COUNCIL OF THE CITY OF PHILADELPHIA HEREBY ORDAINS:

SECTION 1. Pursuant to Section 14-103 of The Philadelphia Code, The Philadelphia Zoning Maps are hereby amended by changing the zoning designations of certain areas of land within an area bounded by W. Coulter Street, Stokely Street, Midvale Avenue and McMichael Street from the existing zoning designations indicated on Map "A" set forth below to the zoning designations indicated on Map "B" set forth below.

SECTION 2. This Ordinance shall become effective immediately.

City of Philadelphia

BILL NO. 060580 continued

Certified Copy

MAP A EXISTING ZONING

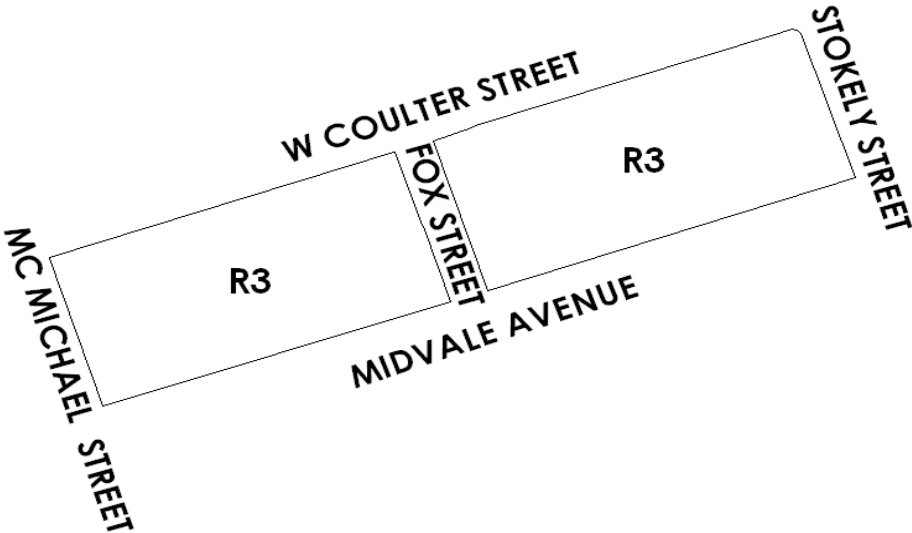

Legend

3 Residential R3

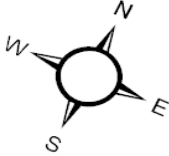

City of Philadelphia

BILL NO. 060580 continued

Certified Copy

MAP B PROPOSED ZONING

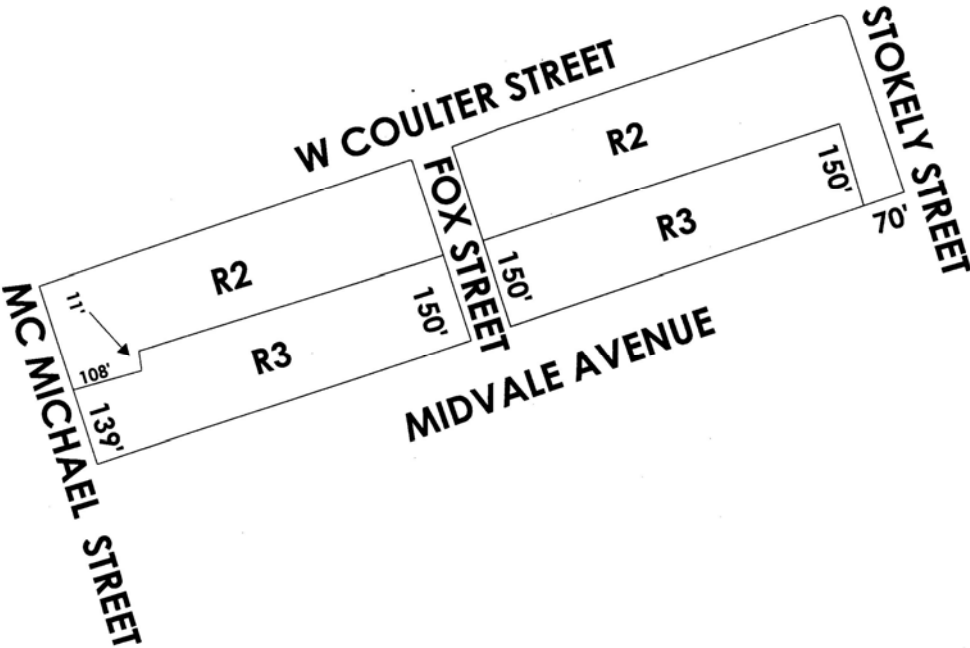

Legend

- 2 Residential R2
- 3 Residential R3



City of Philadelphia

BILL NO. 060580 continued

Certified Copy

CERTIFICATION: This is a true and correct copy of the original Bill, Passed by the City Council on December 14, 2006. The Bill was Signed by the Mayor on January 23, 2007.



Patricia Rafferty
Chief Clerk of the City Council