

City of Philadelphia



(Bill No. 140234)

AN ORDINANCE

To amend the Philadelphia Zoning Maps by changing the zoning designations of certain areas of land located within an area bounded by Dungan Road, Napfle Avenue, Railroad Right-of-Way, and Rhawn Street.

THE COUNCIL OF THE CITY OF PHILADELPHIA HEREBY ORDAINS:

SECTION 1. Pursuant to Section 14-106 of The Philadelphia Code, the Philadelphia Zoning Maps are hereby amended by changing the zoning designations of certain areas of land within an area bounded by Dungan Road, Napfle Avenue, Railroad Right-of-Way, and Rhawn Street, from the existing zoning designations indicated on Map "A" set forth below to the zoning designations indicated on Map "B" set forth below.

SECTION 2. This Ordinance shall become effective immediately.

MAP A - EXISTING ZONING

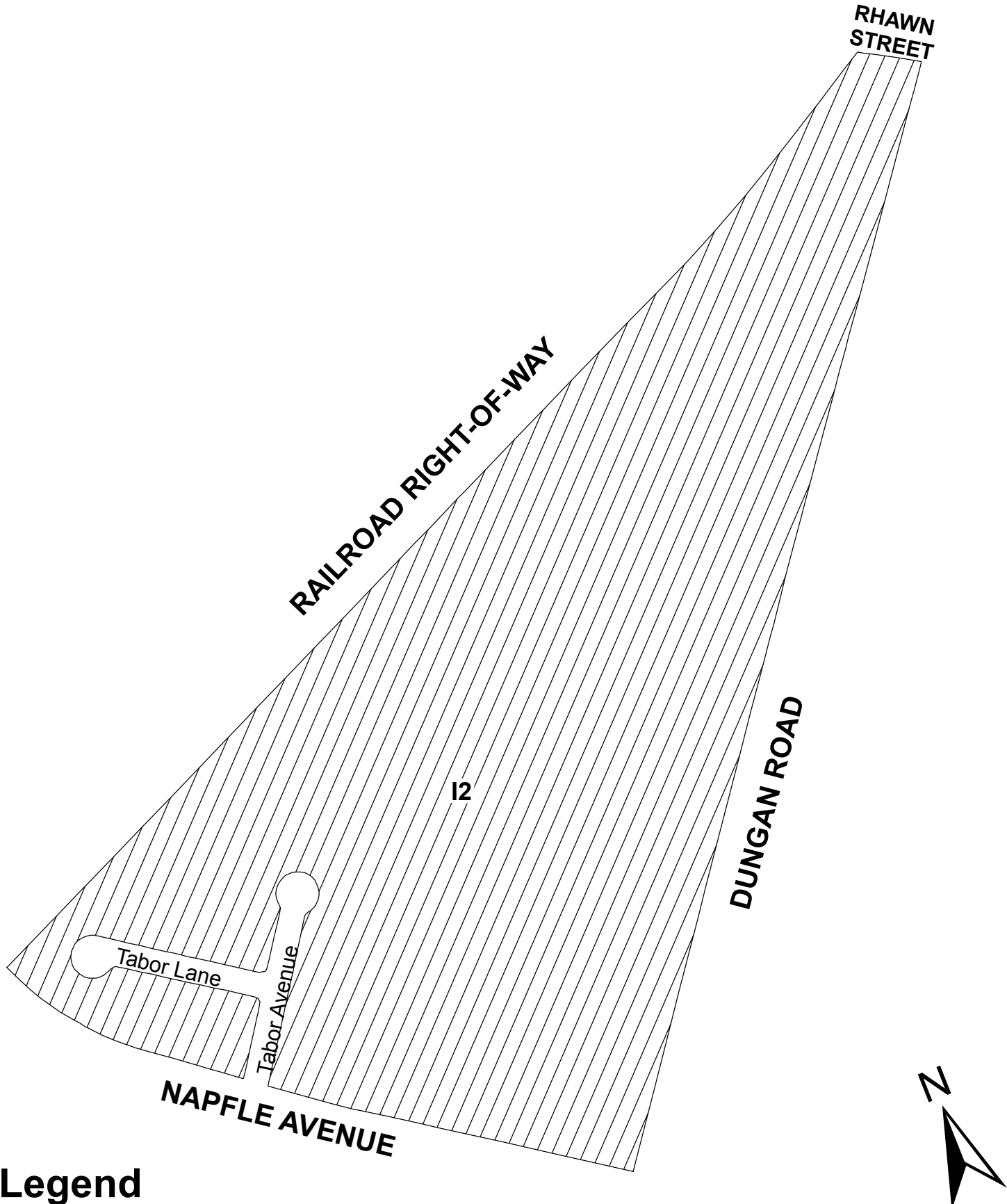

Legend

 I2 Industrial Medium

MAP B - PROPOSED ZONING

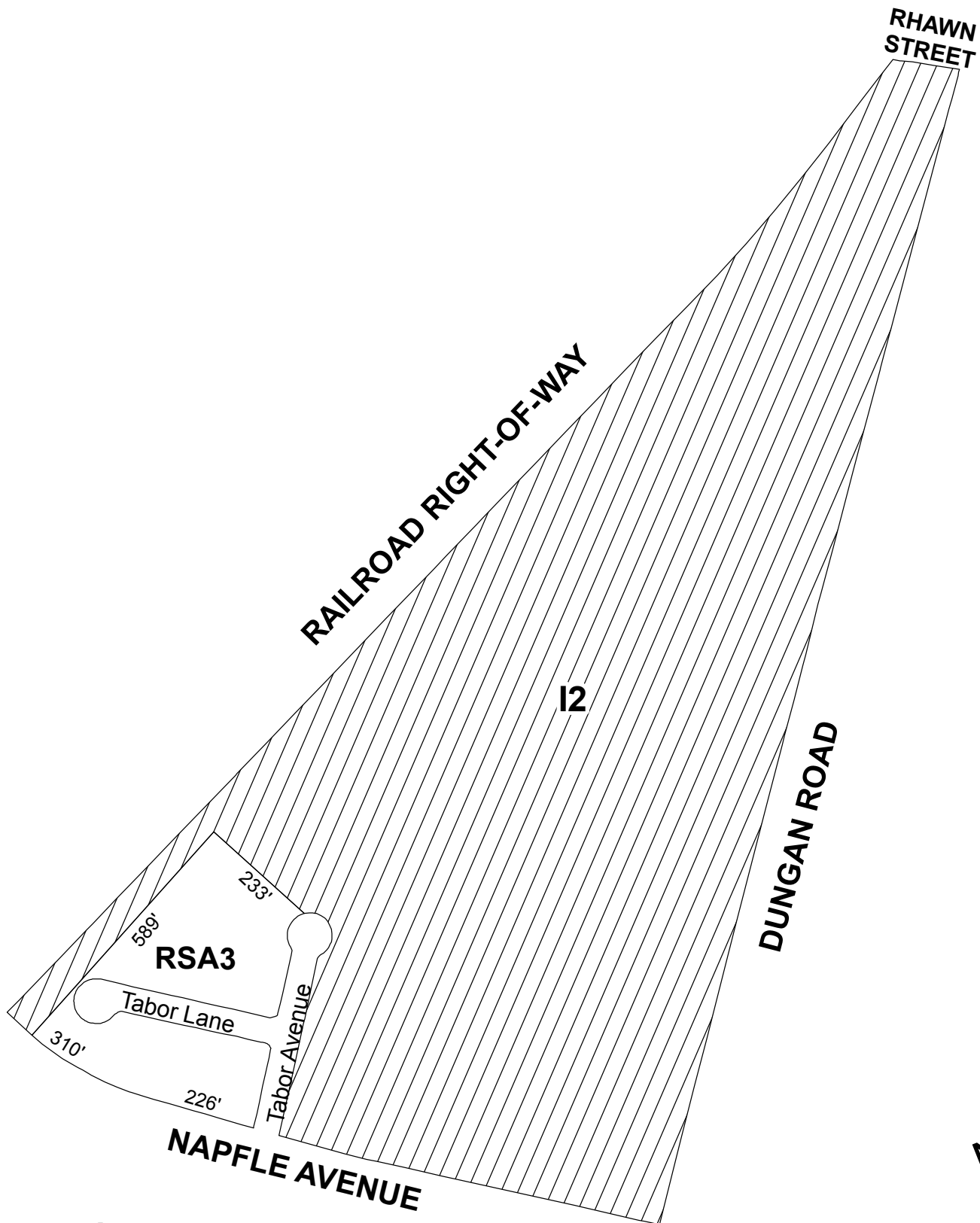

Legend

RSA3 RSA3 Residential Single Attached

I2 I2 Industrial Medium

City of Philadelphia

BILL NO. 140234 continued

Certified Copy

CERTIFICATION: This is a true and correct copy of the original Bill, Passed by the City Council on May 1, 2014. The Bill was Signed by the Mayor on May 14, 2014.

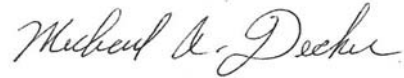

Michael A. Decker
Chief Clerk of the City Council