

City of Philadelphia



(Bill No. 080249)

AN ORDINANCE

To amend the Philadelphia Zoning Maps by changing the zoning designations of certain areas of land located within an area bounded by the County Line, a Railroad R.O.W., Shawmont Avenue and the Schuylkill River, and approving a Master Plan of Development.

THE COUNCIL OF THE CITY OF PHILADELPHIA HEREBY ORDAINS:

SECTION 1. Pursuant to Section 14-103 of The Philadelphia Code, The Philadelphia Zoning Maps are hereby amended by changing the zoning designations of certain areas of land within an area bounded by the County Line, a Railroad R.O.W., Shawmont Avenue and the Schuylkill River, from the existing zoning designations indicated on Map "A" set forth below to the zoning designations indicated on Map "B" set forth below.

SECTION 2. The "RC-6" Zoning designation requires the adoption of a Master Plan for the area in question. The Master Plan is attached as Exhibit A, and is hereby approved. A full size copy of the Master Plan will be kept on file and made available for review by the City Clerk's office during normal business hours.

MAP A EXISTING ZONING

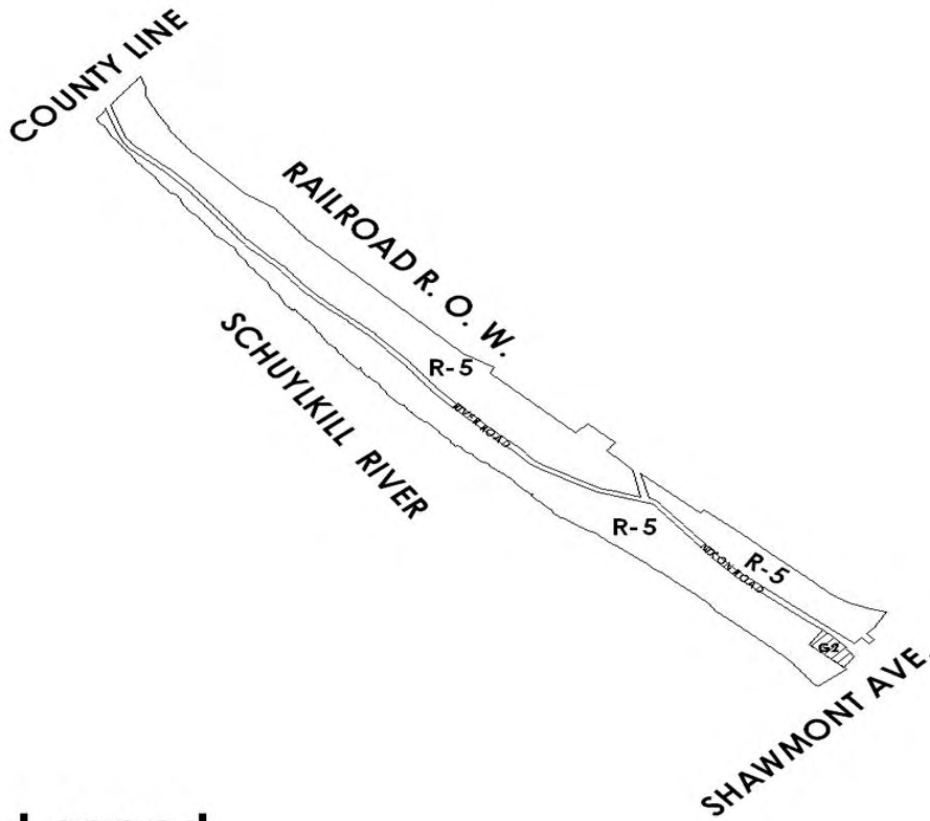

Legend

R5	Residential R5
G2	General Industrial G2



MAP B PROPOSED ZONING

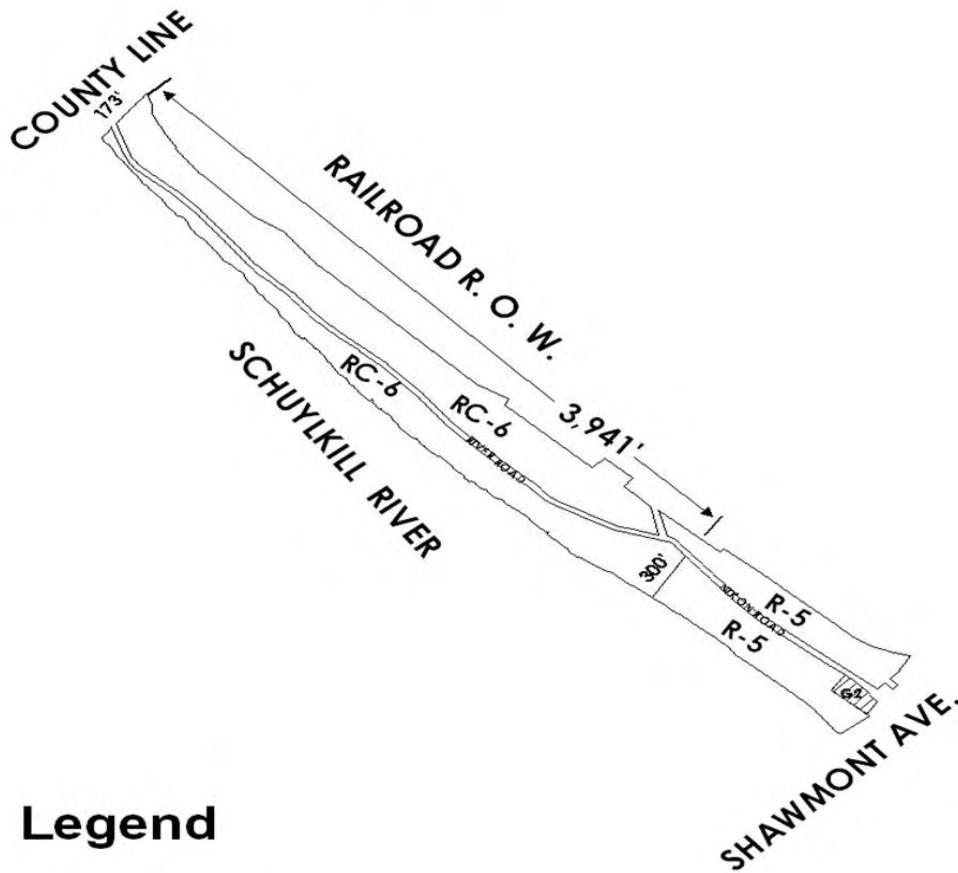

Legend

R5	Residential R5
RC6	Residential RC6
G2	General Industrial G2



River Road RC-6 Masterplan - PCPC Recommendations



City of Philadelphia

BILL NO. 080249, continued

Certified Copy

City of Philadelphia

BILL NO. 080249 continued

Certified Copy

CERTIFICATION: This is a true and correct copy of the original Bill, Passed by the City Council on June 19, 2008. The Bill was signed by the Mayor on July 15, 2008.



Patricia Rafferty
Chief Clerk of the City Council