

# City of Philadelphia



(Bill No. 180970)

## AN ORDINANCE

To amend the Philadelphia Zoning Maps by changing the zoning designations of certain areas of land located within an area bounded by the Delaware Expressway, Tolbut Street (extended), Torresdale Avenue and Pennypack Street (extended).

*THE COUNCIL OF THE CITY OF PHILADELPHIA HEREBY ORDAINS:*

SECTION 1. Pursuant to Section 14-106 of The Philadelphia Code, the Philadelphia Zoning Maps are hereby amended by changing the zoning designations of certain areas of land within an area bounded by the Delaware Expressway, Tolbut Street (extended), Torresdale Avenue and Pennypack Street (extended) from the existing zoning designations indicated on Map “A” set forth below to the zoning designations indicated on Map “B” set forth below.

SECTION 2. This Ordinance shall become effective immediately.

# Map A Existing Zoning

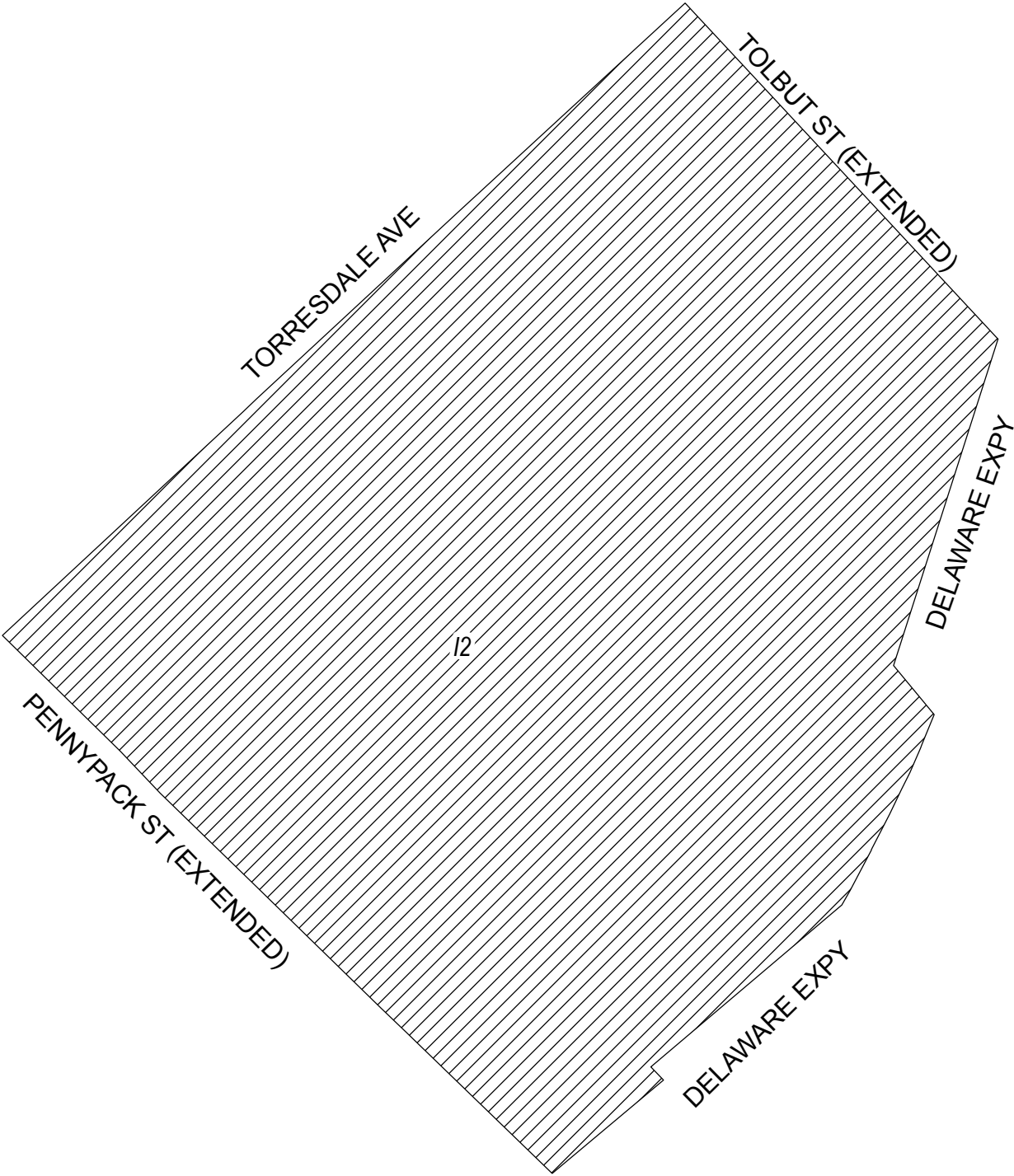

### Zoning Districts

 I-2 Medium Industrial



# Map B Proposed Zoning

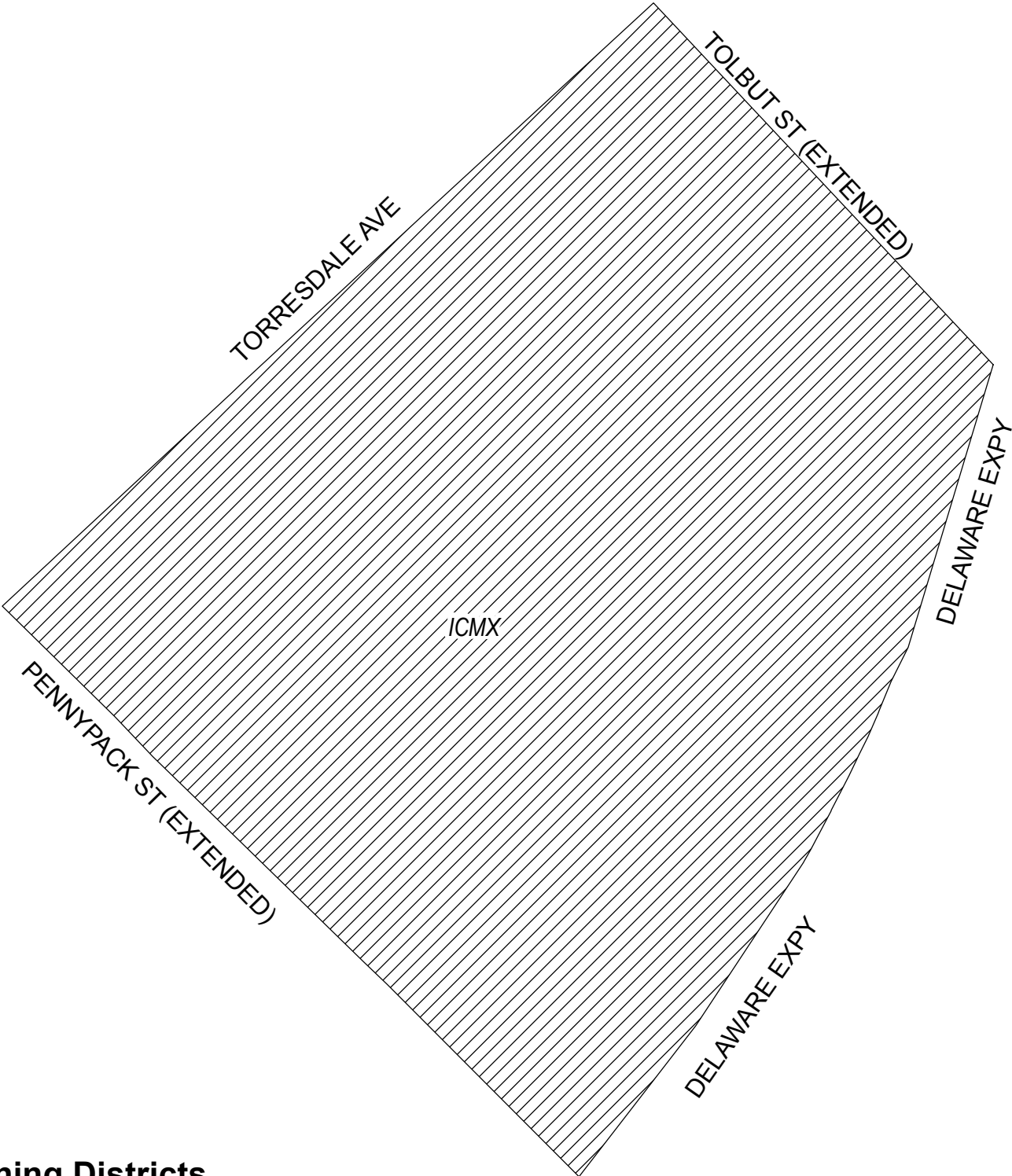

### Zoning Districts

 ICMX Industrial Commercial Mixed-Use



# City of Philadelphia

*BILL NO. 180970 continued*

Certified Copy

CERTIFICATION: This is a true and correct copy of the original Bill, Passed by the City Council on December 13, 2018. The Bill was Signed by the Mayor on January 03, 2019.



Michael A. Decker  
Chief Clerk of the City Council