

City of Philadelphia



(Bill No. 020345)

AN ORDINANCE

To amend the Philadelphia Zoning Maps by changing the zoning designations of certain areas of land located within an area bounded by Frankford avenue, Carteret drive, St. Denis drive, the Poquessing Creek, Grant avenue, Ditman street, Primrose road, Frankford avenue, Fidler street, Leon street and Grant avenue.

THE COUNCIL OF THE CITY OF PHILADELPHIA HEREBY ORDAINS:

SECTION 1. Pursuant to Section 14-103 of The Philadelphia Code, the Philadelphia Zoning Maps are hereby amended by changing the zoning designations of certain areas of land within an area bounded by Frankford avenue, Carteret drive, St. Denis drive, the Poquessing Creek, Grant avenue, Ditman street, Primrose road, Frankford avenue, Fidler street, Leon street and Grant avenue, from the existing zoning designations indicated on Map "A" set forth below to the zoning designations indicated on Map "B" set forth below.

SECTION 2. This Ordinance shall not become effective unless the sum of Two Hundred Dollars (\$200) towards costs thereof, is paid into the City Treasury within sixty (60) days after the approval of this Ordinance.

City of Philadelphia

BILL NO. 020345 continued

Certified Copy

MAP A - EXISTING ZONING MAP

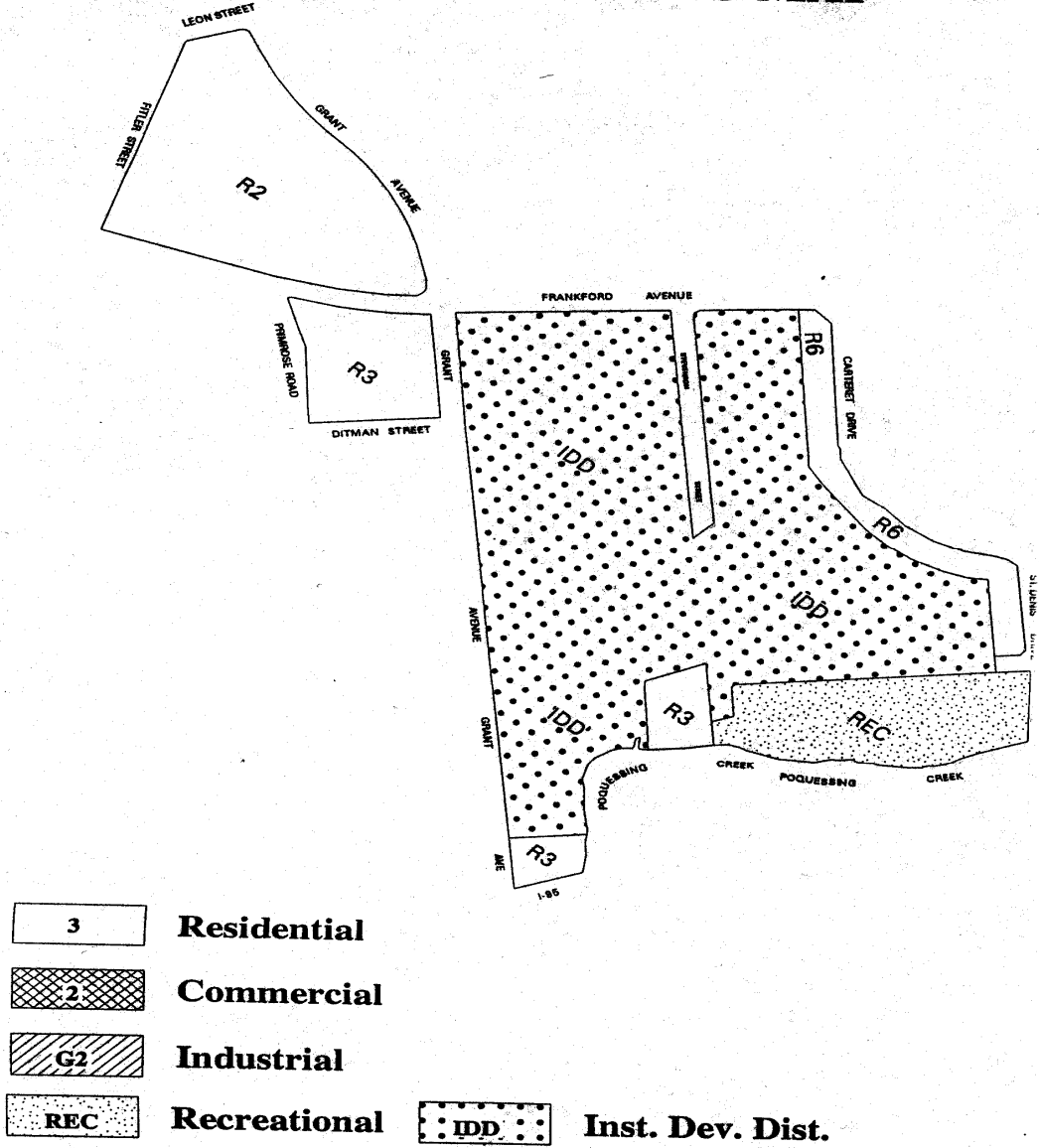

City of Philadelphia

BILL NO. 020345 continued

Certified Copy

MAP B - PROPOSED ZONING MAP

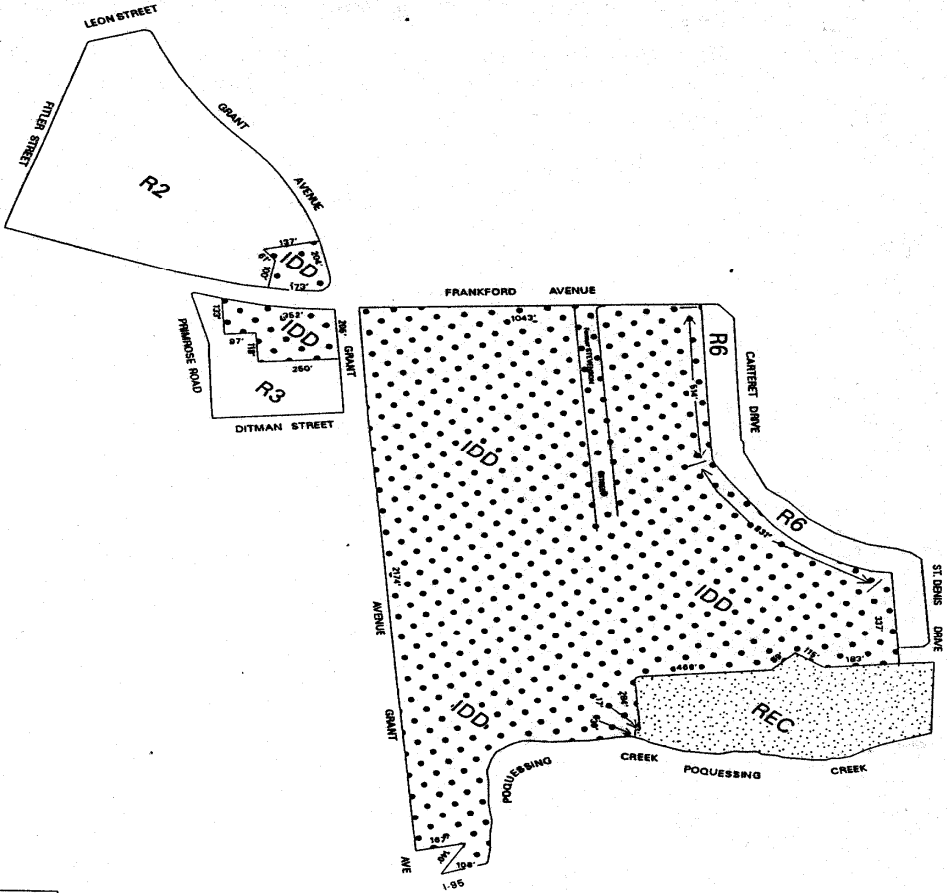

- 3 **Residential**
- 2 **Commercial**
- G2 **Industrial**
- REC **Recreational**
- IDD **Inst. Dev. Dist.**

City of Philadelphia

BILL NO. 020345 continued

Certified Copy

CERTIFICATION: This is a true and correct copy of the original Bill, Passed by the City Council on June 13, 2002. The Bill was Signed by the Mayor on September 6, 2002.



Marie B. Hauser
Chief Clerk of the City Council