

City of Philadelphia



Philadelphia, October 17, 2005

CERTIFICATION: This is to certify that Bill No. 050421 was presented to the Mayor on the twenty-ninth day of September, 2005, and was not returned to the Council with his signature at a meeting held October 17, 2005 (being more than ten days after it had been presented to him).

THEREFORE, Pursuant to the provisions of Section 2-202 of the Philadelphia Home Rule Charter, the ordinance becomes effective as if the Mayor had approved it.

A handwritten signature in cursive script that reads "Patricia Rafferty".

Patricia Rafferty
Chief Clerk of the City Council

(Bill No. 050421)

AN ORDINANCE

To amend the Philadelphia Zoning Maps by changing the zoning designations of certain areas of land located within an area bounded by Bluegrass Road, Grant Avenue, Ashton Road and Willits Road.

THE COUNCIL OF THE CITY OF PHILADELPHIA HEREBY ORDAINS:

SECTION 1. Pursuant to Section 14-103 of The Philadelphia Code, The Philadelphia Zoning Maps are hereby amended by changing the zoning designations of certain areas of land within an area bounded by Bluegrass Road, Grant Avenue, Ashton Road and Willits Road from the existing zoning designations indicated on Map "A" set forth below to the zoning designations indicated on Map "B" set forth below.

SECTION 2. This Ordinance shall not become effective unless the sum of Two Hundred Dollars (\$200) towards costs thereof, is paid into the City Treasury within sixty (60) days after the approval of this Ordinance.

City of Philadelphia

BILL NO. 050421 continued

Certified Copy

MAP A EXISTING ZONING

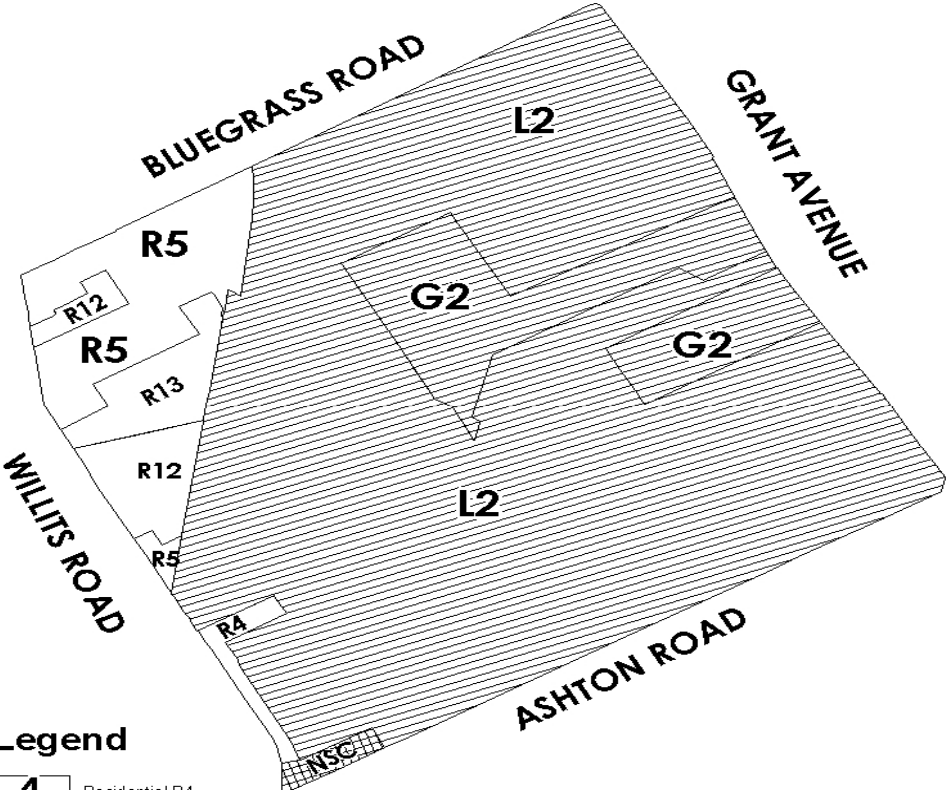

Legend

- 4** Residential R4
- 5** Residential R5
- 12** Residential R12
- 13** Residential R13
- NSC** Neighborhood Shopping Center NSC
- L2** Limited Industrial L2
- G2** General Industrial G2

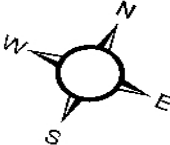

City of Philadelphia

BILL NO. 050421 continued

Certified Copy

MAP B PROPOSED ZONING

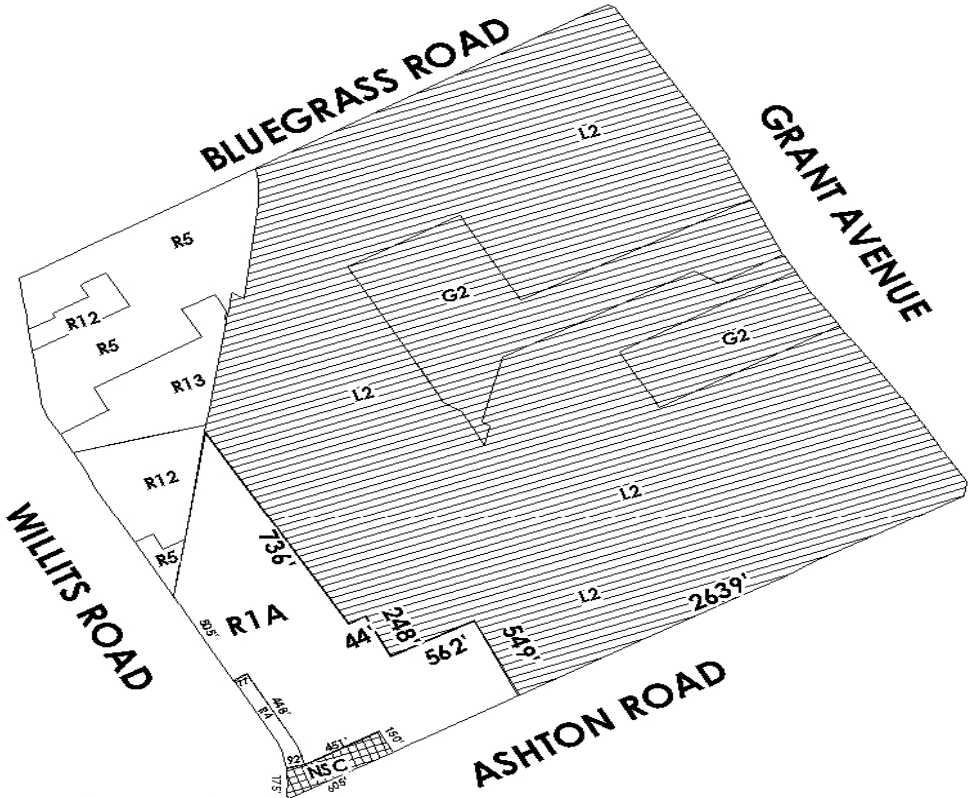

Legend

- 1A** Residential R1A
- 4** Residential R4
- 5** Residential R5
- 12** Residential R12
- 13** Residential R13
- NSC** Neighborhood Shopping Center NSC
- 2** Limited Industrial L2
- 2** General Industrial G2

