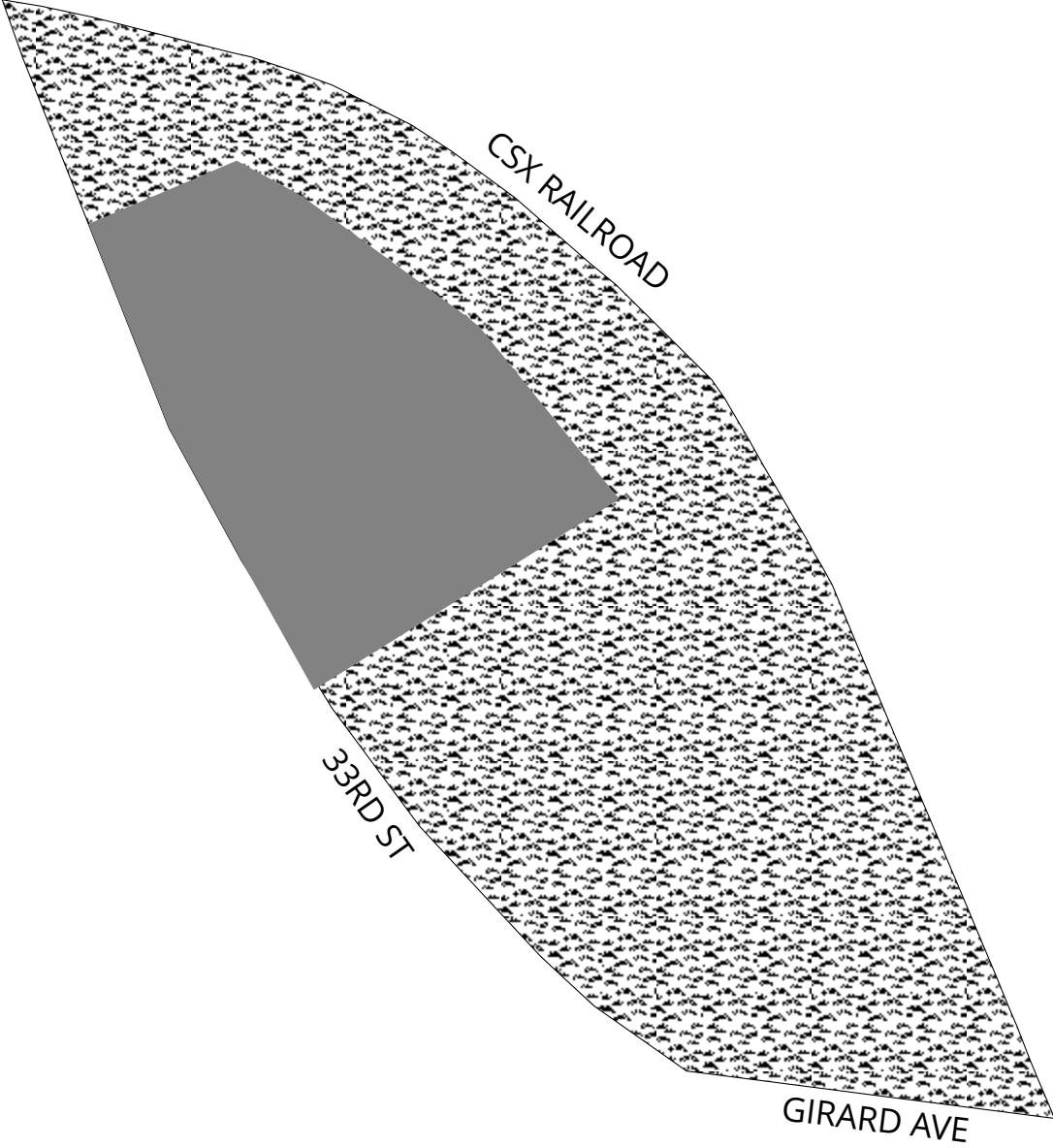

Exhibit A Locator Map



Zoning Districts



-  SP-PO-A, Parks and Open Space
-  Use Authorization Boundary



Exhibit C

LEGAL DESCRIPTION of Proposed Pump Station Area

All that certain parcel or tract of land being graphically shown on a plan prepared by Hunt Engineering Company entitled "Proposed Pump Station Area", dated November 19, 2019, last revised on April 26, 2022; located within the city of Philadelphia, Commonwealth of Pennsylvania. Said parcel of land being more particularly described as follows:

BEGINNING at a POINT on the eastern right of way of North 33rd Street, said point being South 74 degrees 35 minutes 16 seconds East, a distance of 2030.14 feet from a drill hole on the southeast corner of Girard Avenue and 28th Street set by the 9th District City Surveyor and Regulator;

Thence along the eastern right of way of North 33rd Street on a curve bearing to the right having a radius of 824.71 feet, an arc length of 212.60 feet, a central angle of 14 degrees 46 minutes 11 seconds, a chord bearing North 26 degrees 55 minutes 27 seconds West, and a chord distance of 212.01 feet to a point;

Thence along the same, North 19 degrees 30 minutes 56 seconds West, a distance of 77.71 feet to a point;

Thence through the lands of the Philadelphia Parks Department the following five (5) courses and distances;

- North 67 degrees 05 minutes 20 seconds East, a distance of 92.77 feet;
- South 59 degrees 54 minutes 51 seconds East, a distance of 40.91 feet;
- South 53 degrees 59 minutes 12 seconds East, a distance of 89.06 feet;
- South 48 degrees 02 minutes 51 seconds East, a distance of 51.40 feet;
- South 38 degrees 42 minutes 09 seconds East, a distance of 108.06 feet;

Thence continuing through the same, South 58 degrees 50 minutes 58 seconds West, a distance of 206.50 feet, to the **POINT of BEGINNING**.

Containing 1.08 acres in area.

The basis of bearings for the above being Grid North, as derived from the Pennsylvania State Plane Coordinate System (NAD83). All measurements being in Philadelphia District Standard Measure.