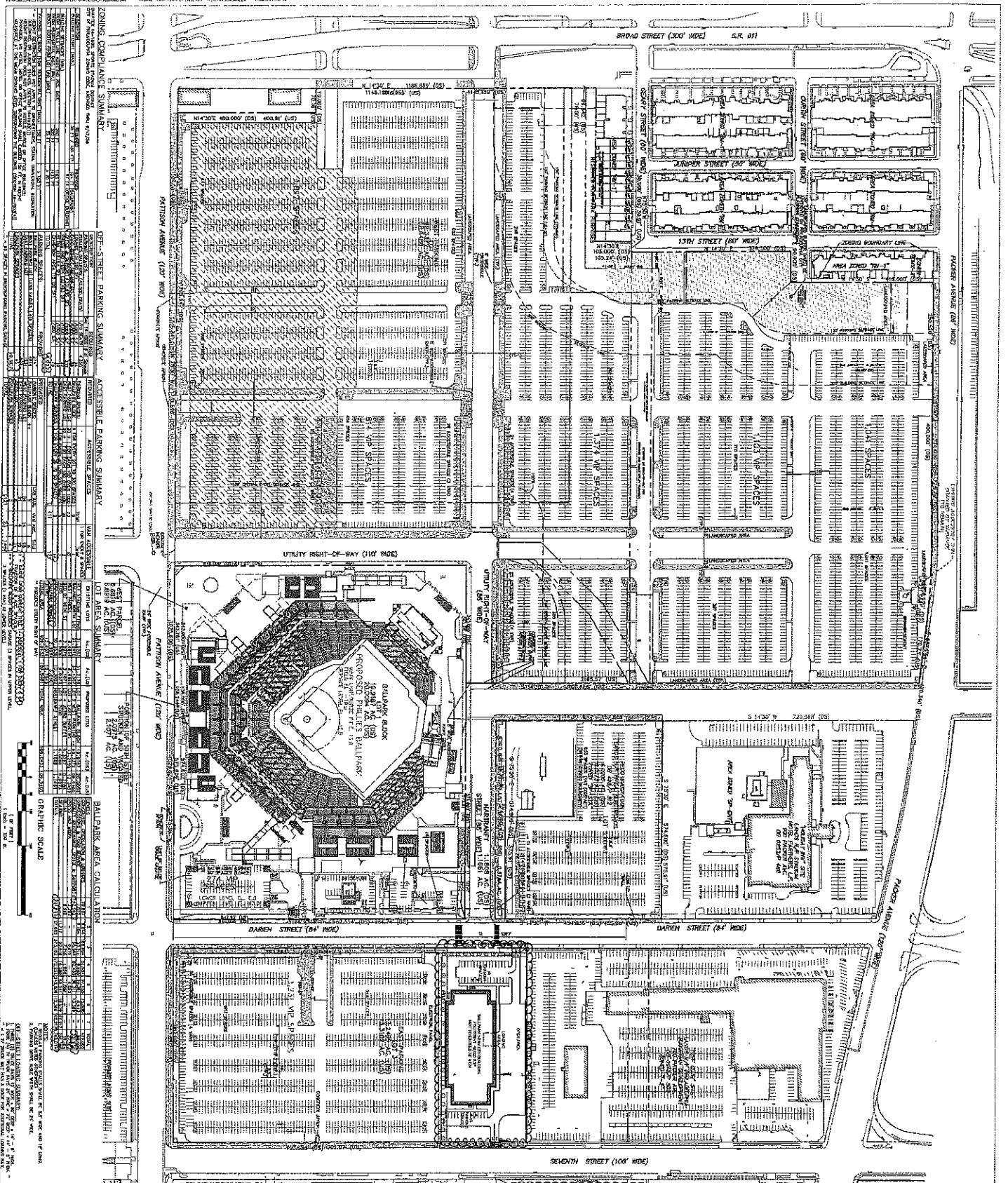

EXHIBIT "A"



ZONING COMPLIANCE SUMMARY

STREET PARKING SUMMARY

ACCESSIBLE PARKING SUMMARY

UTILITY RIGHT-OF-WAY (110' WIDE)

STADIUM AREA CALCULATION

GRAPHIC SCALE

GENERAL NOTES:

1. THIS PLAN IS A PRELIMINARY PLAN AND IS SUBJECT TO CHANGE WITHOUT NOTICE.

2. THE OWNER SHALL BE RESPONSIBLE FOR OBTAINING ALL NECESSARY PERMITS AND APPROVALS FROM THE APPROPRIATE AGENCIES.

3. THE OWNER SHALL BE RESPONSIBLE FOR OBTAINING ALL NECESSARY EASEMENTS AND RIGHTS-OF-WAY FROM THE APPROPRIATE OWNERS.

4. THE OWNER SHALL BE RESPONSIBLE FOR OBTAINING ALL NECESSARY UTILITIES AND SERVICES FROM THE APPROPRIATE PROVIDERS.

5. THE OWNER SHALL BE RESPONSIBLE FOR OBTAINING ALL NECESSARY INSURANCE AND BONDING.

6. THE OWNER SHALL BE RESPONSIBLE FOR OBTAINING ALL NECESSARY CONTRACTS AND AGREEMENTS FROM THE APPROPRIATE VENDORS.

7. THE OWNER SHALL BE RESPONSIBLE FOR OBTAINING ALL NECESSARY PROFESSIONAL SERVICES FROM THE APPROPRIATE PROVIDERS.

8. THE OWNER SHALL BE RESPONSIBLE FOR OBTAINING ALL NECESSARY FINANCING AND FUNDING.

9. THE OWNER SHALL BE RESPONSIBLE FOR OBTAINING ALL NECESSARY LEGAL AND TAX ADVICE.

10. THE OWNER SHALL BE RESPONSIBLE FOR OBTAINING ALL NECESSARY COMMUNITY AND PUBLIC INPUT.

LEGEND

STADIUM

PARKING

UTILITIES

EASEMENTS

STREETS

LANDSCAPE

ACCESSIBLE

GENERAL

CD C2-01

ZONING PERMIT PLAN

2017 MASTER PLAN AMENDMENT

PHILLIES

NEW BALLPARK PHILADELPHIA, PA

ROCKSOLID PARTNERS, LLC

Penonri

GENERAL NOTES:

1. THIS PLAN IS A PRELIMINARY PLAN AND IS SUBJECT TO CHANGE WITHOUT NOTICE.

2. THE OWNER SHALL BE RESPONSIBLE FOR OBTAINING ALL NECESSARY PERMITS AND APPROVALS FROM THE APPROPRIATE AGENCIES.

3. THE OWNER SHALL BE RESPONSIBLE FOR OBTAINING ALL NECESSARY EASEMENTS AND RIGHTS-OF-WAY FROM THE APPROPRIATE OWNERS.

4. THE OWNER SHALL BE RESPONSIBLE FOR OBTAINING ALL NECESSARY UTILITIES AND SERVICES FROM THE APPROPRIATE PROVIDERS.

5. THE OWNER SHALL BE RESPONSIBLE FOR OBTAINING ALL NECESSARY INSURANCE AND BONDING.

6. THE OWNER SHALL BE RESPONSIBLE FOR OBTAINING ALL NECESSARY CONTRACTS AND AGREEMENTS FROM THE APPROPRIATE VENDORS.

7. THE OWNER SHALL BE RESPONSIBLE FOR OBTAINING ALL NECESSARY PROFESSIONAL SERVICES FROM THE APPROPRIATE PROVIDERS.

8. THE OWNER SHALL BE RESPONSIBLE FOR OBTAINING ALL NECESSARY FINANCING AND FUNDING.

9. THE OWNER SHALL BE RESPONSIBLE FOR OBTAINING ALL NECESSARY LEGAL AND TAX ADVICE.

10. THE OWNER SHALL BE RESPONSIBLE FOR OBTAINING ALL NECESSARY COMMUNITY AND PUBLIC INPUT.

City of Philadelphia
Economic Opportunity Plan
Ballpark Services Building

Table of Contents

I. Introduction and Definitions.....	3
II. Project Scope.....	3
III. Goals.....	3
IV. Equity Ownership.....	4
V. Diversity Practices.....	5
VI. Responsiveness.....	6
VII. Compliance and Monitoring of Best and Good Faith Efforts.....	7
VIII. Remedies and Penalties for Non-Compliance.....	8

I. Introduction and Definitions

The City of Philadelphia strongly encourages the use of certified Minority ("MBE"), Women ("WBE"), Disabled ("DSBE") and Disadvantaged ("DBEs") Business Enterprises (collectively, "M/W/DSBEs") and minority and female workers in all aspects of the Ballpark Services Building (the "Project") located at 3300 S. 7th Street, Phila. PA 19148 ("the Site") which may include financial investment, design, construction, and operations.¹ In support of this objective, the City of Philadelphia will require that The Phillies (the "Owner") commit to this Economic Opportunity Plan ("EOP" or "Plan"). This Plan contains ranges of projected M/W/DSBE utilization and goals for the employment of minority and female workers in connection with the Project at the Site. This Plan shall be a part of and incorporated into the resulting agreement(s) with the owners of the Ballpark Services Building.

The Owner hereby verifies that all information submitted to the Office of Economic Opportunity ("OEO") in response to this Plan is true and correct and takes notice that the submission of false information is subject to the penalties of 18 PA C. S. Section 4904, relating to unsworn falsification to authorities and 18 PA C. S. Section 4107.2 (a)(4), relating to fraud in connection with minority business enterprises or women's business enterprises.

For the purposes of this Plan, MBE, WBE, DBE and DSBE shall refer to certified businesses so recognized by OEO. Only the work or supply efforts of firms that are certified as M/W/DSBEs by an OEO-approved certifying agency will be eligible to receive credit as a Best and Good Faith Effort.² In order to be counted, certified firms must successfully complete and submit to the OEO an application to be included in the OEO Registry which is a list of registered M/W/DSBEs maintained by the OEO and available online at www.phila.gov/oEO/directory.

For this Plan, the term "Best and Good Faith Efforts," the sufficiency of which shall be in the sole determination of the City, means: efforts, the scope, intensity and appropriateness of which are designed and performed to foster meaningful and representative opportunities for participation by M/W/DSBEs and an appropriately diverse workforce and to achieve the objectives herein stated. Best and Good Faith Efforts are rebuttably presumed met when commitments are made within the M/W/DSBE participation ranges established for the Project and a commitment is made to employ a diverse workforce as enumerated herein.

II. Project Scope

The demolition of an existing building and construction of a replacement building to provide accessory storage and office space in support of Citizens Bank Park.

III. Goals

A. M/W/DSBE Participation Ranges

As a benchmark for the expression of "Best and Good Faith Efforts" to provide meaningful and representative opportunities for M/W/DSBEs in the Project, the following participation ranges have been established. These participation ranges represent, in the absence of discrimination in the solicitation and selection of M/W/DSBEs, the percentage of MBE, WBE and DSBE participation that is reasonably attainable through the exercise of Best and Good Faith Efforts. These percentages relate to the good faith

¹ Disadvantaged Business Enterprises ("DBEs") are those socially or economically disadvantaged minority and woman owned businesses certified under 49 C.F.R. Part 26.

² A list of "OEO approved certifying agencies" can be found at www.phila.gov/oEO

estimated cost of the entire Project. In order to maximize opportunities for as many businesses as possible, a firm that is certified in two or more categories (e.g., MBE and WBE and DSBE or WBE and DSBE) will only be credited toward one participation range as either an MBE or WBE or DSBE. The ranges are based upon an analysis of factors such as the size and scope of the Project and the availability of MBEs, WBEs, and DSBEs to participate in this development.

The following contract goals have been set for the Project:

Contracts	Minority Owned	Female Owned	DSBE	Total
Demolition/ Construction	20-25%	15-20%	BGFE	35-45%

B. Employment Goals

The Owner agrees to exhaust its Best and Good Faith Efforts to employ minority persons, by race and ethnicity, and females in its workforce of apprentices and journeypersons at the following levels:

African American journeypersons: 22% of all journey hours worked across all trades
 Asian journeypersons: 3% of all journey hours worked across all trades
 Hispanic journeypersons: 15% of all journey hours worked across all trades
 Female journeypersons: 5% of all journey hours worked across all trades

Minority apprentices: 50% of all hours worked by all apprentices
 Female apprentices: 5% of all hours worked by all apprentices

Local Residents
32%

The Owner will be required to submit to the City, no later than seven (7) days before the starting date of work on any such contract, a Workforce Diversity Goal Plan which shall include specific availability and utilization strategies for meeting the Workforce Diversity goals. The City's Labor Standards Unit shall have the responsibility of administering oversight of these Workforce Diversity Goals including evaluating the sufficiency of the Workforce Diversity Goal Plan, and monitoring the successful Bidder's Best and Good Faith Efforts towards realization of the goals throughout the duration of the contract.

IV. Equity Ownership

The Philadelphia Code 17-1603 requires that each Economic Opportunity Plan include information concerning the Equity Ownership (as defined) of (1) the contractor, developer and/or recipient of financial assistance required to submit the Plan; (2) participants (as defined) engaged by the contractor, developer and/or recipient of financial assistance; and (3) the eventual owner or owners of the project or contract to which the Plan relates; and requiring periodic reports for the purpose of updating Equity Ownership information; all under certain terms and conditions.

Identify the current equity owners of the project.

Type of Ownership	% Minority Owned	% Women-Owned	% Disabled Persons
Sole Proprietorship			
Partnership	0%	0%	0%
Corporation			

If the project is privately owned, the following individuals will become the anticipated Equity Owners upon completion.

Type of Ownership	% Minority Owned	% Women-Owned	% Disabled Persons
Sole Proprietorship			
Partnership	0%	0%	0%
Corporation			

Following the completion of the project, the project owner is responsible for meeting the reporting guideline identified in the Philadelphia Code.³

V. Diversity Practices

In compliance with Chapter 17-1603, the Economic Opportunity Plan shall contain a statement from the contractor, developer, and/or recipient of financial assistance summarizing past practices by identifying and describing examples of processes used to develop diversity at any/all levels of its organization including, but not limited to, Board and managerial positions. This statement shall also summarize strategic business plans specific to current or past practices of M/W/DSBE utilization on government and non-government projects and procurement.

1. Describe employment and recruitment policies used to achieve diversity in your workforce.

As described in our organization's Diversity Plan, "The Phillies supports and offers a welcoming environment to all employees, suppliers and fans and respects and honors individual and cultural differences as an enriching part of its organizations culture." In support of MLB's investment in diversity and inclusion efforts, our organization continues to be creative in supporting diversity recruitment and hiring both league-wide and in the local market. We have increased the pool of candidates for consideration at almost every level of the organization in the last few years. We have attended all MLB Diversity Business Summits and continue to invest locally in HS, college and corporate job fairs, career days and other professional development opportunities to search for new relationships and employees. Our second annual College Night series, which we host at the ballpark, has also allowed Delaware Valley students unique access to our professionals working

³ Per The Philadelphia Code 17-1603: *Continuing Reporting Requirements*.

(i) Within 30 days of each anniversary of the date that the Plan is finally certified, the contractor, developer and/or recipient of financial assistance shall file with the Chief Clerk of Council and the certifying agency an addendum to the original Plan that provides the Equity Ownership information required in subsection (g)(.2), updated so that it is accurate as of the anniversary date. This requirement shall continue until the project is completed.

(ii) The final EOP report required pursuant to § 17-1604(2)(a) shall include updated Equity Ownership information that is accurate as of the date of the final report.

(iii) After the final EOP report has been filed, the owner or owners of the completed project shall have a continuing obligation to file a Statement of the owner's or owners' Equity Ownership within 30 days of each anniversary of the date that the final EOP report is submitted. The Statement shall be accurate as of the relevant anniversary date, and shall be filed with the Chief Clerk of Council and the certifying agency. No Statement shall be required if the completed project is not privately-owned.

in the industry, and in turn created a system of networking that has directly resulted in several outstanding new employees. Coupled with new employee resources and a generous budget to foster these efforts, our Club continues to broaden the scope of relationships in the community. Growing our own network of friends in business, The Phillies take pride that our relationships that begin at home in our front office extends well beyond the playing field to a network of partners. We remain engaged to all efforts to achieve diversity that align with complementing our family environment and creating a more diverse workforce both in the front office and on the field.

2. Provide the race, gender, and residential (local) status of your:

A. Directors	The Phillies ownership is a limited partnership. The General Partner is a White male, non-Philadelphia resident.
B. Management	The Officers include 10 White males and 2 White females, 2 of whom are Philadelphia residents.
C. General Workforce	Approximately: 2,638 White, 333 Minorities; 601 female, 2,370 male; and 499 Philadelphia residents.

3. Identify your organization's methods of solicitation and utilization of Minority, Woman and Disabled Businesses (M/W/DSBEs). Please be specific in describing outreach and any procurement policies that are focused on creating or sustaining business relationships with M/W/DSBEs.

We have a decentralized purchasing system. We endeavor to make our department heads aware of minority and women-owner vendors and suppliers and make clear in our Diversity Plan that the organization is "committed to diversity in its procurement of goods and services" and that it "seeks and welcomes a broad and diverse pool of vendors, contractors and professional service providers that are competitive in quality, service and price." We have a multifaceted approach to seeking out vendors. Some avenues include attending the Major League Baseball Diversity Summit held each year, accessing their portal which serves as a resource for M/W/DSBEs, and participating in local organizations such as WBEC. We also include the non-discrimination provisions in our construction and in other contracts.

4. What percentage of your company's total spend with vendors and suppliers is attributable to M/W/DSBEs? Please include a list of the largest M/W/DSBEs used by your organization in the last 12 months.

Approximately 8%. See list below. It is not known if any of them are in the OEO Registry

Empresa Constructora Construction Contractor \$898,062, Sky Tower Constructora Y Finan Construction Contractor \$618,392, Mella, Jose Architect \$495,576, Herrera, Martin Landlord \$458,500, Milray Foods Foodservice Company \$324,771, Aumar Food Service, C.A. Foodservice Company \$125,043, Holiday Inn Express & Suites Hotel \$124,167, Headrick, Rizik, Alvarez Law Firm \$99,543, PTM Sport Tee shirts/Promo items \$90,000, Crown Foods Foodservice Company \$80,973

5. Describe any initiatives made by your organization to increase investment and promote equity ownership by minorities and women.

VI. Responsiveness

A. The owner shall identify M/W/DSBE commitments and other agreements evidencing their intent to use Best and Good Faith efforts to employ minority persons and females at the levels stated herein. The

identified commitments constitute a representation that the M/W/DSBE is capable of providing commercially useful goods or services relevant to the commitments and that the Owner has entered into legally binding commitments or other legally binding agreements with the listed M/W/DSBEs for the work or supply effort described and the dollar/percentage amounts set forth. In calculating the percentage of M/W/DSBE participation, the standard mathematical rules apply in rounding off numbers. In the event of inconsistency between the dollar and percentage amounts listed on the form, the percentage will govern.

B. M/W/DSBE commitments are to be memorialized in a written subcontract agreement. Letters of intent, quotations, contracts, subcontracts and any other documents evidencing commitments with M/W/DSBEs become part of and an exhibit to the Agreement resulting from the RFP.

C. OEO will review the owner's commitments for the purpose of determining whether Best and Good Faith Efforts have been made. OEO reserves the right to request further documentation and/or clarifying information at any time during the construction and development of the Project.

VII. Compliance and Monitoring of Best and Good Faith Efforts

A. The owner agrees to cooperate with OEO in its compliance monitoring efforts, and to submit, upon the request of OEO, documentation relative to its implementation of the Plan, including the items described below:

- Copies of signed contracts and purchase orders with M/W/DSBE subcontractors
- Evidence of payments (cancelled checks, invoices, etc.) to subcontractors and suppliers to verify participation; and
- Telephone logs and correspondence relating to M/W/DSBE commitments.
- To the extent required by law, the Owner shall ensure that its on-site contractors maintain certified payrolls which include a breakout of hours worked by minority and female apprentices and journeypersons. These documents are subject to inspection by OEO.

B. Prompt Payment of M/W/DSBEs

The owner agrees and shall cause its contractors to ensure that M/W/DSBEs participating on the Project receive prompt payment for their work or supply effort within five (5) days after receipt of payment from the project owner.

C. Oversight Committee

For this Project, in the sole discretion of the City, an oversight committee may be established consisting of representatives from the Owner, representatives of the building trades, the construction manager, and the City which may include the Project site's district councilperson, OEO, and appropriate community organizations ("Committee"). The Committee will meet regularly to provide advice for the purpose of facilitating compliance with the Plan.

D. Reporting

The owner agrees to file an annual report with the City of Philadelphia and City Council concerning the performance of the Economic Opportunity Plan through the duration of the Project. In addition, during construction, the Owner will provide "snapshot" reports containing updates for certain categories of information contained in its annual report on a monthly basis during construction. Snapshot reporting will include: (i) utilization of M/W/DSBEs, and (ii) the hiring and employment of minorities and females. All

reports (quarterly & annually) provided to the City under this section will also be provided to the Office of Economic Opportunity.

VIII. Remedies and Penalties for Non-Compliance

A. The owner agrees that its compliance with the requirements of this Plan is material to the Agreement. Failure to comply with the Plan may constitute a substantial breach of the Agreement and is subject to the remedies and penalties contained therein or otherwise available at law or in equity. Notwithstanding the foregoing, no privity of contract exists between the City and any M/W/DSBE identified in any contract resulting from implementation of the Plan. Neither the Owner nor the City intends to give or confer upon any such M/W/DSBE any legal rights or remedies in connection with subcontracted services under any law or policy or by any reason of any contract resulting from implementation of the Plan except such rights or remedies that the M/W/DSBE may seek as a private cause of action under any legally binding contract to which it may be a party.

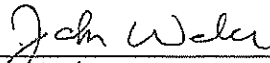
John Weber⁴
Vice President
Philadelphia Phillies

5/25/17
Date

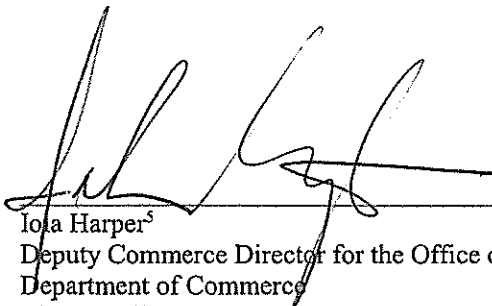
Iola Harper⁵
Deputy Commerce Director for the Office of Economic Opportunity
Department of Commerce
City of Philadelphia

5/26/17
Date

⁴ The Owner's Representative is required to sign and date, but the City reserves the right to obtain the Owner's Representative signature thereon at any time prior to Plan certification. The Owner Representative will receive from the City a certified copy of its Plan which should be filed with the Chief Clerk of City Council within fifteen (15) days of the issuance and published by OEO, in a downloadable format, on the OEO website.

⁵ Pursuant to Section 17-1603 (2) of The Philadelphia Code, the representative of the City of Philadelphia's Office of Economic Opportunity, the "certifying agency", certifies that the contents of this Plan are in compliance with Chapter 17-1600.