

# City of Philadelphia



(Bill No. 180385)

## AN ORDINANCE

To amend the Philadelphia Zoning Maps by changing the zoning designations of certain areas of land located within an area bounded by Ridge Avenue, Gorgas Lane (extended), Henry Avenue, Valley Avenue, and Domino Lane.

### *THE COUNCIL OF THE CITY OF PHILADELPHIA HEREBY ORDAINS:*

SECTION 1. Pursuant to Section 14-106 of The Philadelphia Code, the Philadelphia Zoning Maps are hereby amended by changing the zoning designations of certain areas of land within an area bounded by Ridge Avenue, Gorgas Lane (extended), Henry Avenue, Valley Avenue, and Domino Lane from the existing zoning designations indicated on Maps "A1," "A2," and "A3" set forth below to the zoning designations indicated on Maps "B1," "B2," and "B3" set forth below.

SECTION 2. This Ordinance shall become effective immediately.

# Map A1 Existing Zoning

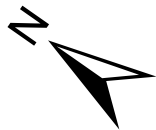
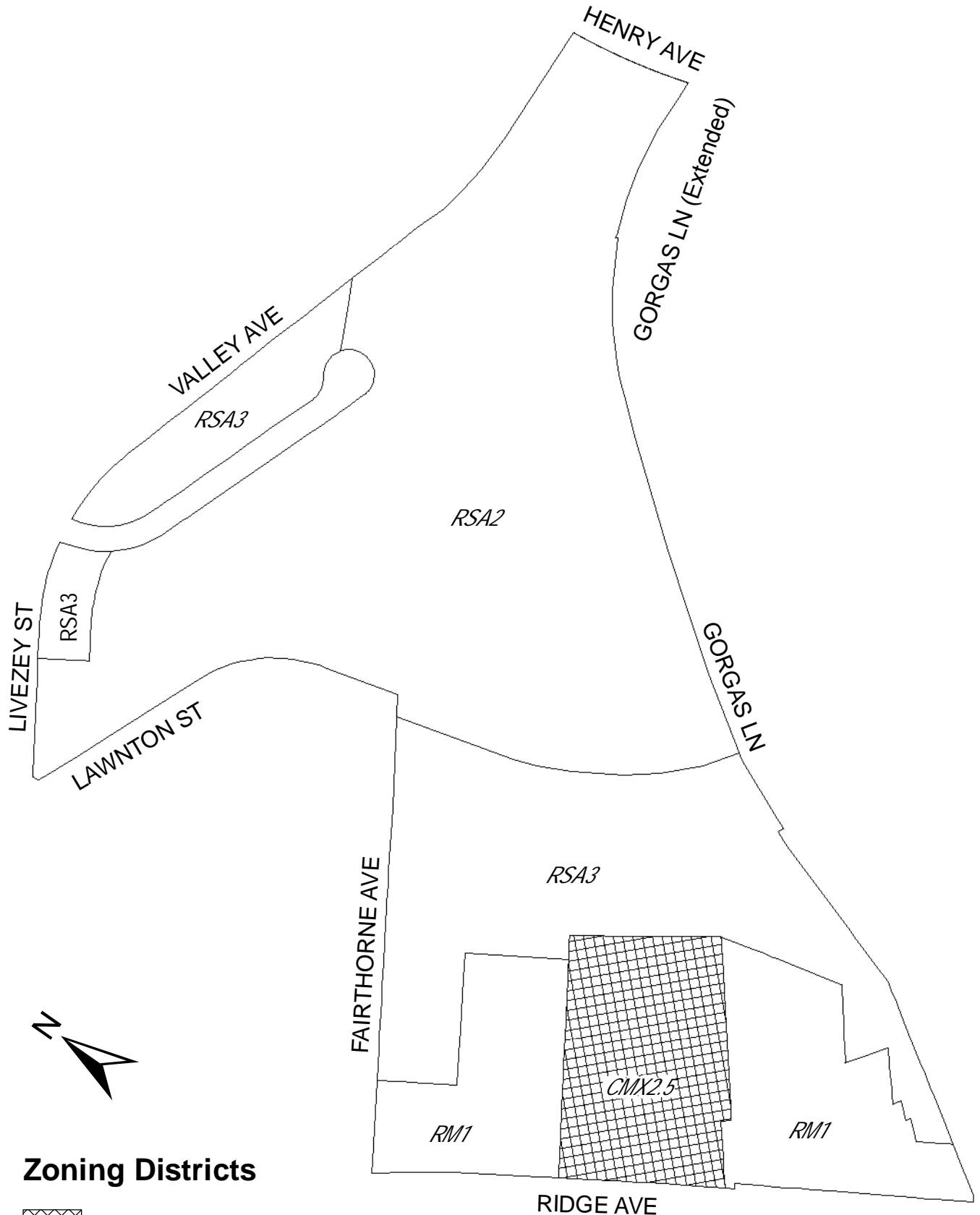

## Zoning Districts



CMX-2.5 Commercial Mixed-Use



RSA-2/RSA-3 Single-Family Attached Residential;  
RM-1 Multi-Family Residential

# Map A2 Existing Zoning

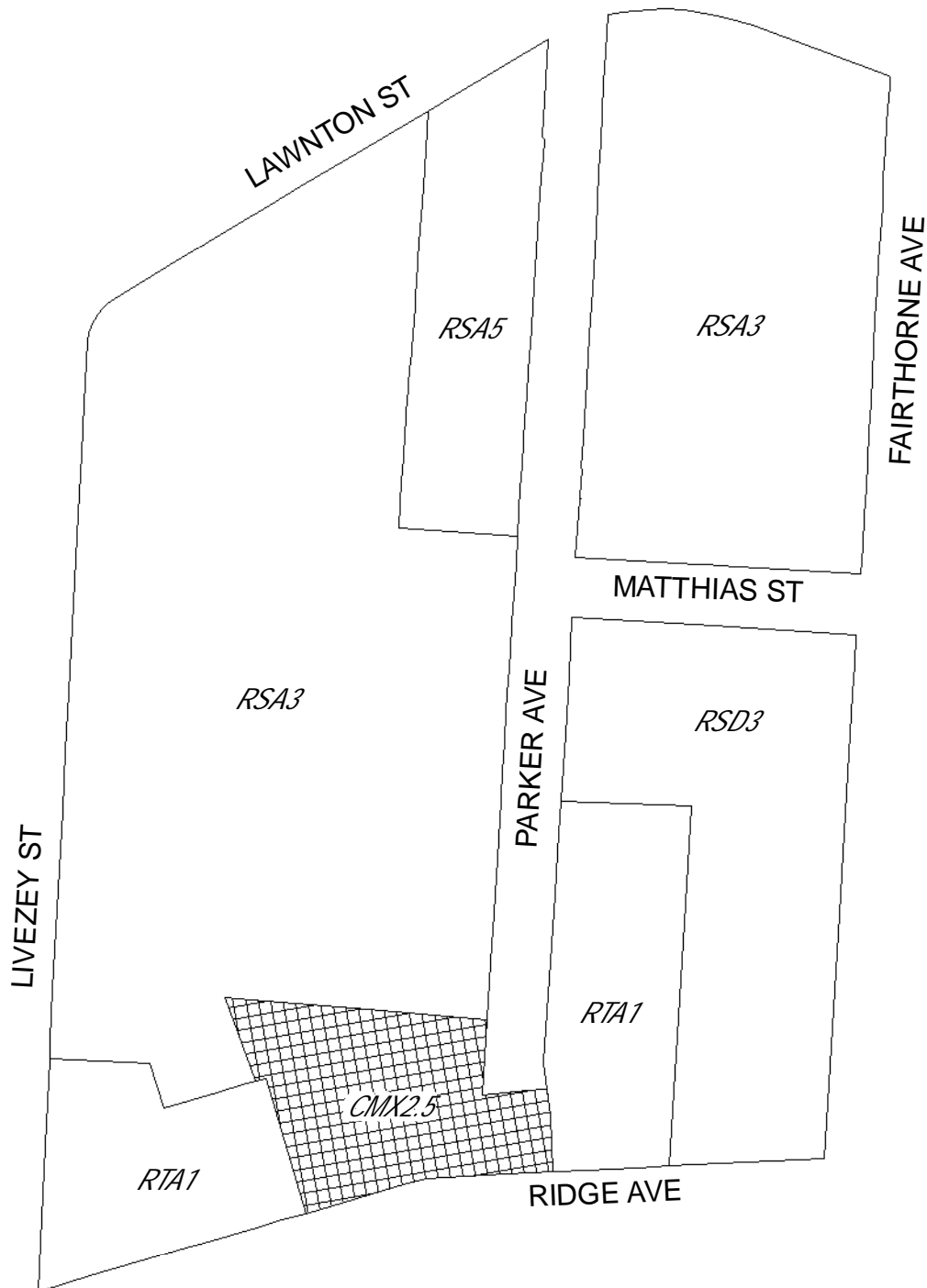

## Zoning Districts



CMX-2.5 Commercial Mixed-Use



RSD-3 Single-Family Detached Residential;  
 RSA-3/RSA-5 Single-Family Attached Residential;  
 RTA-1 Two-Family Attached Residential

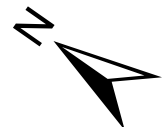

# Map A3 Existing Zoning

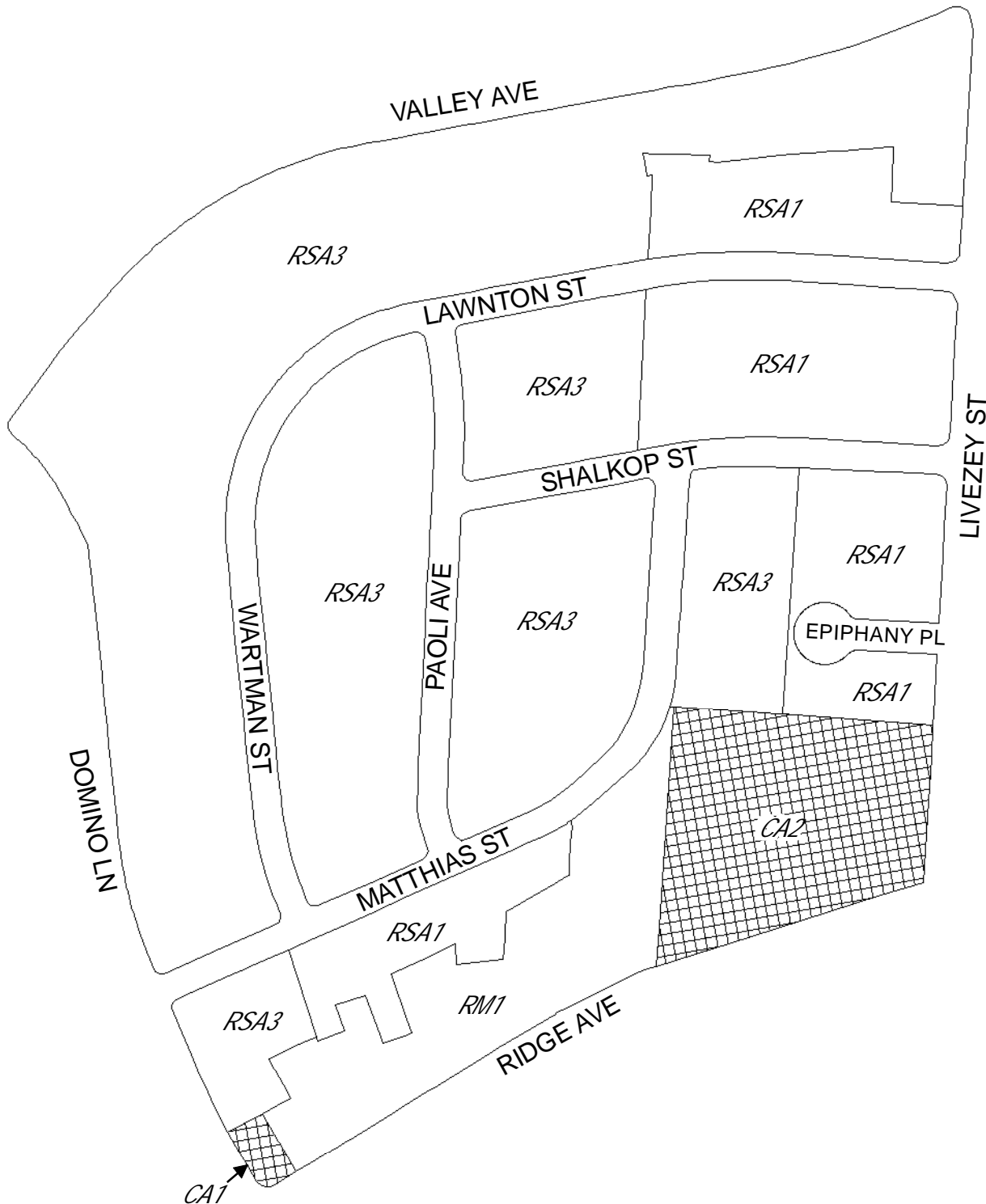

## Zoning Districts

 CA-1/CA-2 Auto-Oriented Commercial

 RSA-1/RSA-3 Single-Family Attached Residential;  
RM-1 Multi-Family Residential

# Map B1 Proposed Zoning

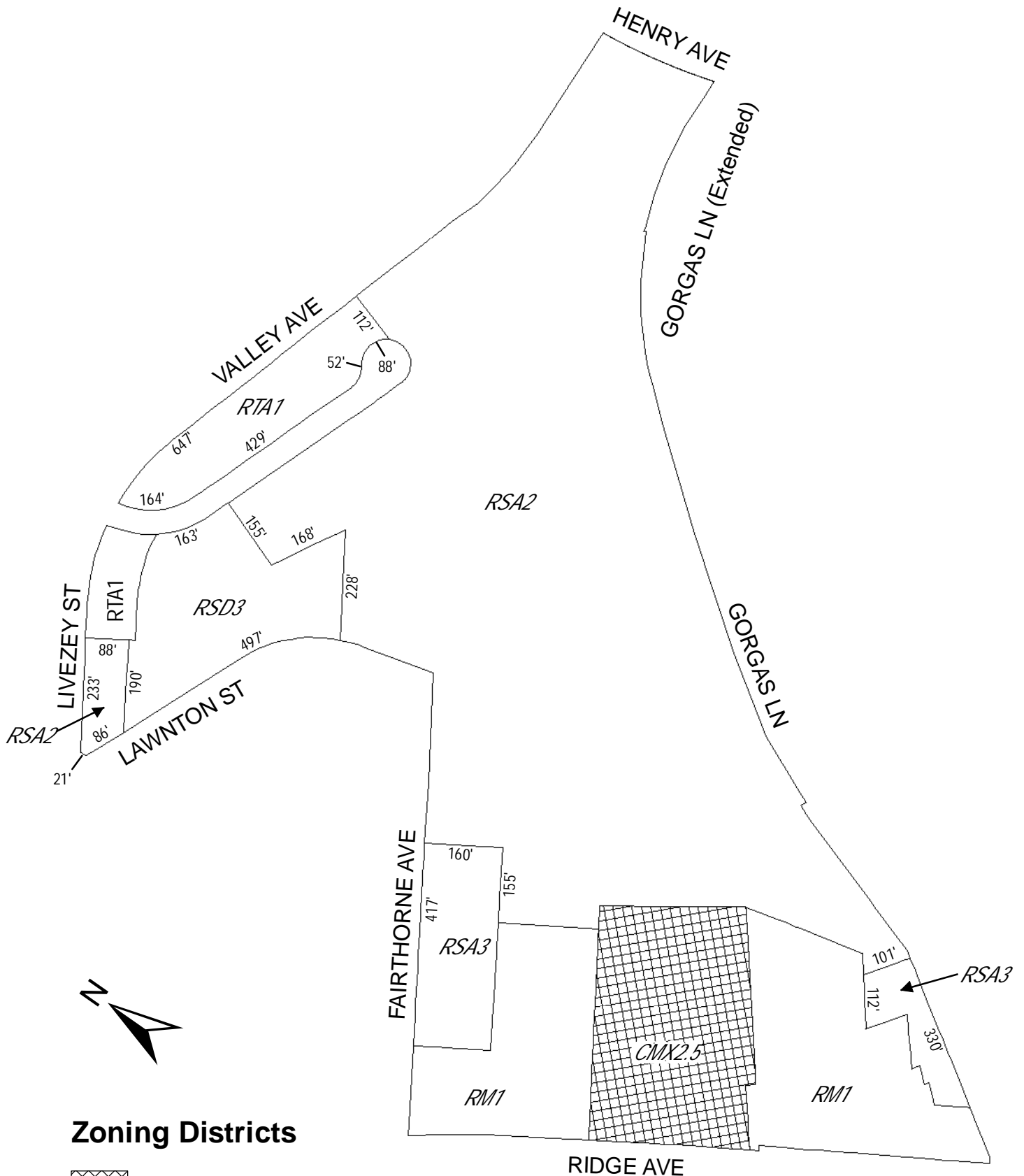

## Zoning Districts

 CMX-2.5 Commercial Mixed-Use

 RSD-3 Single-Family Detached Residential; RSA-2/RSA-3 Single-Family Attached Residential; RTA-1 Two-Family Residential; RM-1 Multi-Family Residential

# Map B2 Proposed Zoning

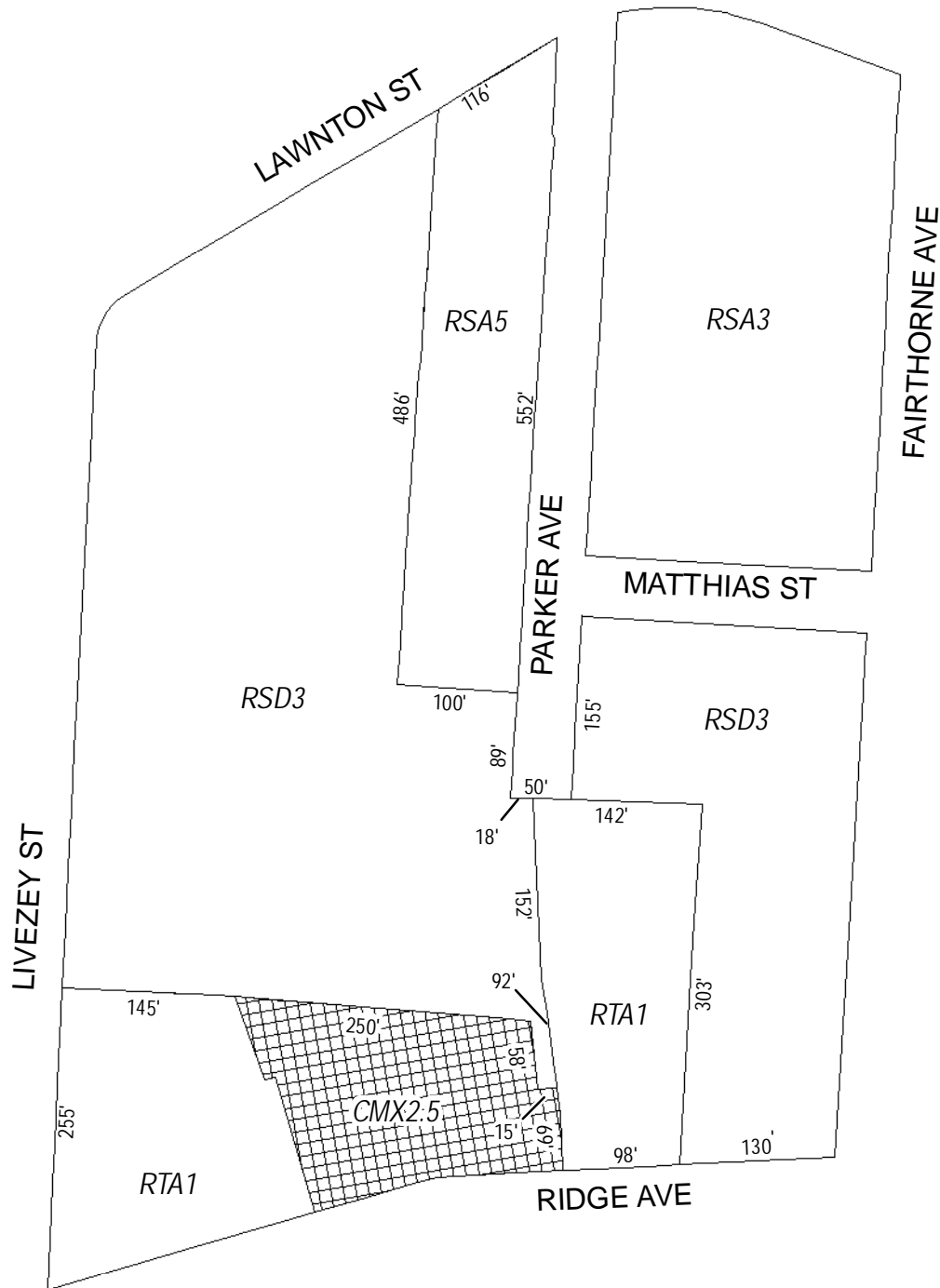

## Zoning Districts



CMX-2.5 Commercial Mixed-Use



RSD-3 Single-Family Detached Residential;  
 RSA-3/RSA-5 Single-Family Attached Residential;  
 RTA-1 Two-Family Attached Residential

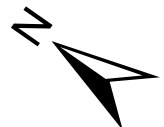

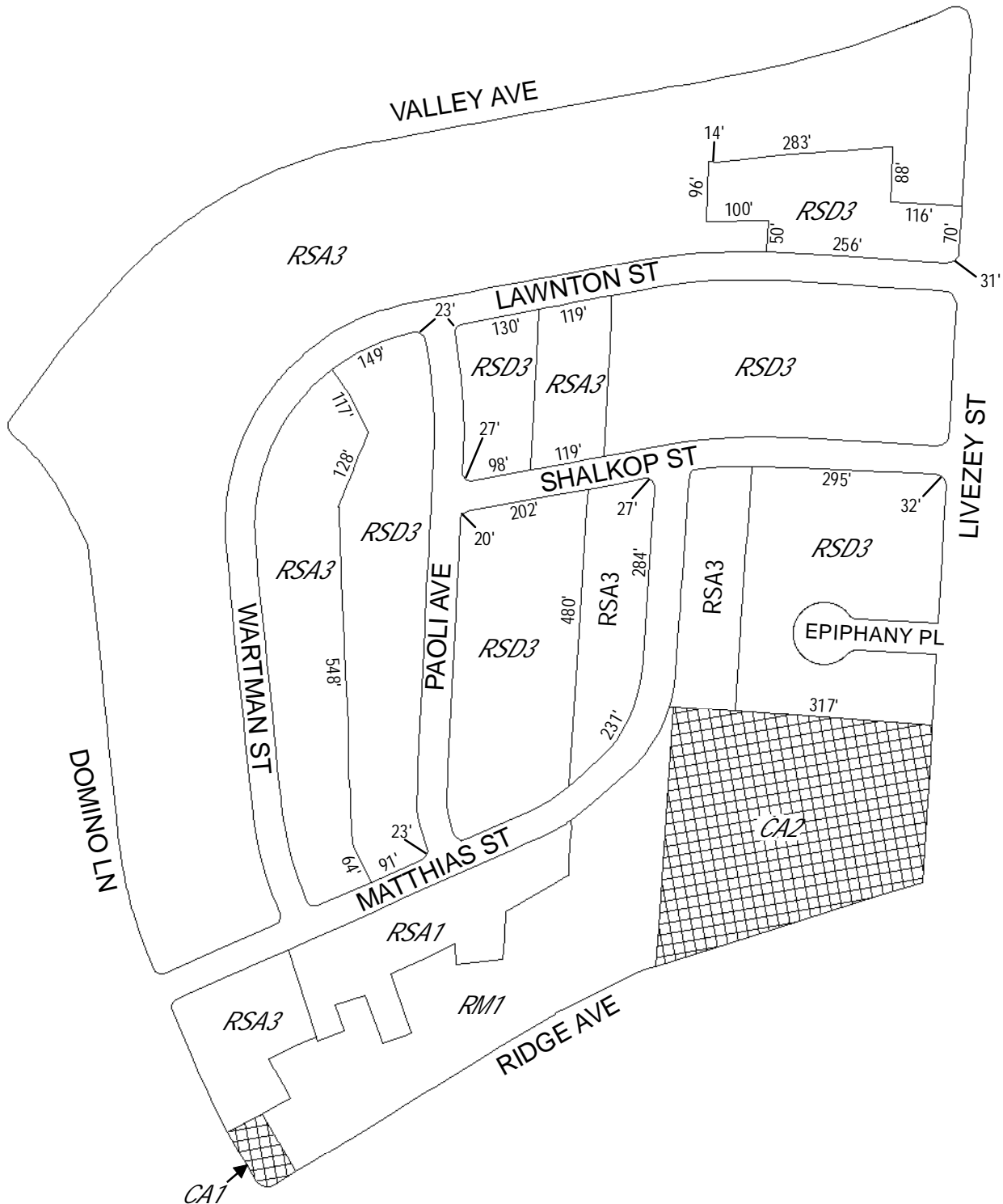

# Map B3 Proposed Zoning



## Zoning Districts

 CA-1/CA-2 Auto-Oriented Commercial

 RSD-3 Single-Family Detached Residential;  
 RSA-1/RSA-3 Single-Family Attached Residential;  
 RM-1 Multi-Family Residential



# City of Philadelphia

BILL NO. 180385 continued

Certified Copy

CERTIFICATION: This is a true and correct copy of the original Bill, Passed by the City Council on June 7, 2018. The Bill was Signed by the Mayor on June 20, 2018.

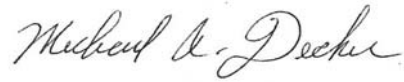
A handwritten signature in cursive script, reading "Michael A. Decker".

Michael A. Decker  
Chief Clerk of the City Council