

City of Philadelphia



(Bill No. 180503)

AN ORDINANCE

To amend the Philadelphia Zoning Maps by changing the zoning designations of certain areas of land located within an area bounded by Blue Grass Road, Grant Avenue, Ashton Road, Willits Road, Welsh Road, Dewees Street, Revere Street, Tremont Street, Leonard Street, and Welsh Road.

THE COUNCIL OF THE CITY OF PHILADELPHIA HEREBY ORDAINS:



SECTION 1. Pursuant to Section 14-106 of The Philadelphia Code, the Philadelphia Zoning Maps are hereby amended by changing the zoning designations of certain areas of land within an area bounded by Blue Grass Road, Grant Avenue, Ashton Road, Willits Road, Welsh Road, Dewees Street, Revere Street, Tremont Street, Leonard Street, and Welsh Road from the existing zoning designations indicated on Maps "A1," "A2," and "A3" set forth below to the zoning designations indicated on Maps "B1," "B2," and "B3" set forth below.

SECTION 2. This Ordinance shall become effective immediately.

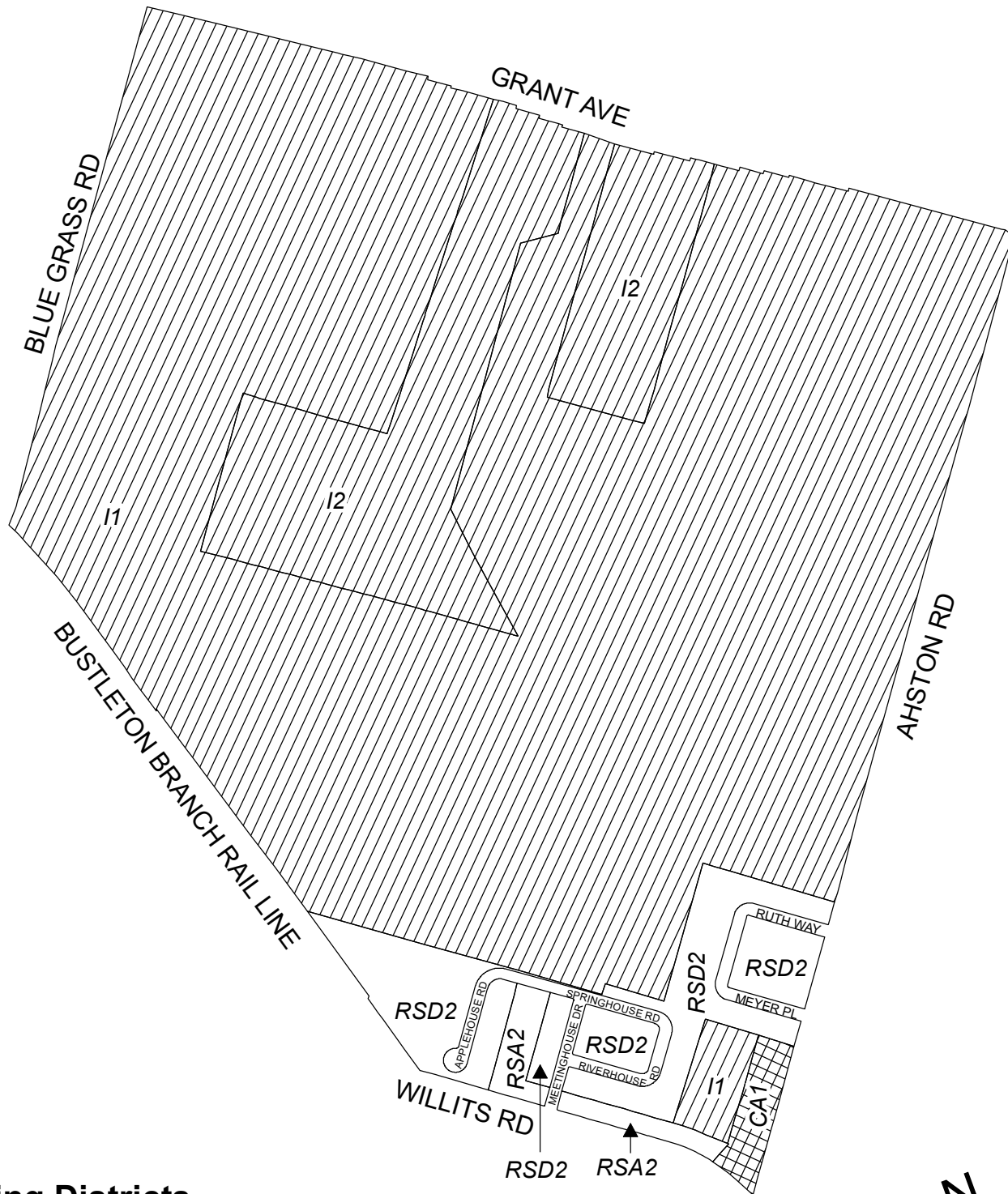
Map A1 Existing Zoning



Zoning Districts

-  CA-1 Auto-Oriented Commercial
-  I-1 Light Industrial, I-2 Medium Industrial
-  RSD-2 Residential Single-Family Detached, RSA-2 Residential Single-Family Attached

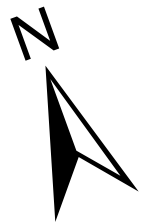

Map A2 Existing Zoning

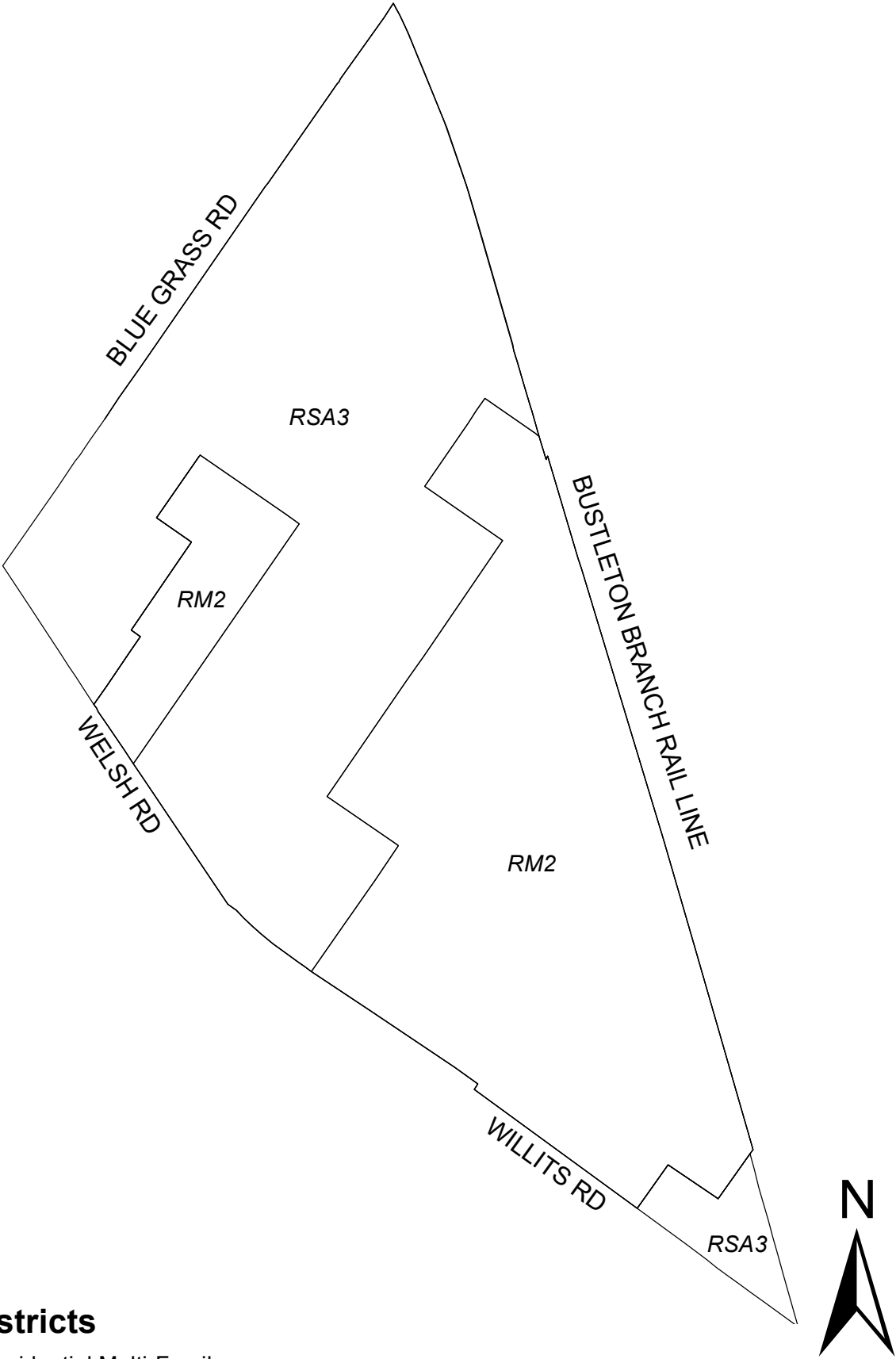

Zoning Districts

- RM-2 Residential Multi-Family,
 - RSA-3 Residential Single-Family Attached
- City of Philadelphia

Map A3 Existing Zoning

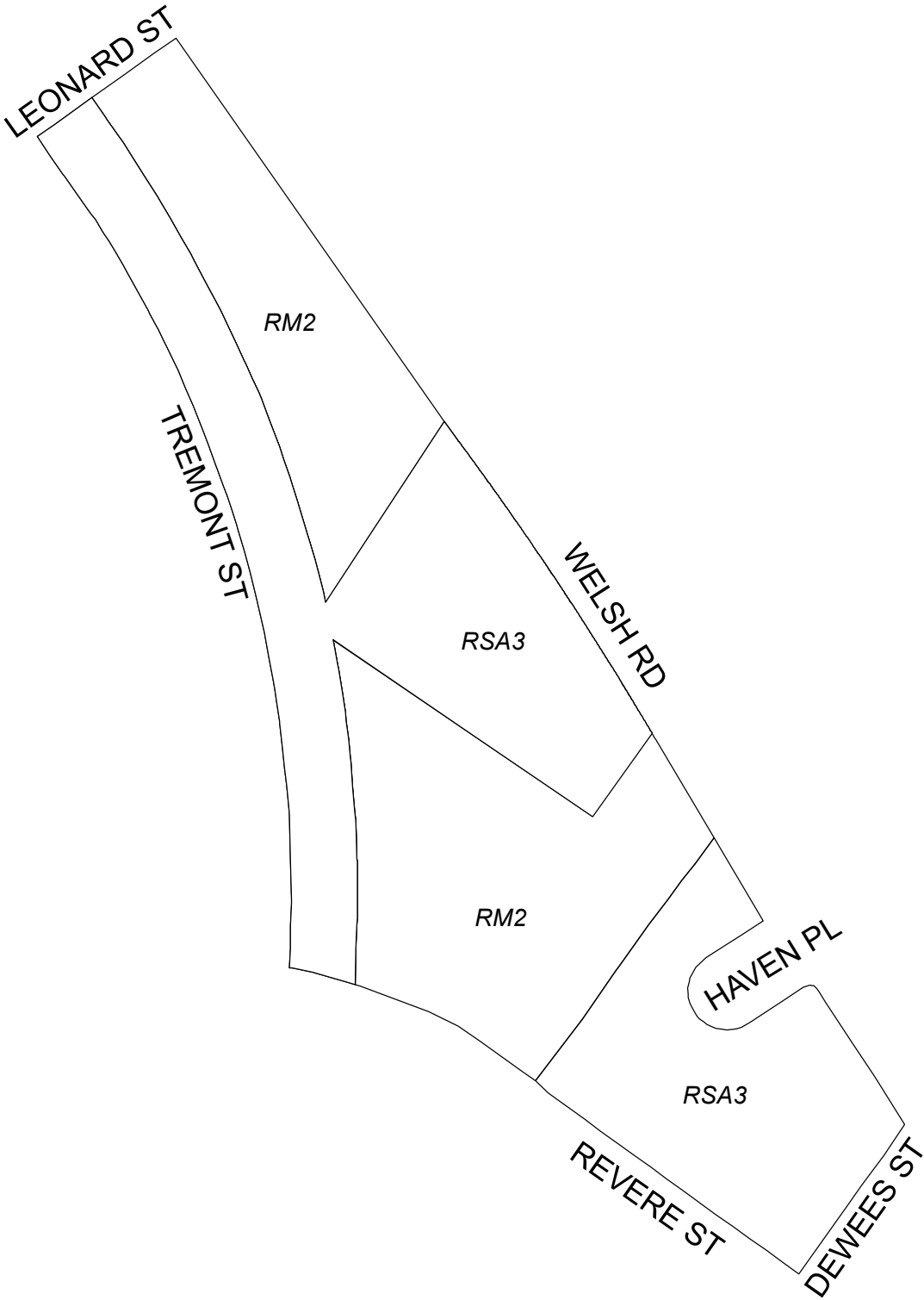

Zoning Districts



- RM-2 Residential Multi-Family,
- RSA-2/RSA-3/RSA-4 Residential Single-Family Attached

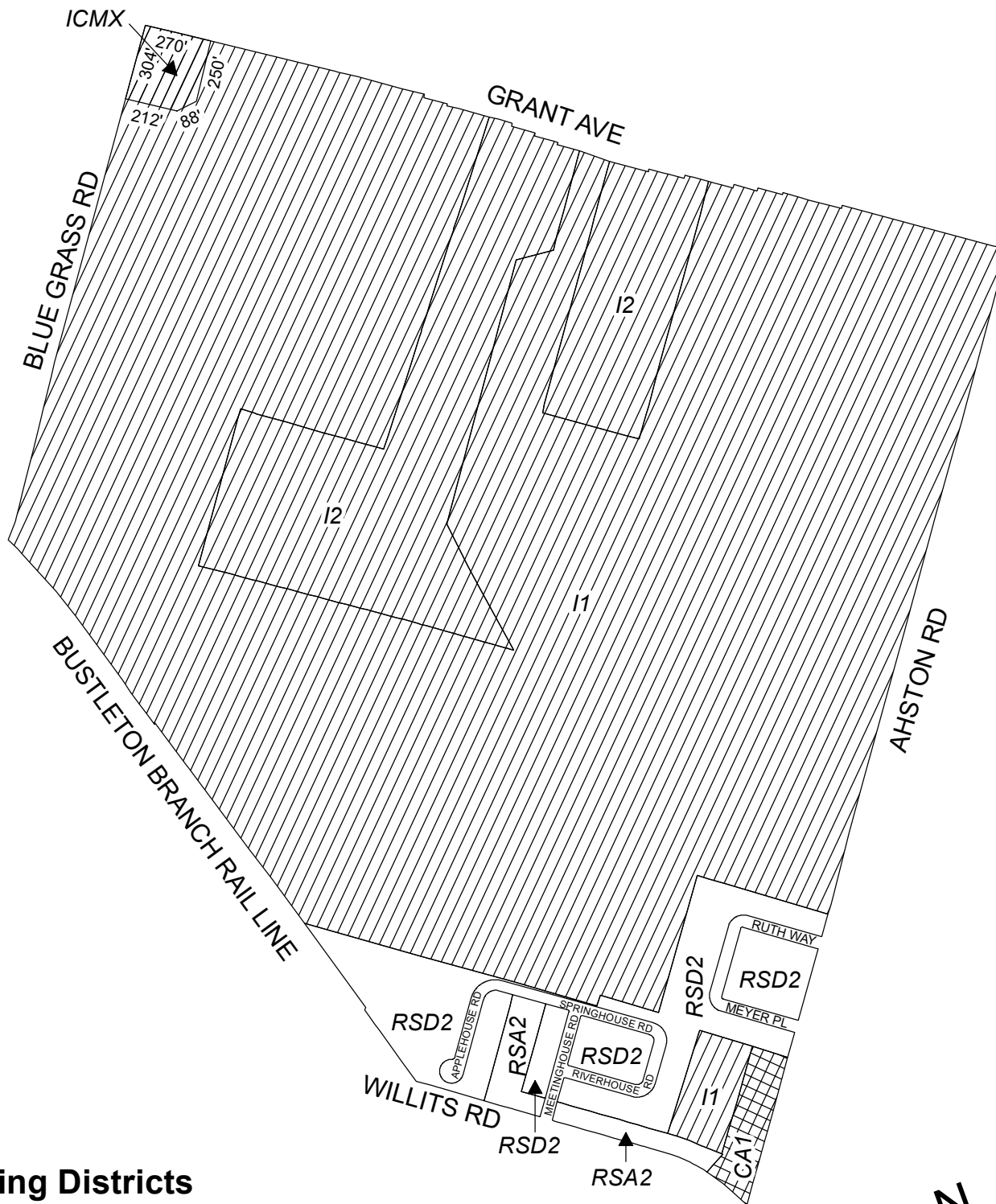

Map B1 Proposed Zoning



Zoning Districts

-  CA-1 Auto-Oriented Commercial
-  I-1 Light Industrial, I-2 Medium Industrial, ICMX Industrial Commercial Mixed-Use
-  RSD-2 Residential Single-Family Detached, RSA-2 Residential Single-Family Attached



Map B2 Proposed Zoning

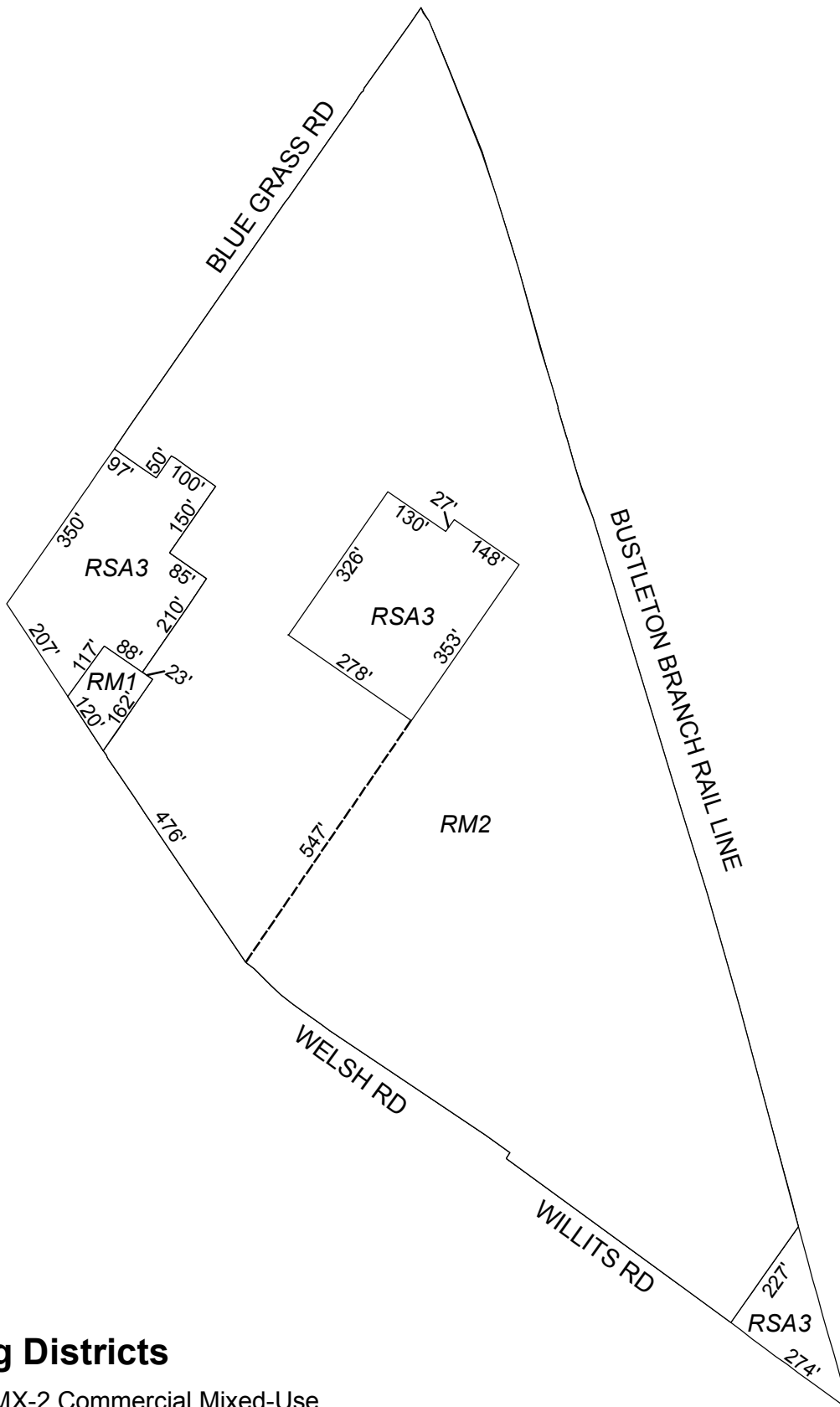

Zoning Districts



CMX-2 Commercial Mixed-Use



RM-1, RM-2 Residential Multi-Family,
RSA-3 Residential Single-Family Attached

Map B3 Proposed Zoning

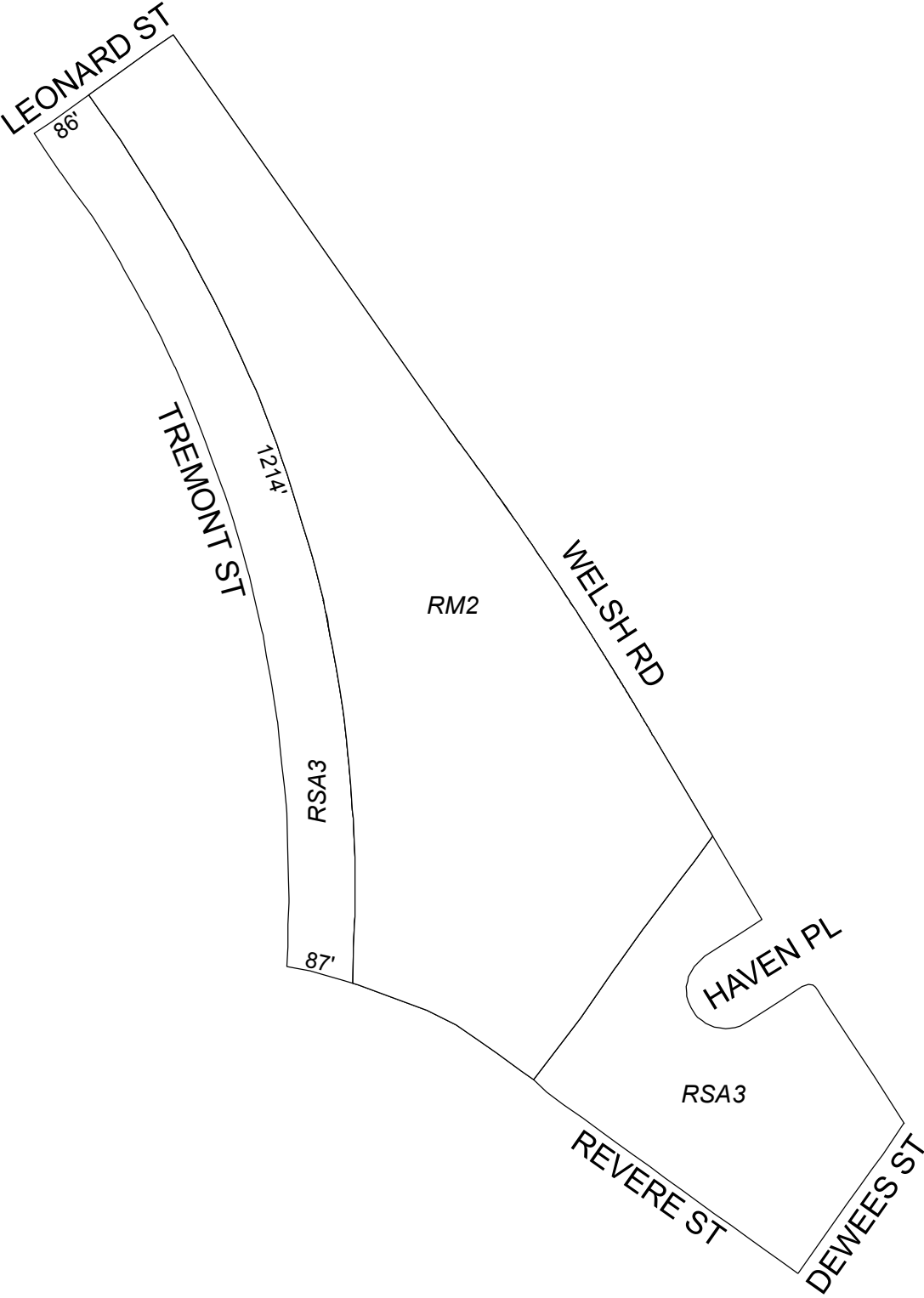

Zoning Districts

- RM-2 Residential Multi-Family,
- RSA-3 Residential Single-Family Attached

City of Philadelphia

BILL NO. 180503 continued

Certified Copy

CERTIFICATION: This is a true and correct copy of the original Bill, Passed by the City Council on June 21, 2018. The Bill was Signed by the Mayor on July 18, 2018.

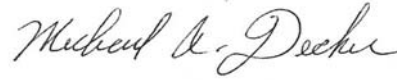
A handwritten signature in black ink, reading "Michael A. Decker". The signature is written in a cursive style with a large, stylized "M" and "D".

Michael A. Decker
Chief Clerk of the City Council