

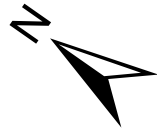

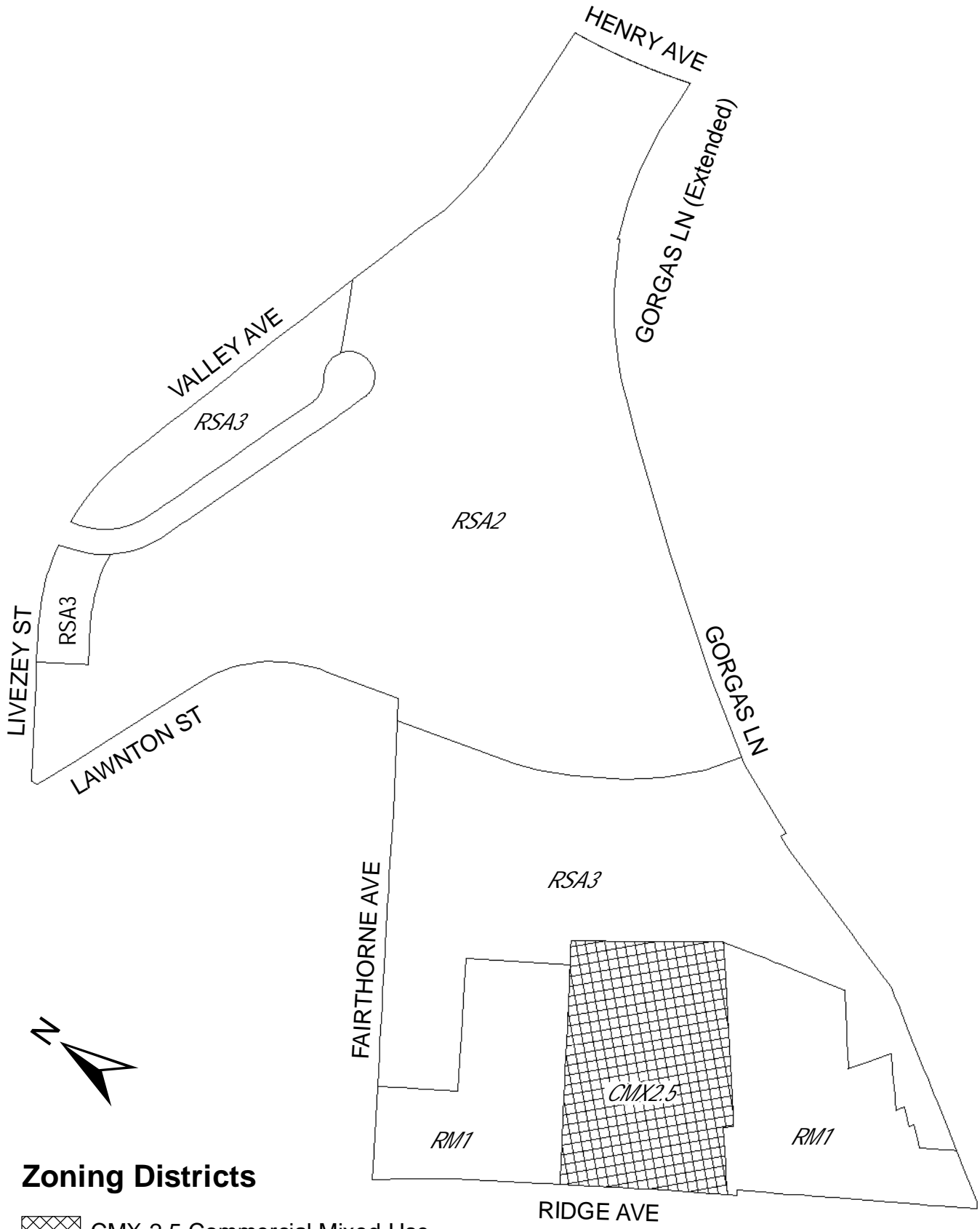

Map A1 Existing Zoning



Zoning Districts

-  CMX-2.5 Commercial Mixed-Use
-  RSA-2/RSA-3 Single-Family Attached Residential;
-  RM-1 Multi-Family Residential

Map A2 Existing Zoning

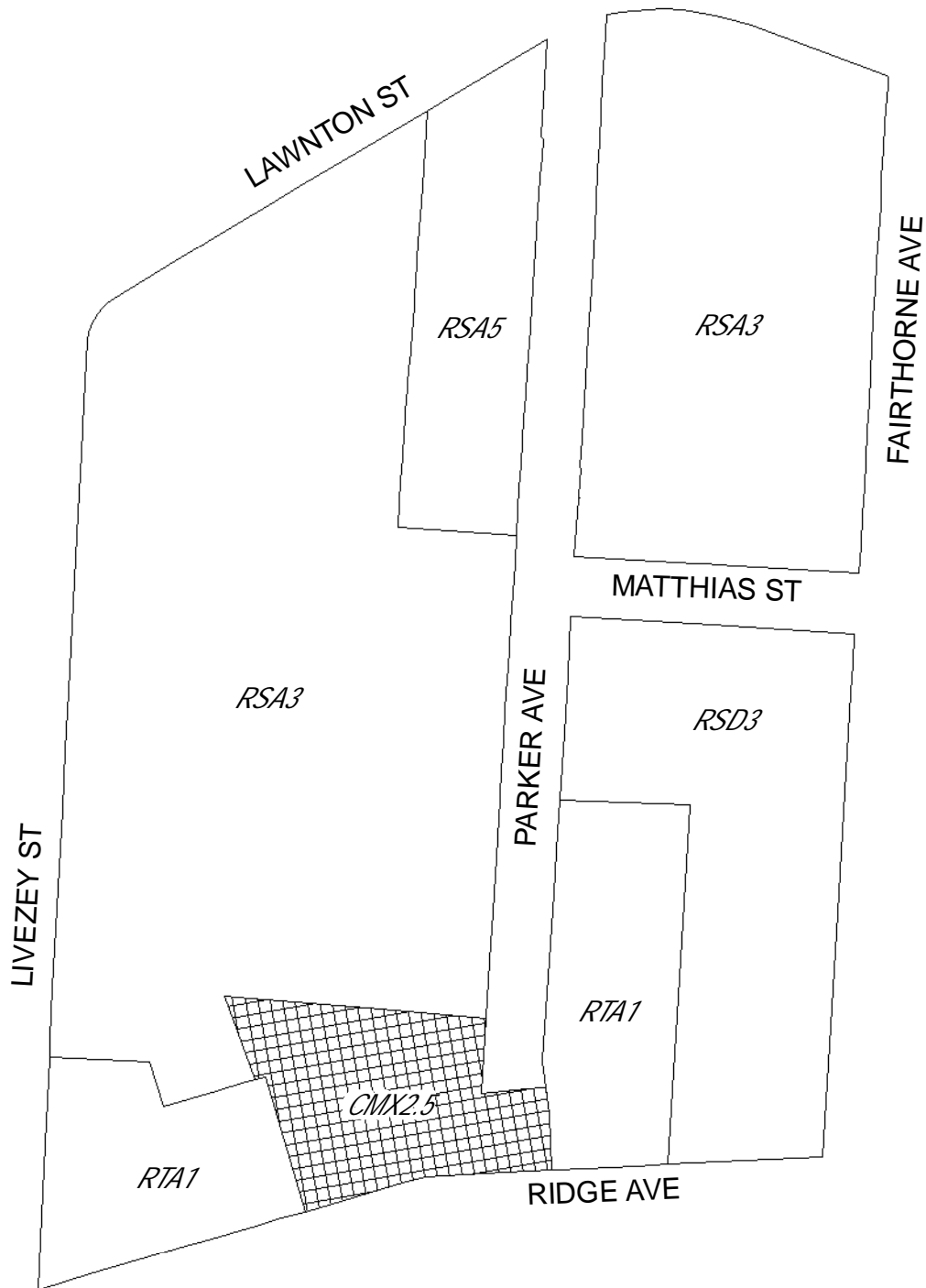

Zoning Districts



CMX-2.5 Commercial Mixed-Use



RSD-3 Single-Family Detached Residential;
RSA-3/RSA-5 Single-Family Attached Residential;
RTA-1 Two-Family Attached Residential

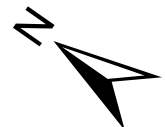

Map A3 Existing Zoning

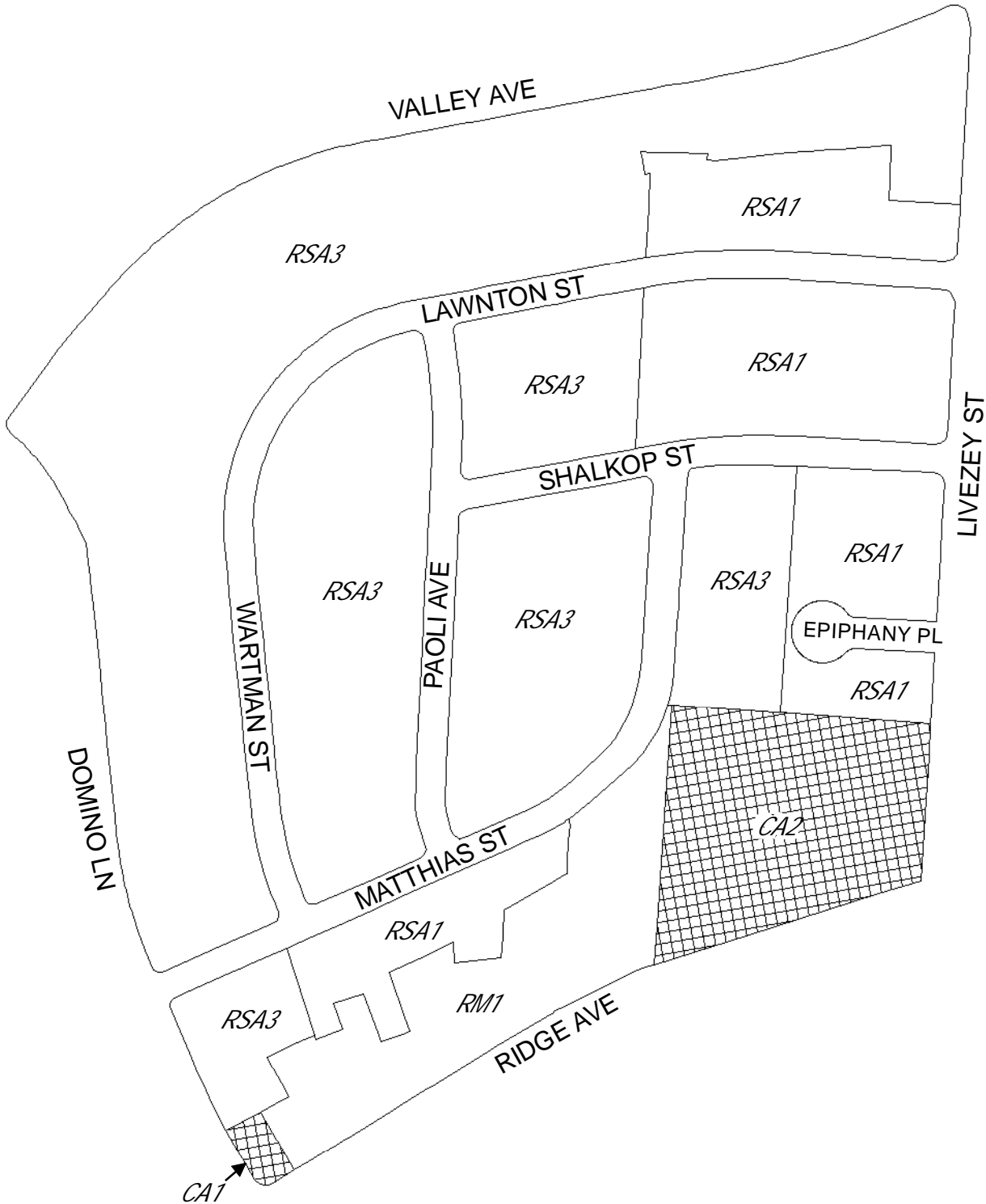

Zoning Districts



CA-1/CA-2 Auto-Oriented Commercial



RSA-1/RSA-3 Single-Family Attached Residential;
RM-1 Multi-Family Residential



Map B1 Proposed Zoning

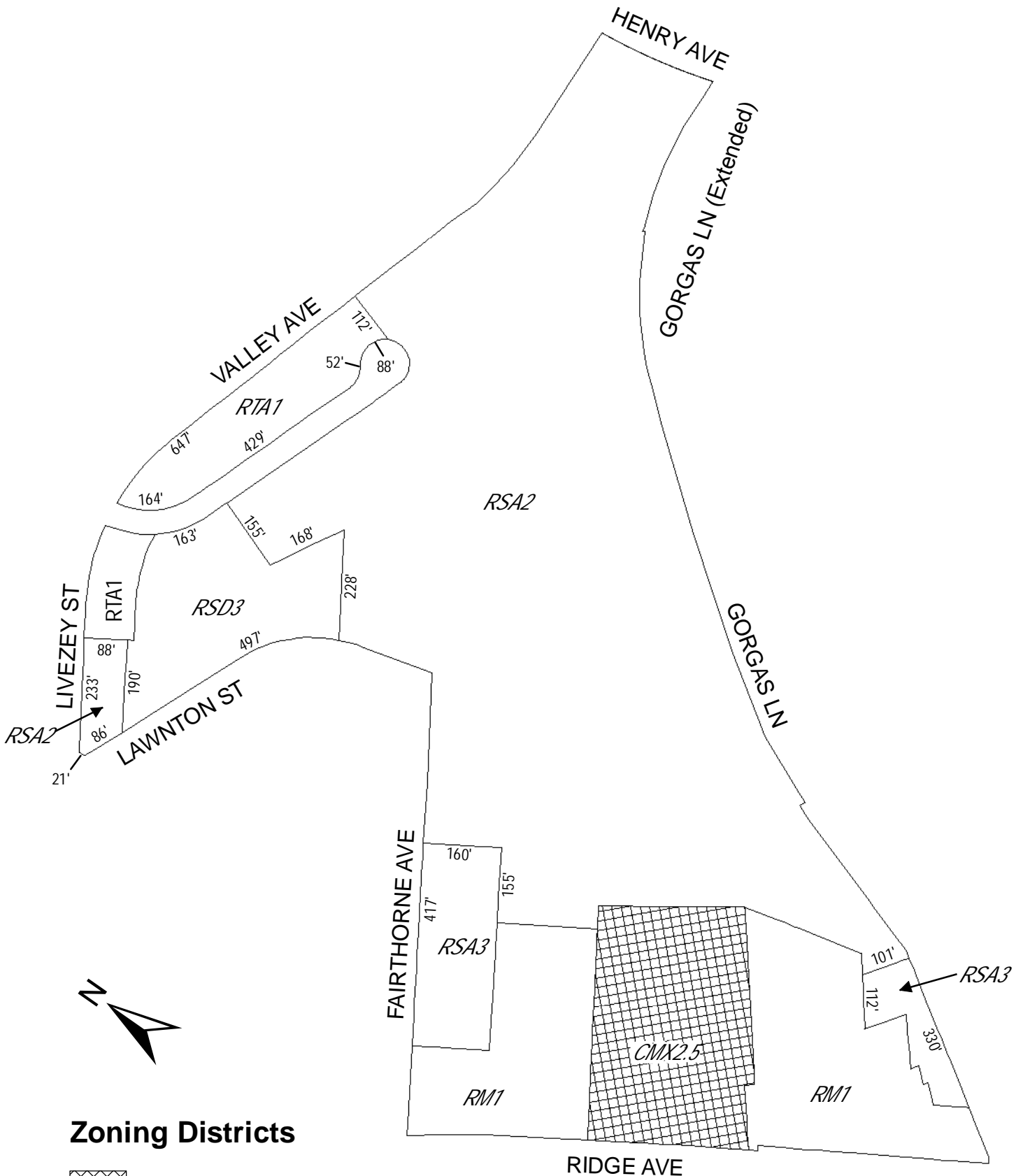

Zoning Districts



CMX-2.5 Commercial Mixed-Use



RSD-3 Single-Family Detached Residential; RSA-2/RSA-3 Single-Family Attached Residential; RTA-1 Two-Family Residential; RM-1 Multi-Family Residential

Map B2 Proposed Zoning

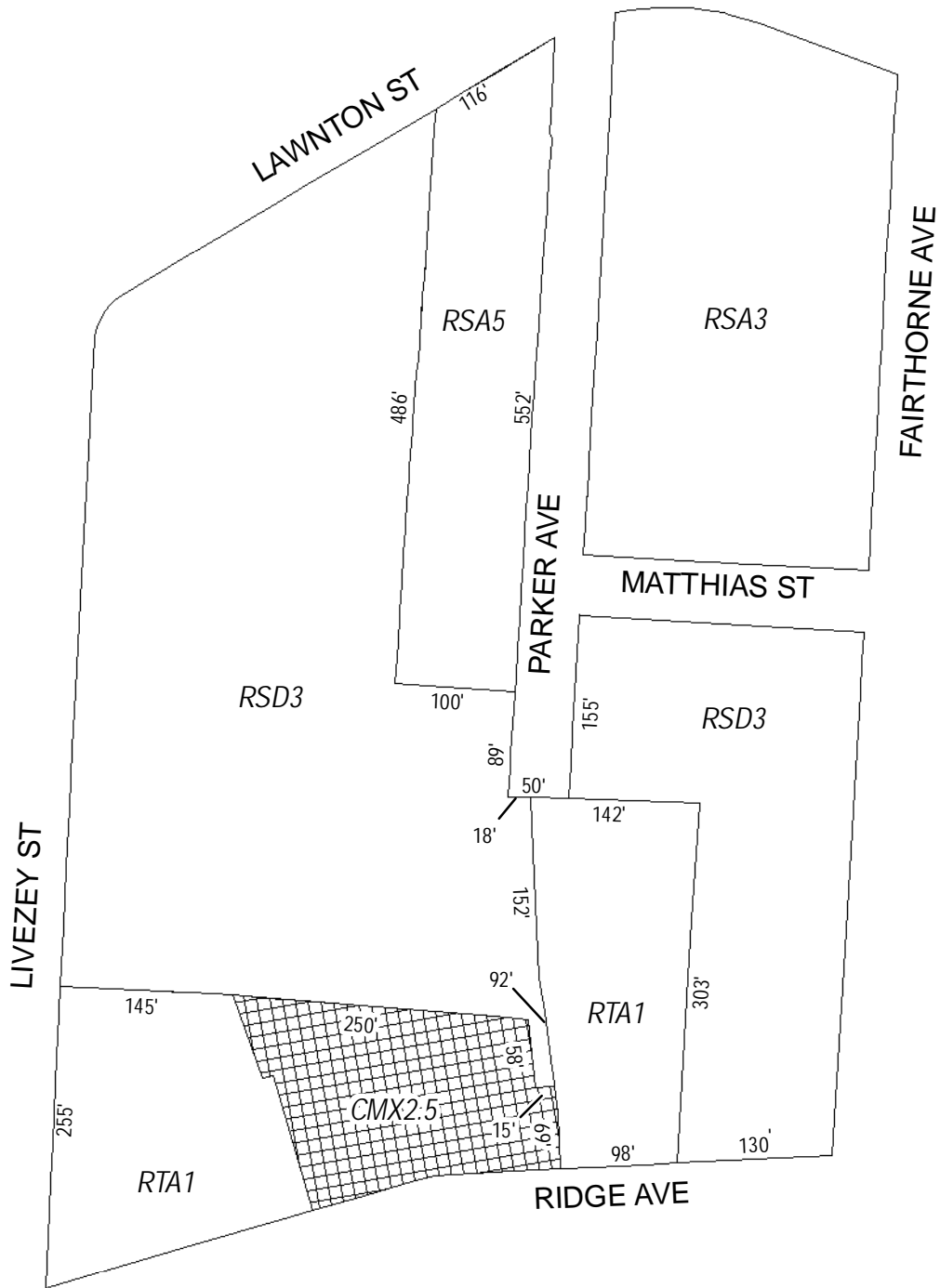

Zoning Districts



CMX-2.5 Commercial Mixed-Use



RSD-3 Single-Family Detached Residential;
RSA-3/RSA-5 Single-Family Attached Residential;
RTA-1 Two-Family Attached Residential

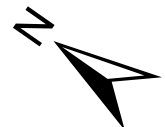

Map B3 Proposed Zoning

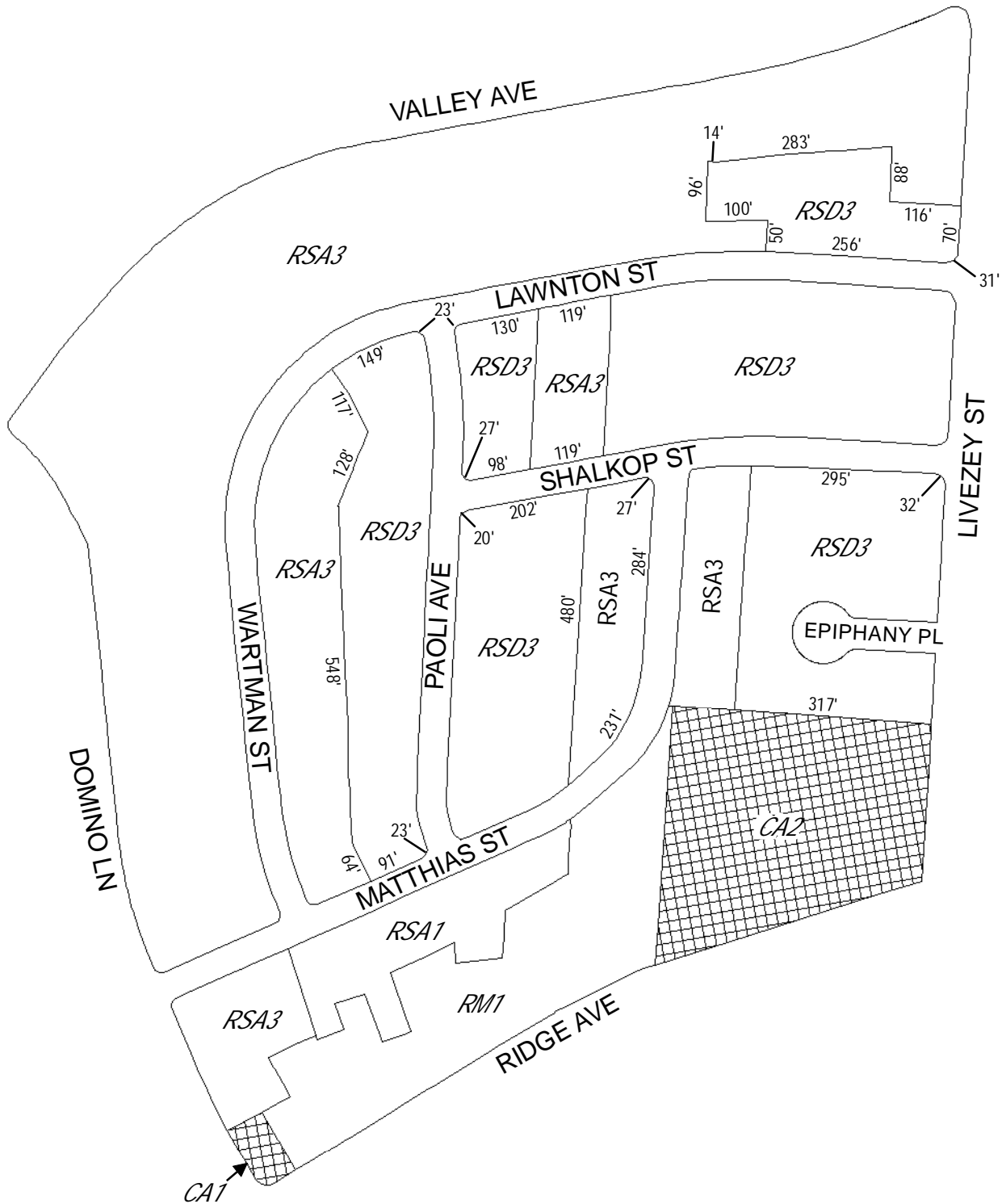

Zoning Districts

 CA-1/CA-2 Auto-Oriented Commercial

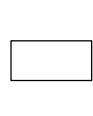
 RSD-3 Single-Family Detached Residential;
 RSA-1/RSA-3 Single-Family Attached Residential;
 RM-1 Multi-Family Residential

