

## Legislation Details (With Text)

<b>File #:</b>	210744	<b>Version:</b>	0	<b>Name:</b>	
<b>Type:</b>	Bill	<b>Status:</b>		ENACTED	
<b>File created:</b>	9/23/2021	<b>In control:</b>		Committee on Rules	
<b>On agenda:</b>		<b>Final action:</b>		12/9/2021	
<b>Title:</b>	To amend the Philadelphia Zoning Maps by changing the zoning designations of certain areas of land located within an area bounded by Germania Street, Arendell Avenue, Delaware Avenue, and Linden Avenue.				
<b>Sponsors:</b>	Councilmember Henon				
<b>Indexes:</b>	Zoning Maps				
<b>Code sections:</b>					
<b>Attachments:</b>	1. Bill No. 21074400.pdf, 2. CertifiedCopy21074400				

Date	Ver.	Action By	Action	Result	Tally
1/20/2022	0	MAYOR	NO ACTION TAKEN		
12/9/2021	0	CITY COUNCIL	READ AND PASSED	Pass	17:0
12/2/2021	0	CITY COUNCIL			
12/2/2021	0	CITY COUNCIL			
12/2/2021	0	CITY COUNCIL			
11/22/2021	0	Committee on Rules	HEARING NOTICES SENT		
11/22/2021	0	Committee on Rules	HEARING HELD		
11/22/2021	0	Committee on Rules	REPORTED FAVORABLY, RULE SUSPENSION REQUESTED		
9/23/2021	0	CITY COUNCIL	Introduced and Referred		

To amend the Philadelphia Zoning Maps by changing the zoning designations of certain areas of land located within an area bounded by Germania Street, Arendell Avenue, Delaware Avenue, and Linden Avenue.

*THE COUNCIL OF THE CITY OF PHILADELPHIA HEREBY ORDAINS:*

SECTION 1. Pursuant to Section 14-106 of The Philadelphia Code, The Philadelphia Zoning Maps are hereby amended by changing the zoning designations of certain areas of land within an area bounded by Germania Street, Arendell Avenue, Delaware Avenue, and Linden Avenue from the existing zoning designations indicated on Map "A," set forth below, to the zoning designations indicated on Map "B," set forth below.

SECTION 2. This Ordinance shall take effect immediately.

# MapA Existing Zoning

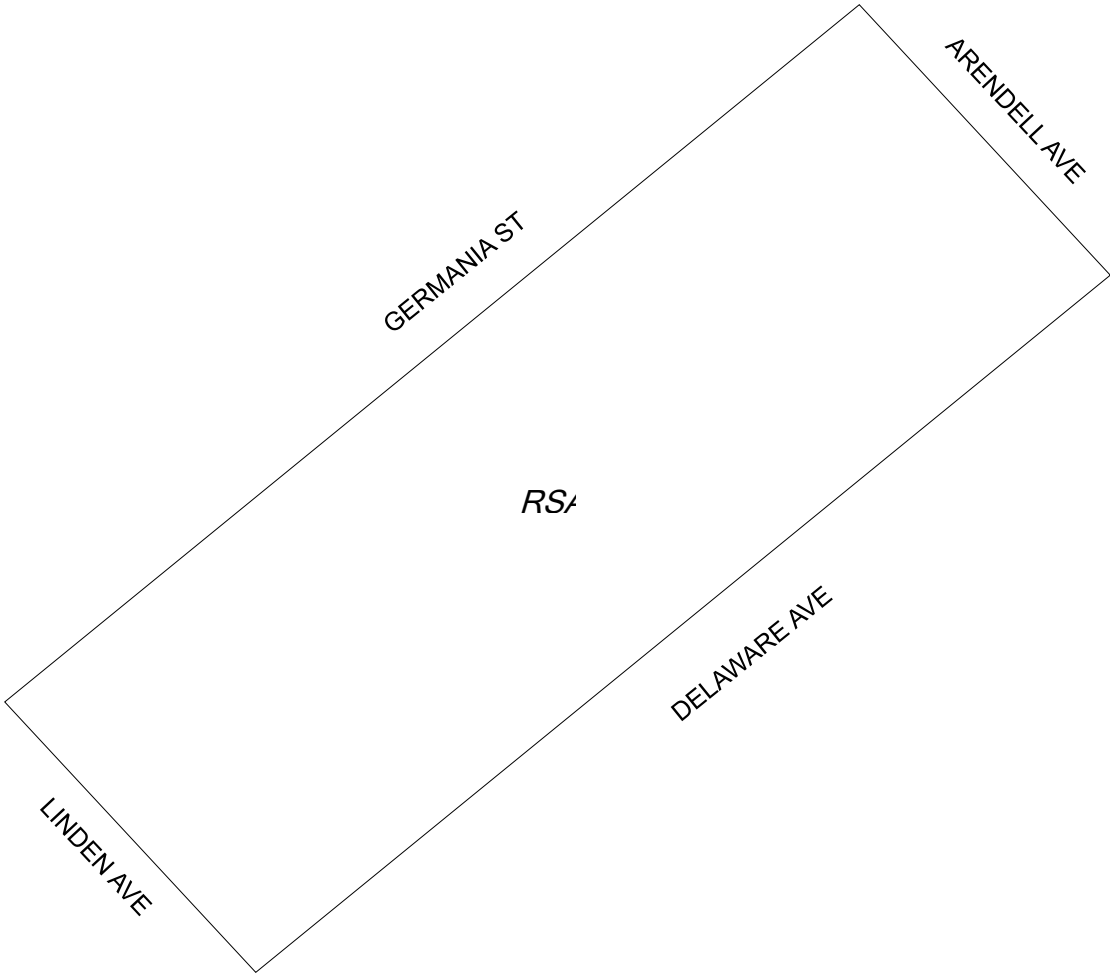

## Zoning Districts

☐ RSA2, Residential Single-Family Attached





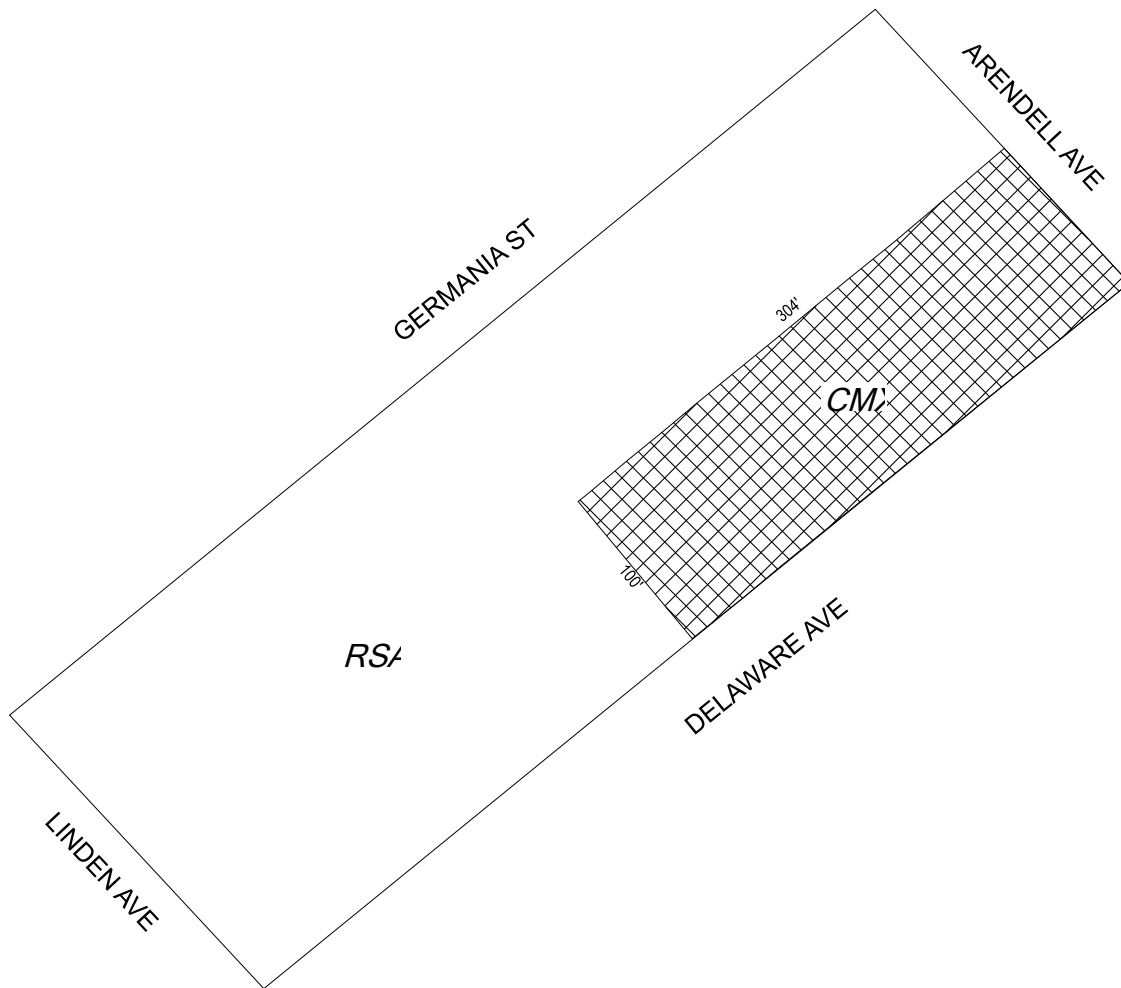

# Map B Proposed Zoning



## Zoning Districts

-  CMX2, Commercial Mixed Use
-  RSA2, Residential Single-Family Attached

