

Legislation Text

File #: 210744, **Version:** 0

To amend the Philadelphia Zoning Maps by changing the zoning designations of certain areas of land located within an area bounded by Germania Street, Arendell Avenue, Delaware Avenue, and Linden Avenue.

THE COUNCIL OF THE CITY OF PHILADELPHIA HEREBY ORDAINS:

SECTION 1. Pursuant to Section 14-106 of The Philadelphia Code, The Philadelphia Zoning Maps are hereby amended by changing the zoning designations of certain areas of land within an area bounded by Germania Street, Arendell Avenue, Delaware Avenue, and Linden Avenue from the existing zoning designations indicated on Map "A," set forth below, to the zoning designations indicated on Map "B," set forth below.

SECTION 2. This Ordinance shall take effect immediately.

MapA Existing Zoning

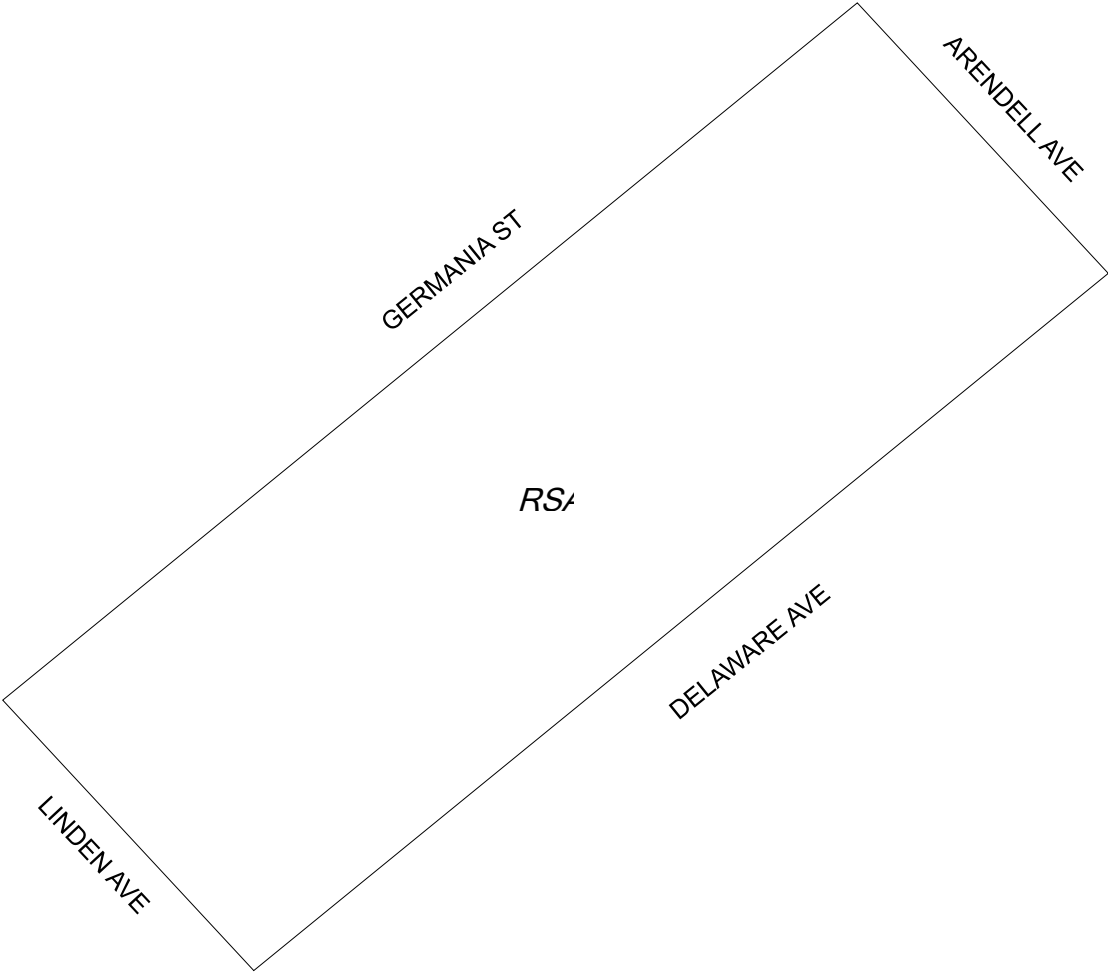

Zoning Districts



☐ RSA2, Residential Single-Family Attached

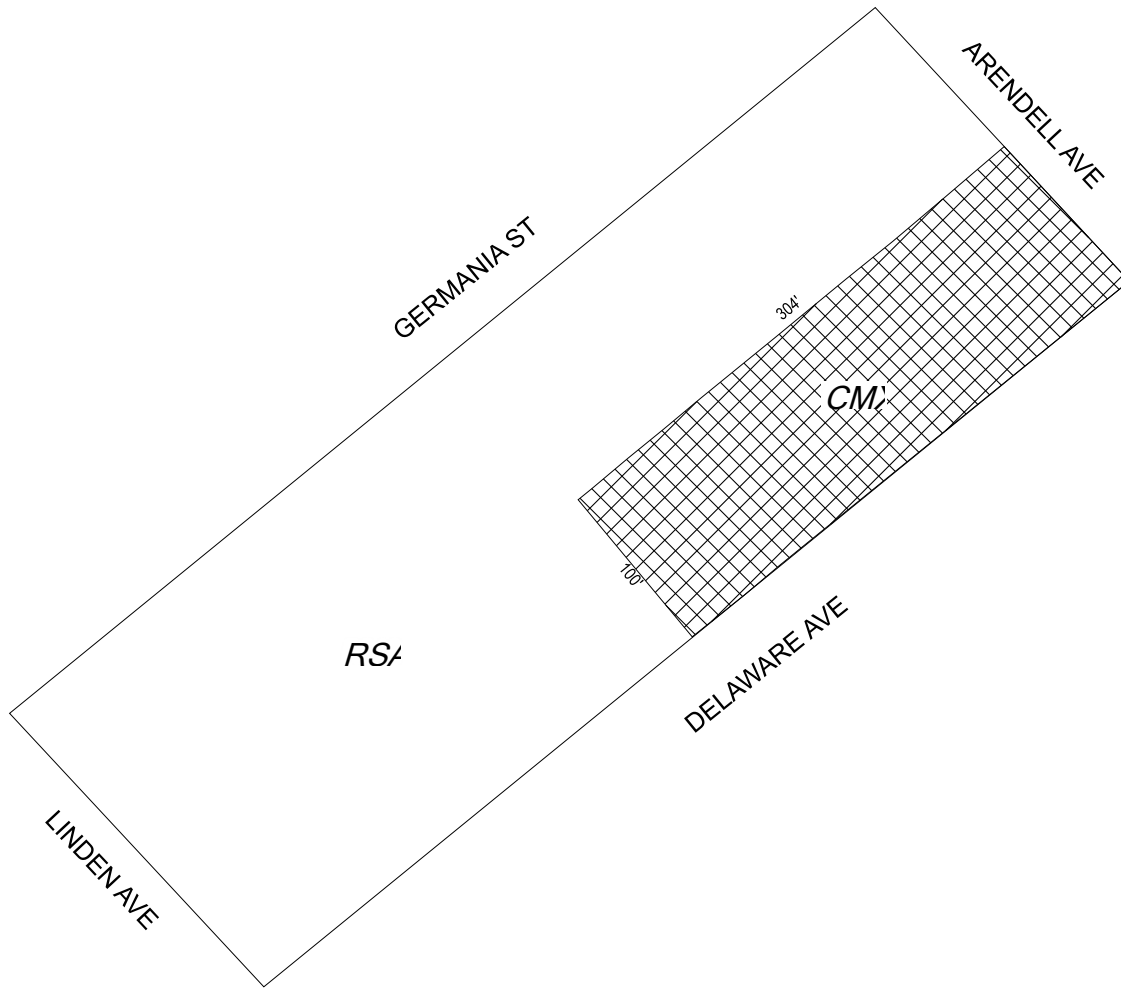

Map B Proposed Zoning



Zoning Districts

-  CMX2, Commercial Mixed Use
-  RSA2, Residential Single-Family Attached

