



City of Philadelphia

City Council
Chief Clerk's Office
402 City Hall
Philadelphia, PA 19107

BILL NO. 250985

Introduced November 13, 2025

Councilmember Jones

**Referred to the
Committee on Rules**

AN ORDINANCE

Amending the Philadelphia Zoning Maps by changing the zoning designations of certain areas of land located within the area bounded by Bryn Mawr Avenue, Wynnefield Avenue, Nevada Street and the SEPTA Railroad Right of Way.

THE COUNCIL OF THE CITY OF PHILADELPHIA HEREBY ORDAINS:

SECTION 1. Pursuant to Section 14-106 of The Philadelphia Code, the Philadelphia Zoning Maps are hereby amended by changing the zoning designations of certain areas of land within an area bounded by Bryn Mawr Avenue, Wynnefield Avenue, Nevada Street and the SEPTA Railroad Right of Way from the existing zoning designations indicated on Map "A," set forth below, to the zoning designations indicated on Map "B," set forth below.

SECTION 2. This ordinance shall become effective immediately.

City of Philadelphia

BILL NO. 250985 continued

Map A Existing Zoning

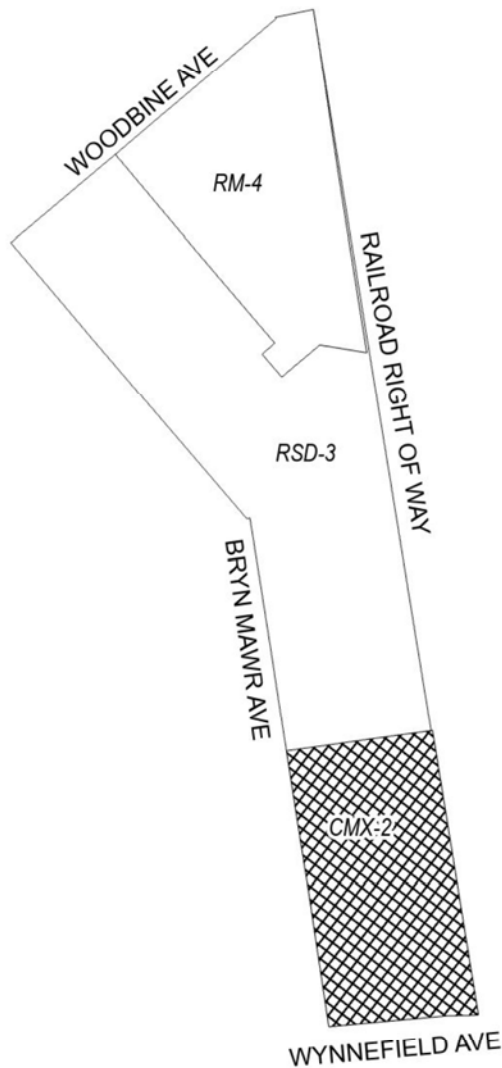

Zoning Districts

-  CMX-2, Commercial Mixed-Use
-  RM-4, Residential Multi-Family; RSD-3, Residential Single-Family Detached



City of Philadelphia

BILL NO. 250985 continued

Map B Proposed Zoning

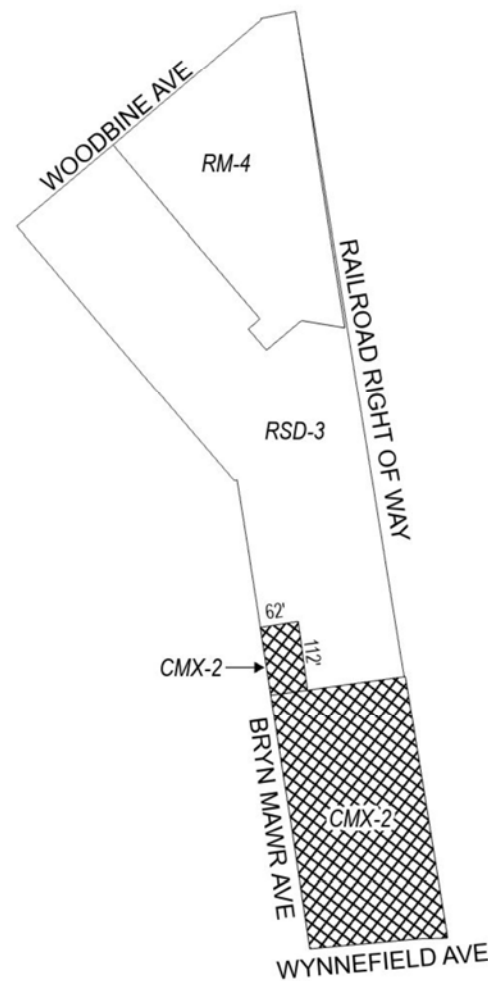

Zoning Districts

-  CMX-2, Commercial Mixed-Use
-  RM-4, Residential Multi-Family; RSD-3, Residential Single-Family Detached

